

# SITE OVERVIEW

1:15000

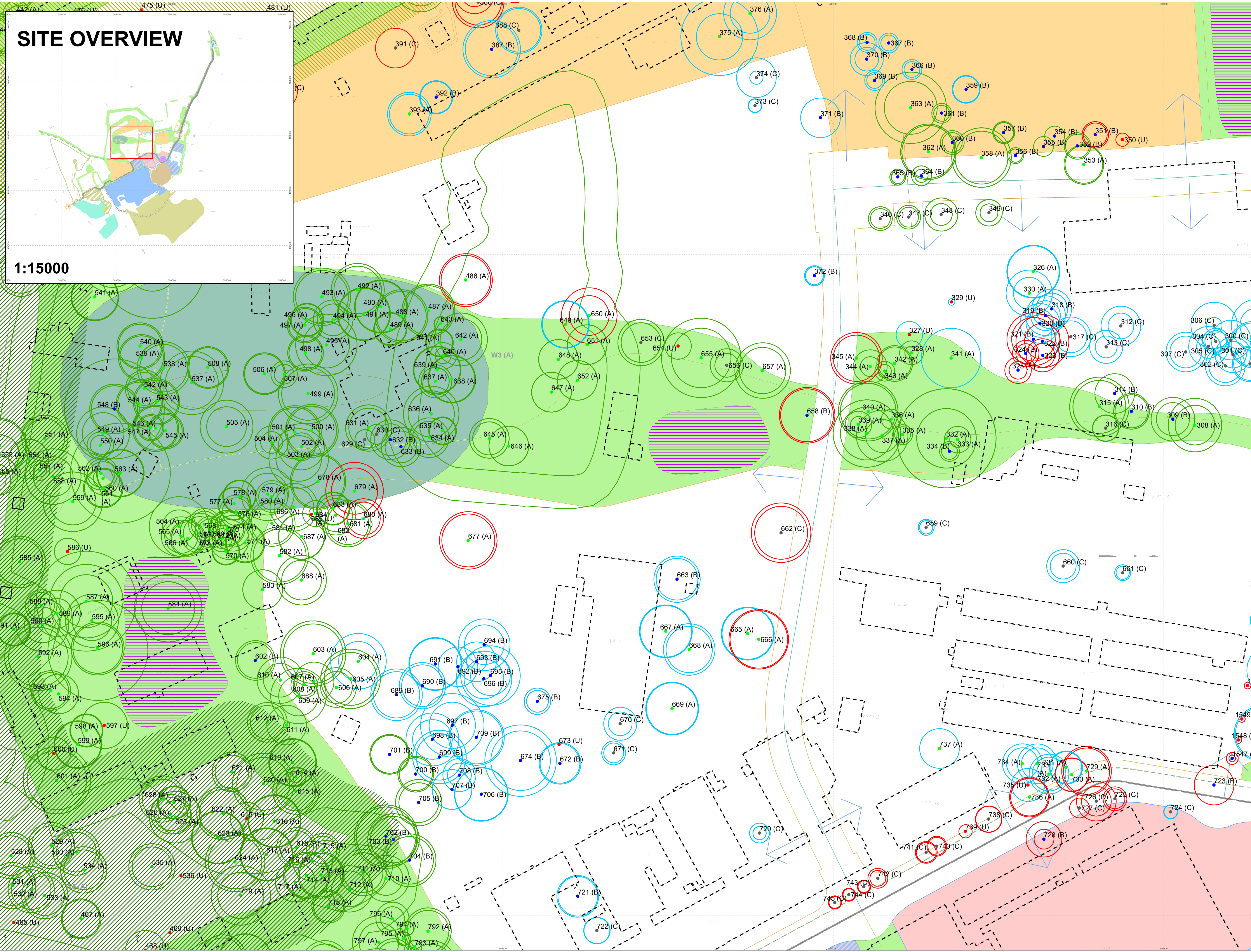
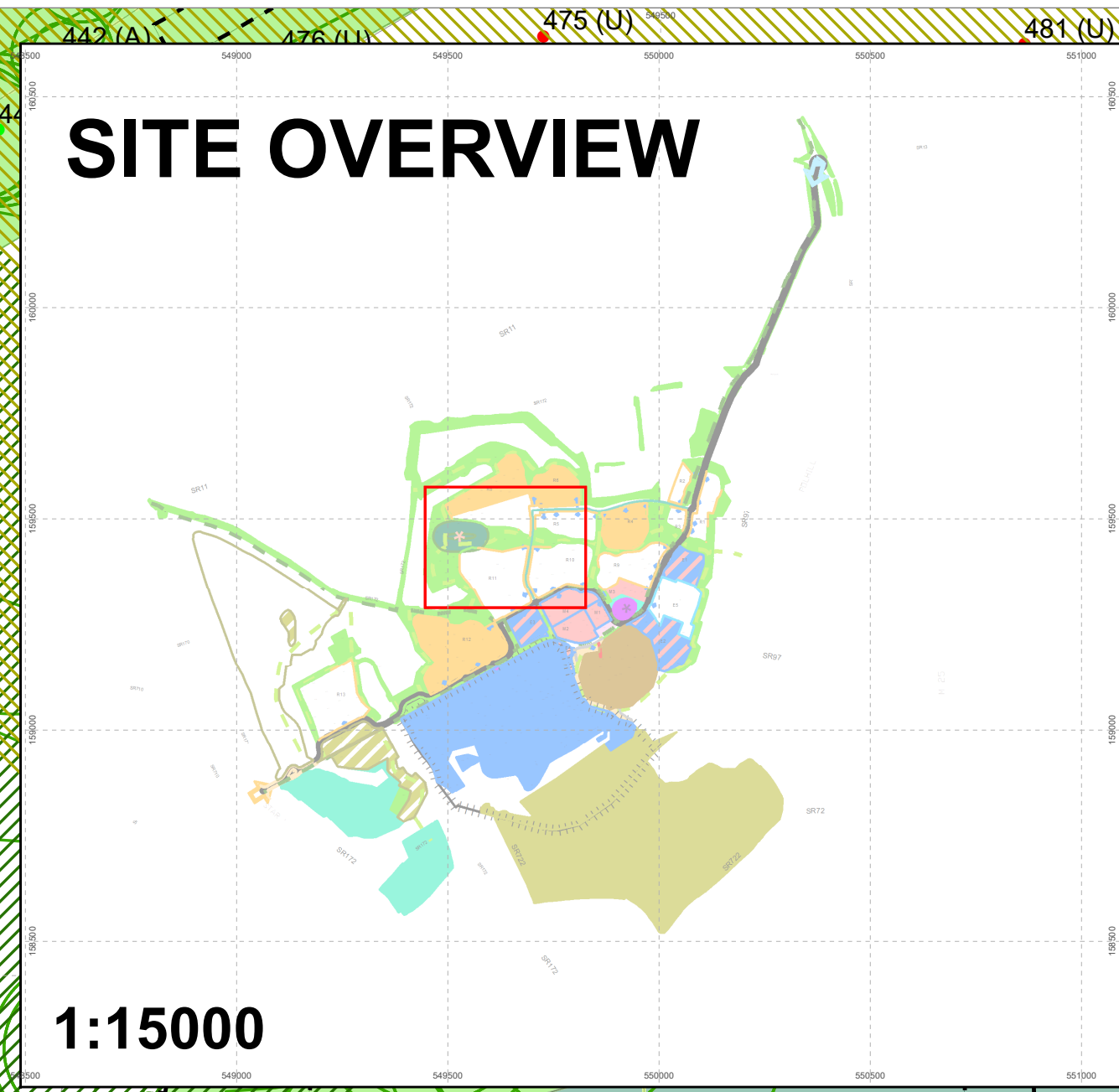

- ### Legend
- Tree retention plan**
    - Category A tree
    - Category B tree
    - Category C tree
    - Category U tree
  - Existing tree to be removed
  - Existing woodland to be partially removed
  - Existing tree/group/woodland to be retained
  - Existing tree/group/woodland to be retained
  - Ancient and Semi-Natural woodland
  - Ancient Replanted Woodland
  - Indicative location for SuDS ponds
  - Building to be demolished
  - Building to be retained
  - Proposed plan**
    - p-cycle routes
    - A-G712-G-SiteSurfSoft
    - Ecologically Sensitive Grassland
    - Ecologically enhanced grassland or mitigation zone
    - Fence
    - Indicative access
    - Informal green
    - LEAP
    - Main access points
    - NEAP
    - Public car park-tbc
    - QQ access
    - Road Corridor
    - Scheduled Ancient Monument
    - Secondary Access
    - Secondary Road
    - T-D1221-G-RoadPrim
    - T-D1229-G-SharSurf
    - T-D1234-G-Footpath
    - T-D32-G-EmpI
    - T-D712-G-PrimSchl
    - T-D8-G-Resi
    - Village green
    - WALLS
    - draft bus turnaround 2020-04-03 - p-trees
    - draft bus turnaround 2020-04-03 - stantec - path
    - draft bus turnaround 2020-04-03 - stantec - road
    - other employment
    - A-G712-G-SiteSurfSoft
    - Ecologically Sensitive Grassland
    - Ecologically enhanced grassland or mitigation zone
    - Informal green
    - LEAP
    - NEAP
    - Public car park-tbc
    - Scheduled Ancient Monument
    - T-D-G-MixdUse
    - T-D1221-G-RoadPrim
    - T-D1229-G-SharSurf
    - T-D32-G-EmpI
    - T-D8-G-Resi
    - Village green
    - other employment

The original of this drawing was produced in colour - a monochrome copy should not be relied upon.



# SITE OVERVIEW

1:15000

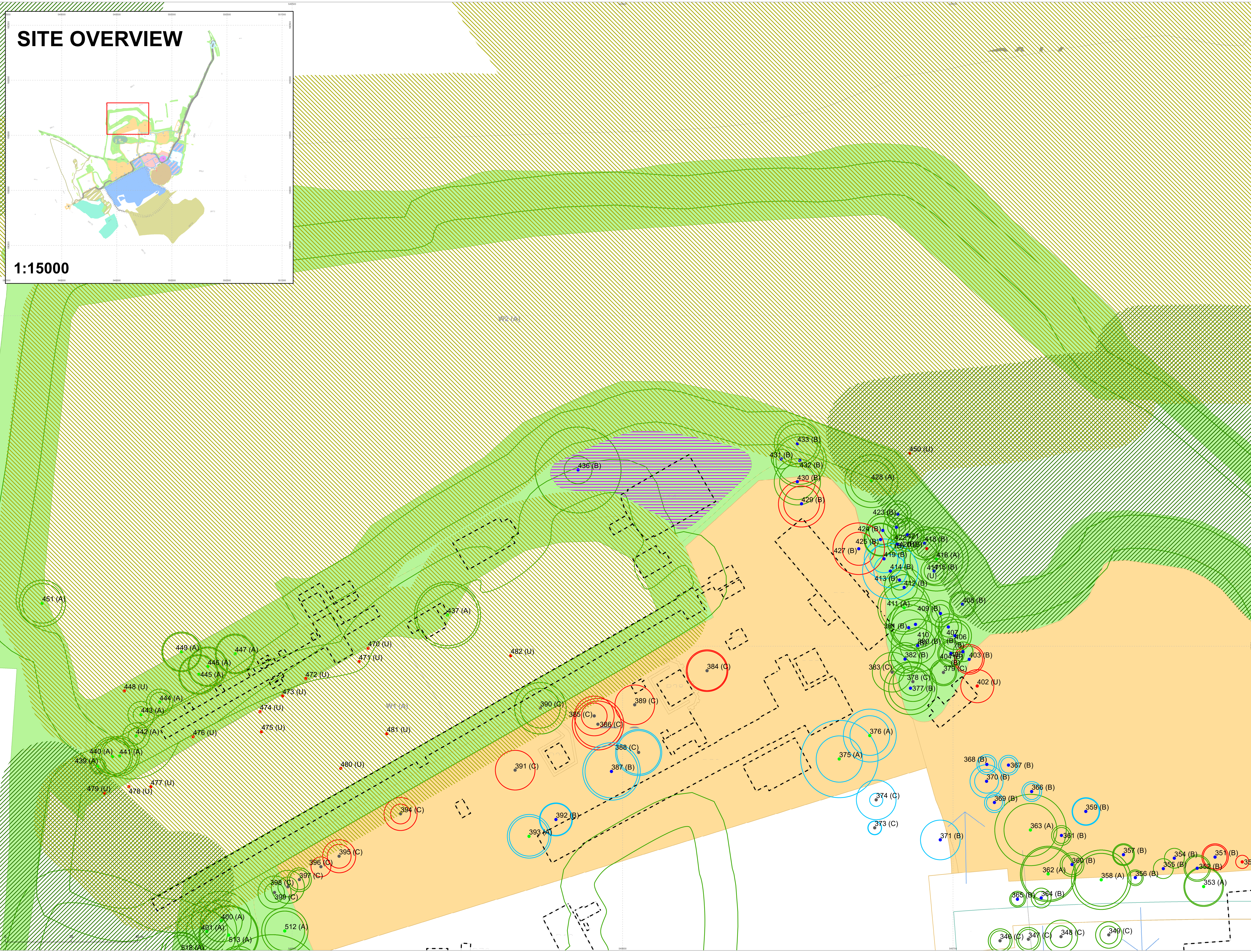
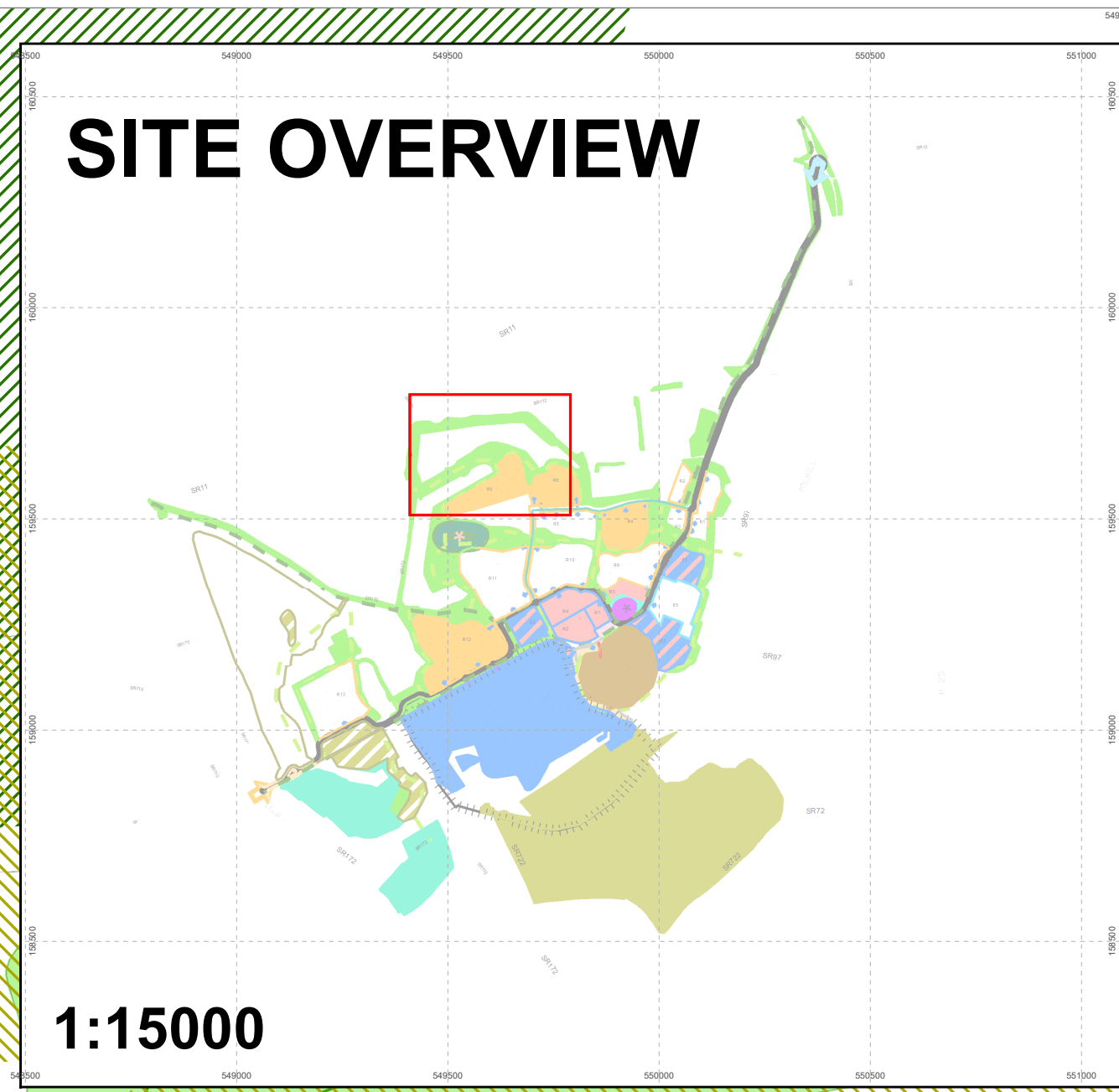

- Legend**
- Tree retention plan**
    - Category A tree
    - Category B tree
    - Category C tree
    - Category U tree
    - Existing tree to be removed
    - Existing woodland to be partially removed
    - Existing tree which could be retained subject to detailed design
    - Existing tree/group/woodland to be retained
    - Ancient and Semi-Natural woodland
    - Ancient Replanted Woodland
    - Indicative location for SuDS ponds
    - Building to be demolished
    - Building to be retained
  - Proposed plan**
    - p-cycle routes
    - A-G712-G-SiteSurfSoft
    - Ecologically Sensitive Grassland
    - Ecologically enhanced grassland or mitigation zone
    - Fence
    - Indicative access
    - Informal green
    - LEAP
    - Main access points
    - NEAP
    - Public car park-tbc
    - QQ access
    - Road Corridor
    - Scheduled Ancient Monument
    - Secondary Access
    - Secondary Road
    - T-D-G-MixdUse
    - T-D1221-G-RoadPrim
    - T-D1229-G-SharSurf
    - T-D1234-G-Footpath
    - T-D32-G-Empl
    - T-D712-G-PrimSchl
    - T-D8-G-Resi
    - Village green
    - WALLS
    - draft bus turnaround 2020-04-03 - p-trees
    - draft bus turnaround 2020-04-03 - stantec - path
    - draft bus turnaround 2020-04-03 - stantec - road
    - other employment
    - A-G712-G-SiteSurfSoft
    - Ecologically Sensitive Grassland
    - Ecologically enhanced grassland or mitigation zone
    - Informal green
    - LEAP
    - NEAP
    - Public car park-tbc
    - Scheduled Ancient Monument
    - T-D-G-MixdUse
    - T-D1221-G-RoadPrim
    - T-D1229-G-SharSurf
    - T-D32-G-Empl
    - T-D8-G-Resi
    - Village green
    - other employment

The original of this drawing was produced in colour - a monochrome copy should not be relied upon.

Project	Fort Halstead
Client	Tree Retention Plan for Outline Planning Page 9 of 12 - Overlay
Drawn by	CBRE
Checked by	Rev A
Date	June 2020
Scale	1:500
Author	DS
Drawn	GT

**MIDDLEMARCH ENVIRONMENTAL**

Triumph House, Birmingham Road, Alsley, Coventry CV5 9AZ  
 Phone: 02476 21610  
 E: admin@middlemarch-environmental.com