

Note
 This drawing is protected by copyright and must not be copied or reproduced without the written consent of Graham Simpkin Planning. All dimensions and sizes to be checked on site. North points are indicative. ©

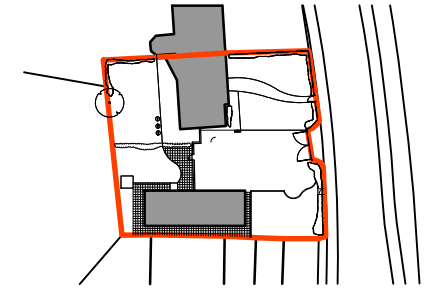

Site Location
 1:1250

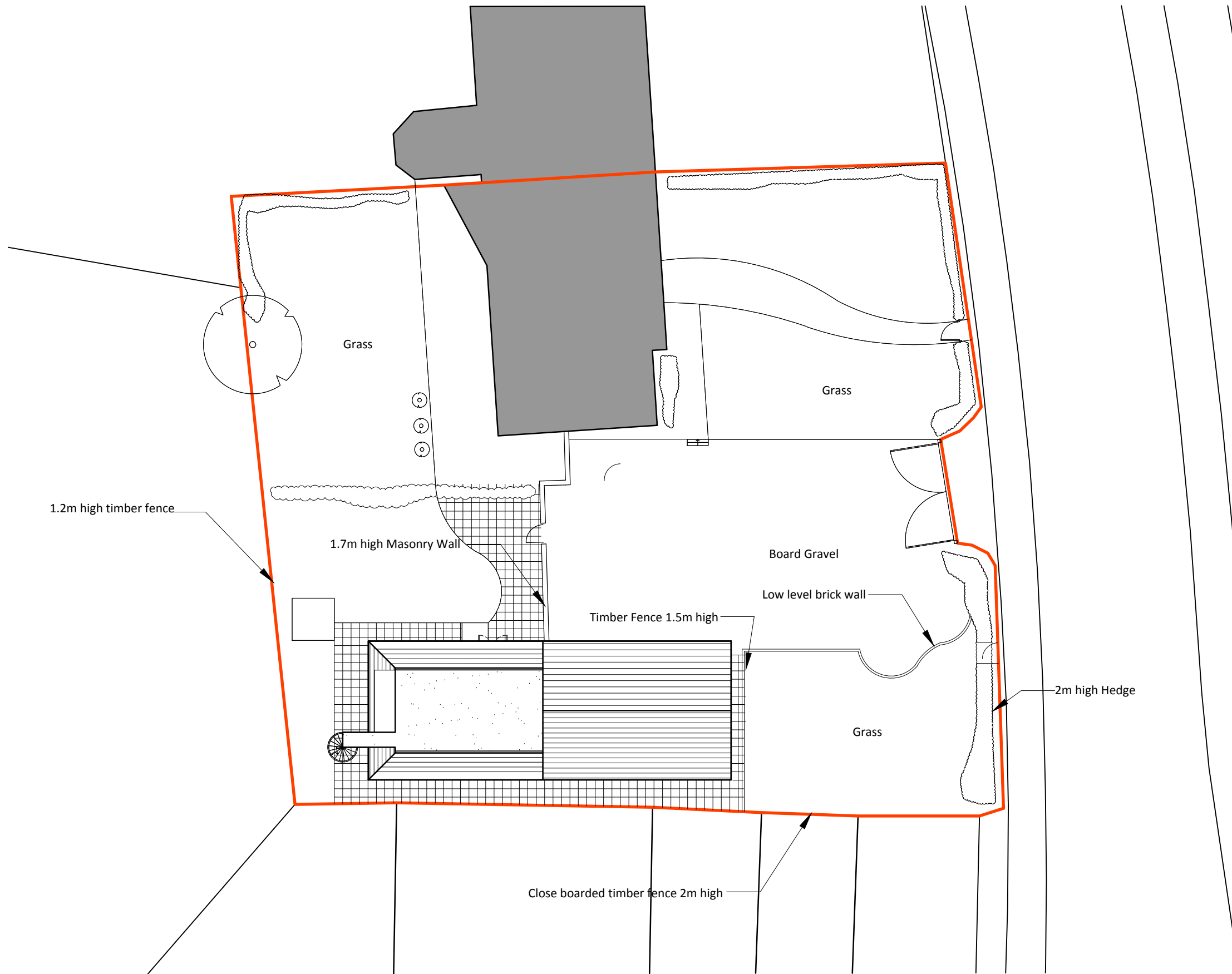
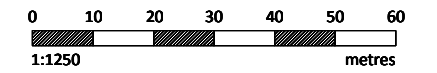

1.2m high timber fence

1.7m high Masonry Wall

Board Gravel

Low level brick wall

Timber Fence 1.5m high

2m high Hedge

Grass

Close boarded timber fence 2m high

Existing Block Plan
 1:200

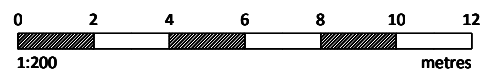

2 The Parade, Ash Road, Hartley
 Longfield, Kent DA3 8BG
 Tel: 01474 703705
www.grahamsimpkinplanning.co.uk
 Email: webmail@grahamsimpkinplanning.co.uk

Project Title 2 Bonnyacre Farm Cottis, Culverstone Green, Kent, DA13 0RF		Job No 2999
Drawing Title Site Location and Existing Block Plan	Drawing No 01	Revision -
Date 05.04.2019	Drawn by JV	Checked by DA

Scale
 1:1250 & 1:200
 @ A3

Note

