

M B
B M

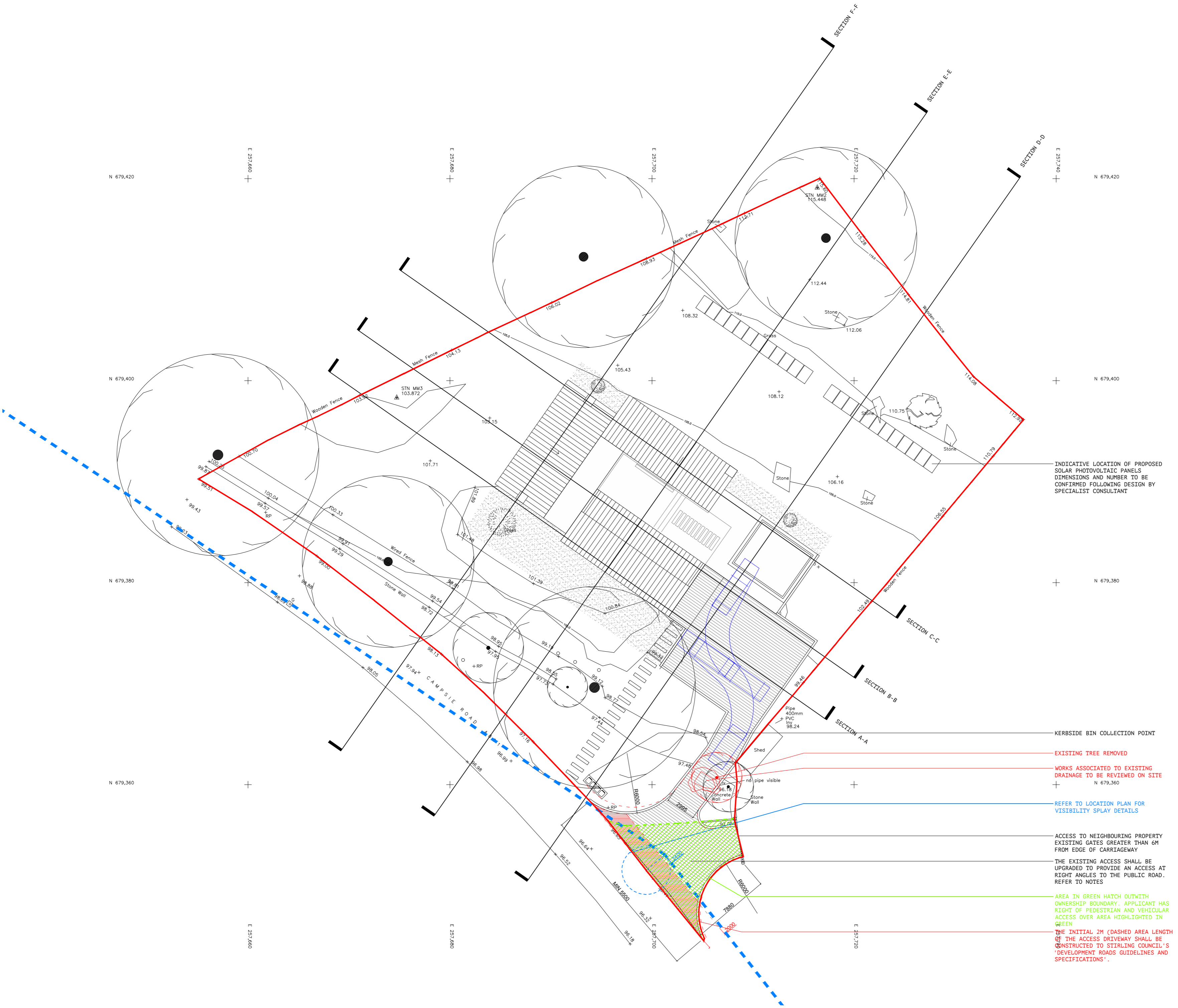

INDICATIVE LOCATION OF PROPOSED SOLAR PHOTOVOLTAIC PANELS DIMENSIONS AND NUMBER TO BE CONFIRMED FOLLOWING DESIGN BY SPECIALIST CONSULTANT

NOTE:
TOPOGRAPHICAL SURVEY CARRIED OUT BY MALCOLM HUGHES CHARTERED SURVEYORS ISSUED 23/10/2020

ALL LEVELS ILLUSTRATED AS EXISTING
THE EXISTING ACCESS SHALL BE UPGRADED TO PROVIDE AN ACCESS AT RIGHT ANGLES TO THE PUBLIC ROAD. FORMED AS A BELLMOUTH COMPRISING OF A 6M RADII LEADING TO A MINIMUM THROUGH WIDTH OF 5.5M. THE BELLMOUTH SHOULD BE CONSTRUCTED IN ACCORDANCE WITH THE AUTHORITY'S SPECIFICATION WITH THE ACCESS BEING SUITABLY SURFACED/DRAINED TO ENSURE THAT NO LOOSE MATERIAL OR SURFACE WATER WILL BE CARRIED OR DISCHARGED FROM IT ONTO THE PUBLIC ROAD. ANY ACCESS GATES SHOULD BE SET BACK A MINIMUM OF 6M MEASURED FROM THE EDGE OF THE ADJACENT PUBLIC ROAD AND OPEN INWARDS ONLY. THE INITIAL 2M (DASHED AREA LENGTH OF THE ACCESS DRIVEWAY SHALL BE CONSTRUCTED TO STIRLING COUNCIL'S 'DEVELOPMENT ROADS GUIDELINES AND SPECIFICATIONS'.

INDICATES APPLICATION AREA

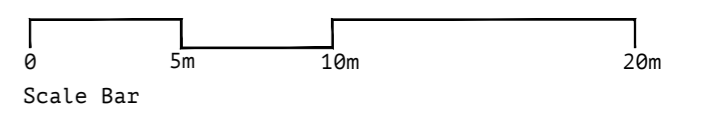

Notes

- Do not scale from drawings.
- Errors to be reported immediately to the Architect.
- To be read in conjunction with all relevant Architects, Services & Structural Engineers drawings.
- All existing site, trees and building information has been compiled from different sources.
- All dimensions to be checked on site.

Revision	Description	Date	Check
C	Red Line Boundary	24/03/21	AR/MB
B	Planning Comments	15/07/21	AR/MB
A	General Update	08/02/21	AR/MB

McGinlay Bell

Baltic Chambers
Basement Suite 27
50 Wellington Street
Glasgow
G2 6HJ
info@mcginlaybell.com

Project: THROUGHSTONE - STRATHBLANE
Client: DAMIEN FRENCH

Date: OCTOBER 2020
Scale / Format: 1:250 @ A2
Drawn / Checked: AR / MB
Drawing Name: SITE PLAN AS PROPOSED TOPOGRAPHIC
Drawing No: L[00]005