

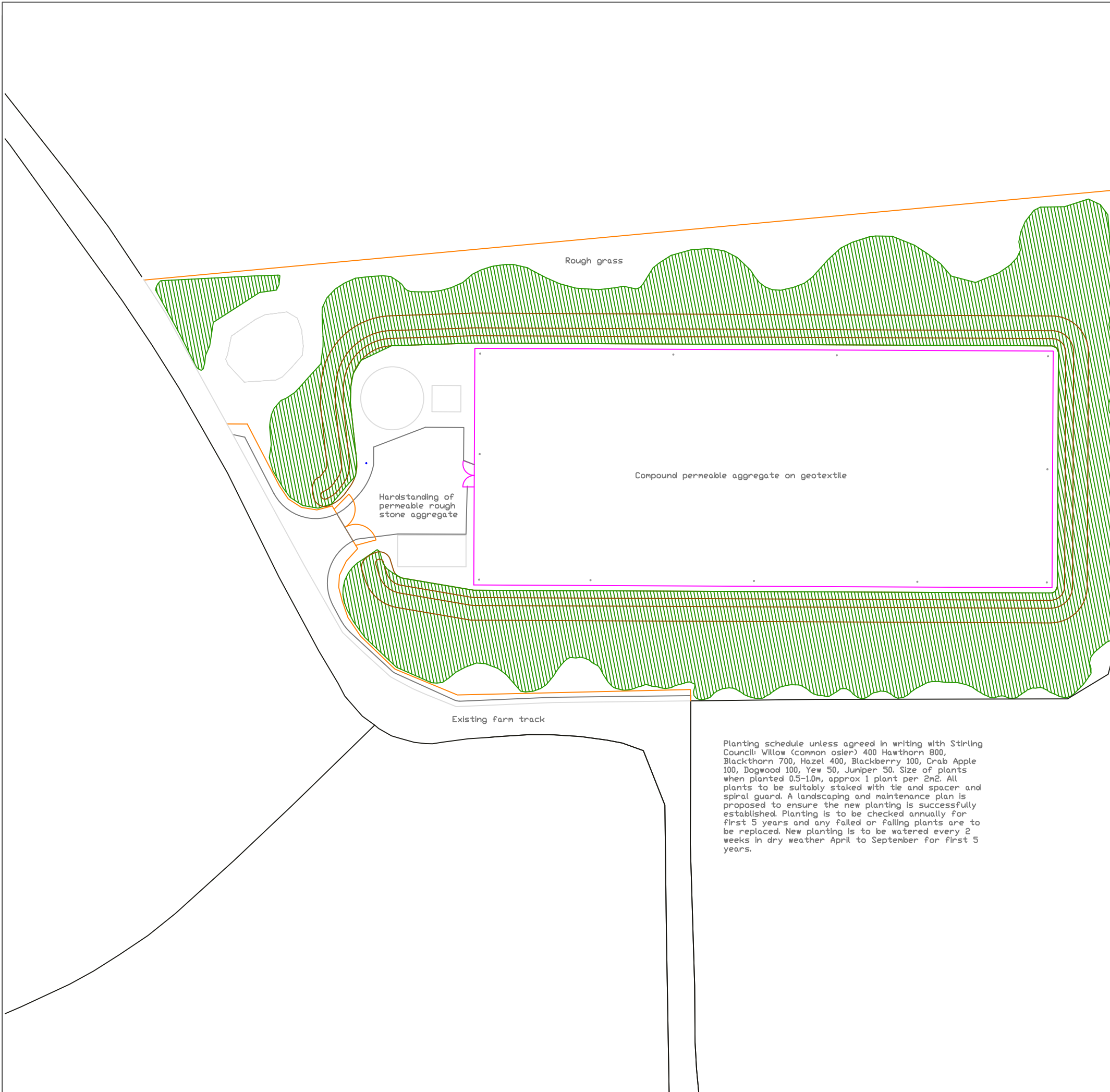



Bolfornought Farm



Planting schedule unless agreed in writing with Stirling Council: Willow (common osier) 400 Hawthorn 800, Blackthorn 700, Hazel 400, Blackberry 100, Crab Apple 100, Dogwood 100, Yew 50, Juniper 50. Size of plants when planted 0.5-1.0m, approx 1 plant per 2m². All plants to be suitably staked with tie and spacer and spiral guard. A landscaping and maintenance plan is proposed to ensure the new planting is successfully established. Planting is to be checked annually for first 5 years and any failed or falling plants are to be replaced. New planting is to be watered every 2 weeks in dry weather April to September for first 5 years.

-  Wooden fence
-  Stock fence
-  Landscape bund
-  New planting of native trees

Scale 1:750 at A3

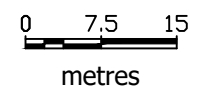

© Crown Copyright and database right 2021
 Ordnance Survey 0100031673
 © Copyright LoganPM Ltd 2021

LOGAN^{PM}
 Energy Project Management

Figure 5. Landscaping

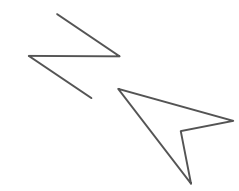

Drawing number
 J339/048/08042021

Status