

COPYRIGHT:  
 This material produced by PalczewskaGrimes Arch Studio is copyrighted under UK and international law and it is only for the use of PG Arch Studio or those of which explicitly authorized; in no case this material can be used by any other party without prior written consent.  
 All rights reserved.

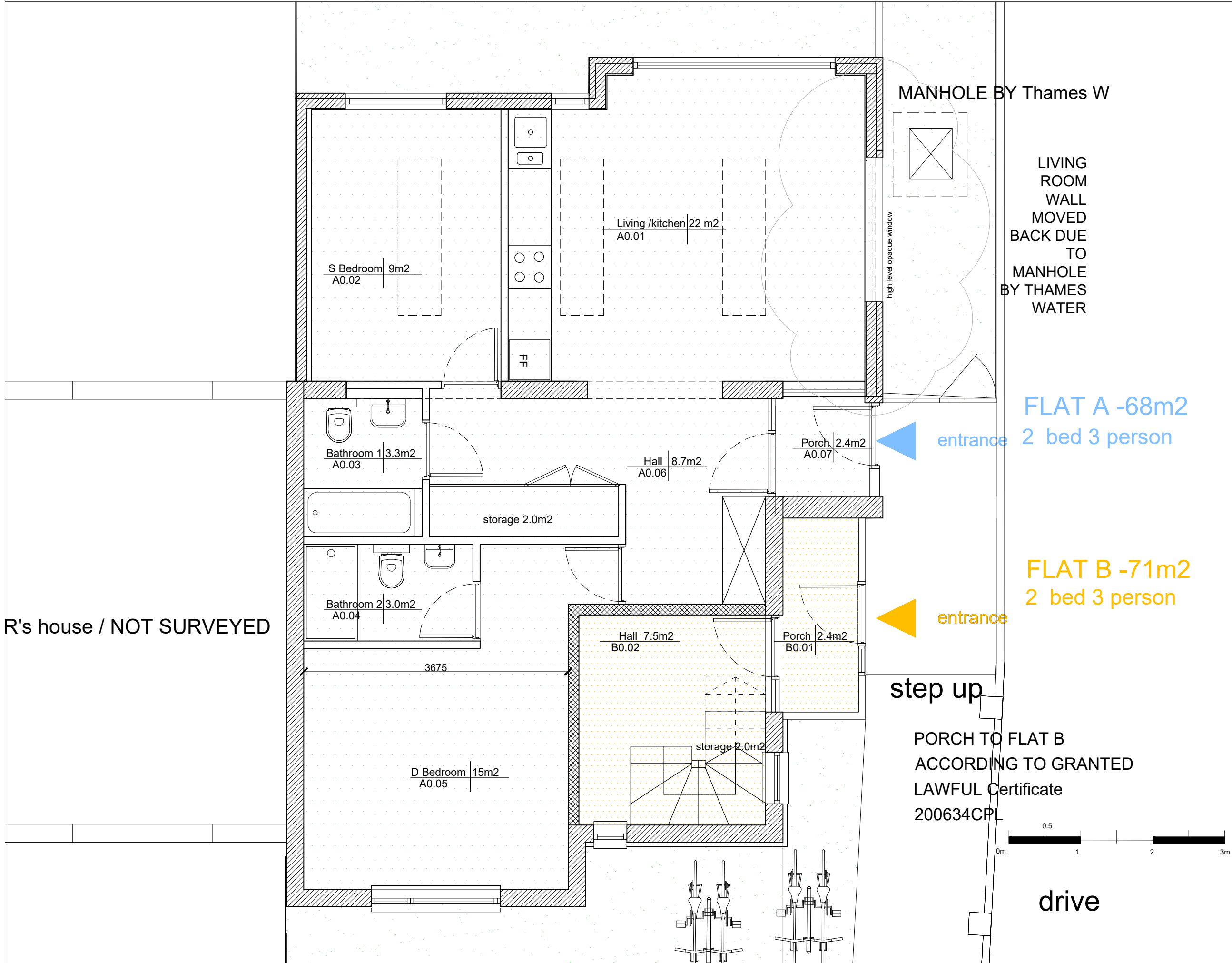

MANHOLE BY Thames W

LIVING ROOM WALL MOVED BACK DUE TO MANHOLE BY THAMES WATER

FLAT A -68m<sup>2</sup>  
 2 bed 3 person

FLAT B -71m<sup>2</sup>  
 2 bed 3 person

R's house / NOT SURVEYED

step up  
 PORCH TO FLAT B  
 ACCORDING TO GRANTED  
 LAWFUL Certificate  
 200634CPL

drive

REVISION DESCRIPTION:

Number	Date	Description

CLIENT: Mr. Jakub Grzedzinski  
 Author: PalczewskaGrimes Architecture  
 13 Hillside AV  
 bn25 3la Seaford

PROJECT address: 17 Thirsk Close UB5 4DS London

JOB TITLE:  
 Conversion of a single family house into 2 flats

TITLE: Proposed Groundfloor plan

DRAWING NO: 17THC-2104-PL-00-009

SCALE: 1:50@A3

REV.: - PHASE: PLANNING

DATE: March 21 DRAWN BY: MG