

COPYRIGHT:  
 This material produced by PalczewskaGrimes Arch Studio is copyrighted under UK and international law and it is only for the use of PG Arch Studio or those of which explicitly authorized; in no case this material can be used by any other party without prior written consent. All rights reserved.

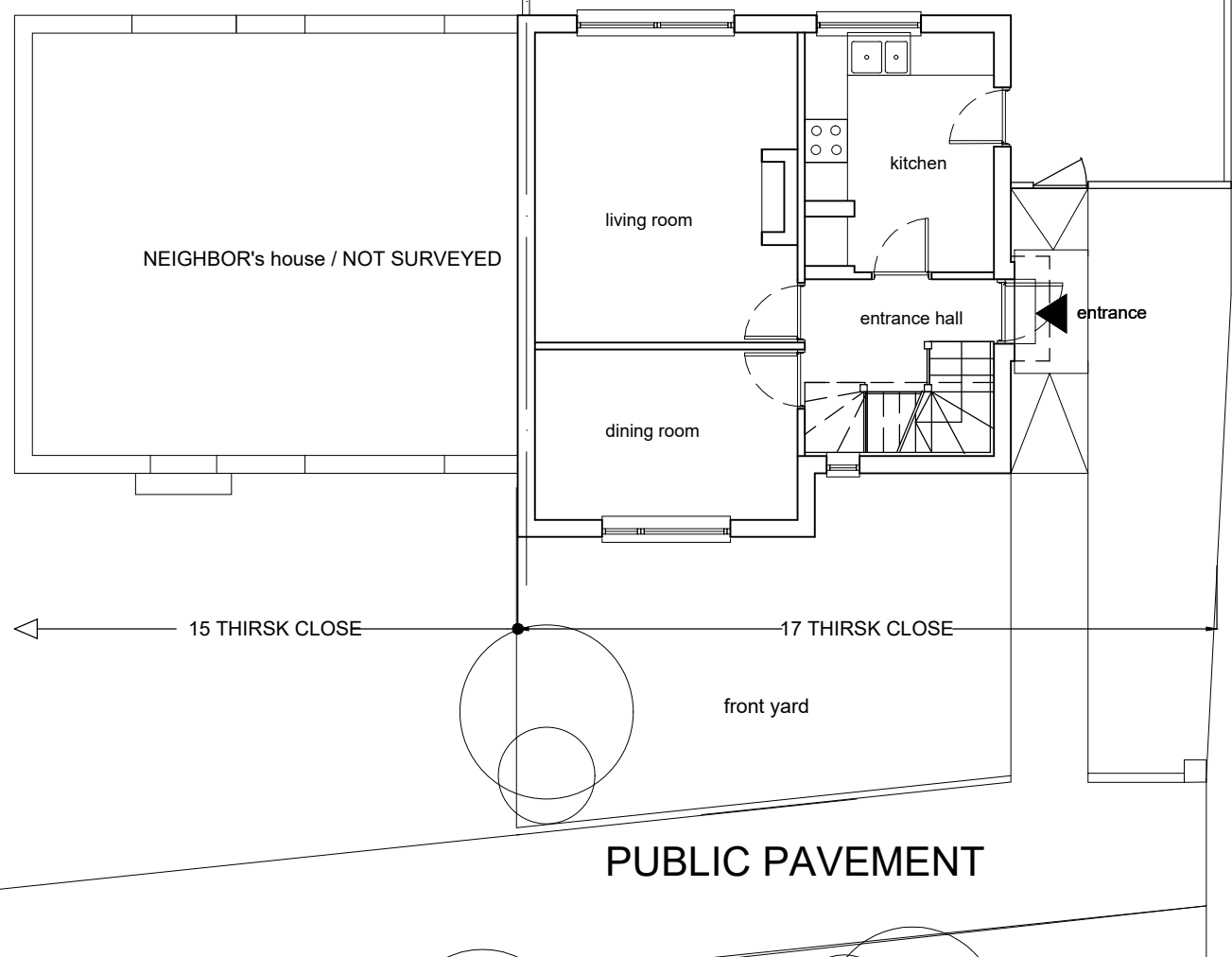

DRIVE TO GARAGES

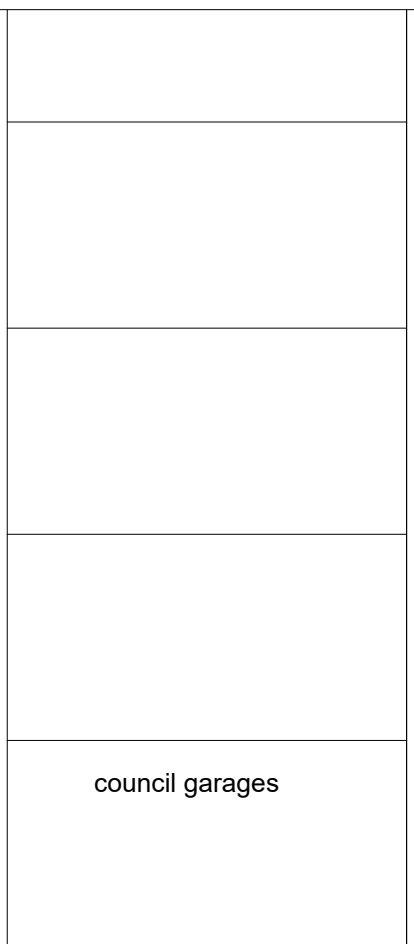

green public area

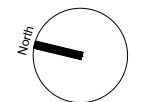

REVISION DESCRIPTION:

Number	Date	Description

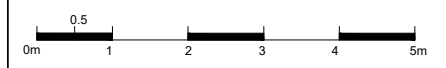

CLIENT: Mr. Jakub Grzedzinski  
 Author: PGrimes Architecture  
 13 Hillside Avenue  
 bn25 3la Seaford

PROJECT address: 17 Thirsk Close UB5 4DS London

JOB TITLE: Conversion of a single family house into 2 flats

TITLE: Existing Ground floor Plan

DRAWING NO: 17THC-2104-EX-00-101

SCALE: 1:100 @A3

REV. : - PHASE : Planning

DATE : March 2021 DRAWN BY: MG

01 Existing Ground floor plan  
 101 1:100