

PAPER SIZE A4

Cherry Tree House, Brinsea Road, Congresbury, North Somerset, BS49 5JJ

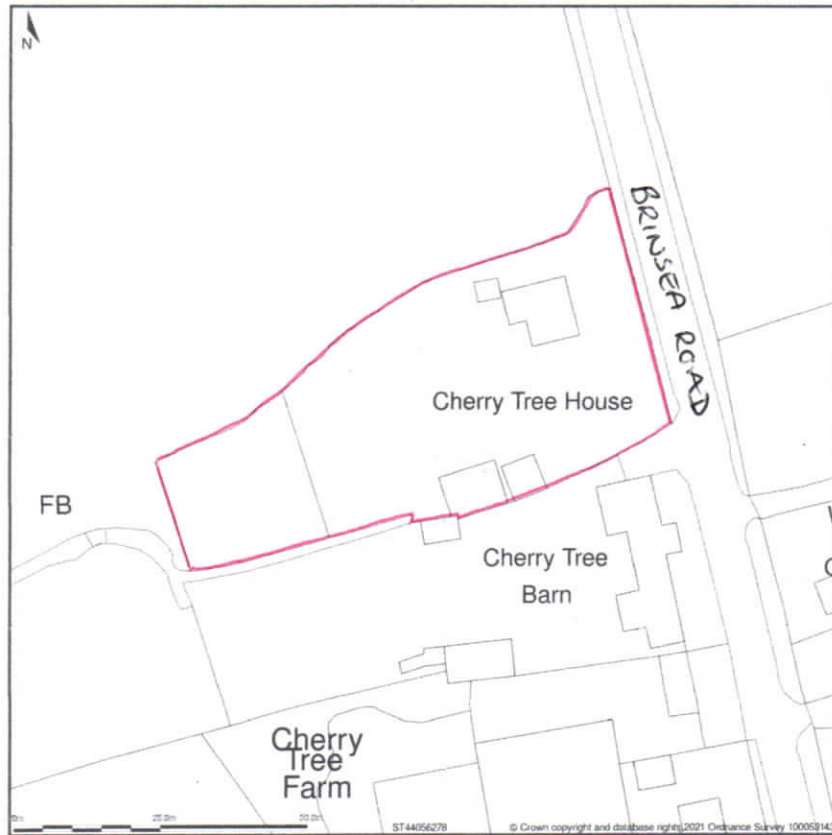

Site Plan shows area bounded by: 343984.43, 162709.33 344125.85, 162850.75 (at a scale of 1:1250), OSGridRef: ST44056278. The representation of a road, track or path is no evidence of a right of way. The representation of features as lines is no evidence of a property boundary.

Produced on 31st Mar 2021 from the Ordnance Survey National Geographic Database and incorporating surveyed revision available at this date. Reproduction in whole or part is prohibited without the prior permission of Ordnance Survey. © Crown copyright 2021. Supplied by www.buyaplan.co.uk a licensed Ordnance Survey partner (100053143). Unique plan reference: #00617499-4697B2

Ordnance Survey and the OS Symbol are registered trademarks of Ordnance Survey, the national mapping agency of Great Britain. Buy A Plan logo, pdf design and the www.buyaplan.co.uk website are Copyright © Pass Inc Ltd 2021

PAPER SIZE A4

Cherry Tree House, Brinsea Road, Congresbury, North Somerset, BS49 5JJ

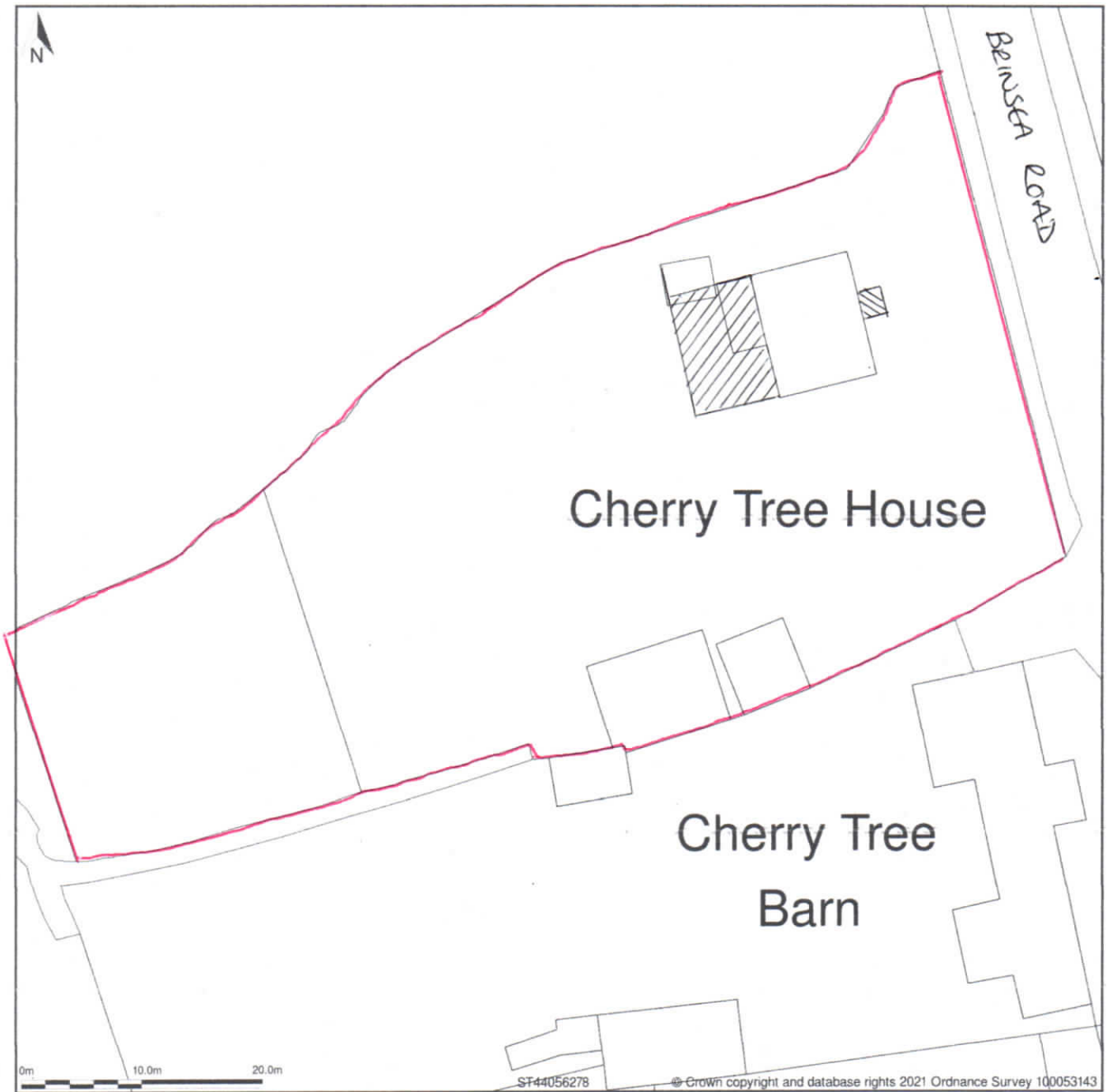

Block Plan shows area bounded by: 344010.24, 162735.12 344100.24, 162825.12 (at a scale of 1:500), OSGridRef: ST44056278. The representation of a road, track or path is no evidence of a right of way. The representation of features as lines is no evidence of a property boundary.

Produced on 31st Mar 2021 from the Ordnance Survey National Geographic Database and incorporating surveyed revision available at this date. Reproduction in whole or part is prohibited without the prior permission of Ordnance Survey. © Crown copyright 2021. Supplied by www.buyaplan.co.uk a licensed Ordnance Survey partner (100053143). Unique plan reference: #00617498-B60F91

Ordnance Survey and the OS Symbol are registered trademarks of Ordnance Survey, the national mapping agency of Great Britain. Buy A Plan logo, pdf design and the www.buyaplan.co.uk website are Copyright © Pass Inc Ltd 2021