

Historical Mapping Legends

Ordnance Survey County Series 1:10,560

	Gravel Pit		Sand Pit		Other Pits
	Quarry		Shingle		Orchard
	Osiers		Reeds		Marsh
	Mixed Wood		Deciduous		Brushwood
	Fir		Furze		Rough Pasture
	Arrow denotes flow of water		Trigonometrical Station		
	Site of Antiquities		Bench Mark		
	Pump, Guide Post, Signal Post		Well, Spring, Boundary Post		
	•285 Surface Level				
	Sketched Contour		Instrumental Contour		
	Main Roads		Minor Roads		
	Sunken Road		Raised Road		
	Road over Railway		Railway over River		
	Railway over Road		Level Crossing		
	Road over River or Canal		Road over Stream		
	Road over Stream				
	County Boundary (Geographical)				
	County & Civil Parish Boundary				
	Administrative County & Civil Parish Boundary				
	County Borough Boundary (England)				
	County Borough Boundary (Scotland)				
	Rural District Boundary				
	Civil Parish Boundary				

Ordnance Survey Plan 1:10,000

	Chalk Pit, Clay Pit or Quarry		Gravel Pit
	Sand Pit		Disused Pit or Quarry
	Refuse or Slag Heap		Lake, Loch or Pond
	Dunes		Boulders
	Coniferous Trees		Non-Coniferous Trees
	Orchard		Scrub
	Bracken		Heath
	Marsh		Reeds
	Building		Glasshouse
	Sloping Masonry		Pylon
	Cutting		Embankment
	Road Under		Road Over
	Level Crossing		Foot Bridge
	Standard Gauge Multiple Track		Standard Gauge Single Track
	Siding, Tramway or Mineral Line		Narrow Gauge
	Geographical County		Administrative County, County Borough or County of City
	Municipal Borough, Urban or Rural District, Burgh or District Council		Borough, Burgh or County Constituency
	Civil Parish		
	BP, BS Boundary Post or Stone		Police Station
	Church		Post Office
	Club House		Public Convenience
	Fire Engine Station		Public House
	Foot Bridge		Signal Box
	Fountain		Spring
	Guide Post		Telephone Call Box
	Mile Post		Telephone Call Post
	Mile Stone		Well

1:10,000 Raster Mapping

	Gravel Pit		Refuse tip or slag heap
	Rock		Rock (scattered)
	Boulders		Boulders (scattered)
	Shingle		Mud
	Sand		Sand Pit
	Slopes		Top of cliff
	General detail		Underground detail
	Overhead detail		Narrow gauge railway
	Multi-track railway		Single track railway
	County boundary (England only)		Civil, parish or community boundary
	District, Unitary, Metropolitan, London Borough boundary		Constituency boundary
	Area of wooded vegetation		Non-coniferous trees
	Non-coniferous trees (scattered)		Coniferous trees
	Coniferous trees (scattered)		Positioned tree
	Orchard		Coppice or Osiers
	Rough Grassland		Heath
	Scrub		Marsh, Salt Marsh or Reeds
	Water feature		Flow arrows
	Mean high water (springs)		Mean low water (springs)
	Telephone line (where shown)		Electricity transmission line (with poles)
	Bench mark (where shown)		Triangulation station
	Point feature (e.g. Guide Post or Mile Stone)		Pylon, flare stack or lighting tower
	Site of (antiquity)		Glasshouse
	General Building		Important Building



Historical Mapping & Photography included:

Mapping Type	Scale	Date	Pg
Lancashire And Furness	1:10,560	1847 - 1848	3
Lancashire And Furness	1:10,560	1895	4
Lancashire And Furness	1:10,560	1913	5
Lancashire And Furness	1:10,560	1930	6
Lancashire And Furness	1:10,560	1933	7
Lancashire And Furness	1:10,560	1938	8
Ordnance Survey Plan	1:10,000	1955 - 1956	9
Ordnance Survey Plan	1:10,000	1967	10
Ordnance Survey Plan	1:10,000	1972 - 1973	11
Blackpool	1:10,000	1976	12
Ordnance Survey Plan	1:10,000	1983 - 1987	13
Ordnance Survey Plan	1:10,000	1992 - 1993	14
10K Raster Mapping	1:10,000	2001	15
10K Raster Mapping	1:10,000	2006	16
VectorMap Local	1:10,000	2020	17

Historical Map - Slice A

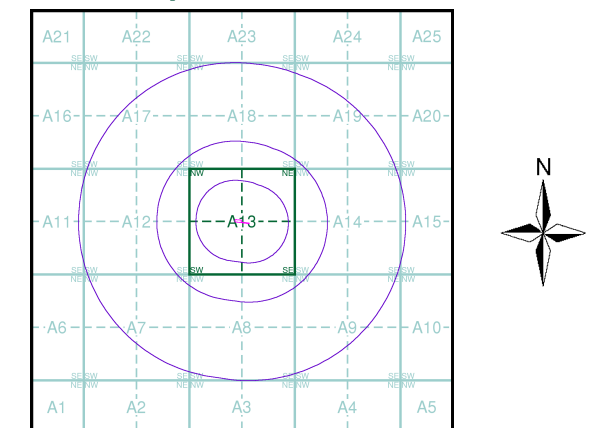

Order Details

Order Number: 272247102_1_1
Customer Ref: LKC 20 1381
National Grid Reference: 333330, 439630
Slice: A
Site Area (Ha): 0.08
Search Buffer (m): 1000

Site Details

157a Blackpool Road, Poulton-le-Fylde, FY6 7QH



Tel: 0844 844 9952
Fax: 0844 844 9951
Web: www.envirocheck.co.uk

Russian Military Mapping Legends

1:5,000 and 1:10,000 mapping

a. Not drawn to scale b. Drawn to scale

Government and Administrative Buildings Military and Industrial Buildings

Military and Communication Areas Subway Entrance

Fireproof Building Prominent Fireproof Building

Non-fireproof Building Non-fireproof Building (non-dwelling)

Factory, mill, and flour mill, with chimneys Factory, mill, and flour mill, without chimneys

Power Station, drawn to scale Hydroelectric Power Station

Radio Station, drawn to scale Telephone Station, drawn to scale

Abandoned Open-pit Mine or Quarry Open-pit Salt Mine

Pit Oil Deposit or Well Oil Seepage

Tailings Pile Fuel Storage Tanks Natural Gas Tank

Bench Mark Drill Hole Burial Mound Triangulation Point on Burial Mound

Single-track Railroad Double-track Railroad and Station Building

Coniferous Forest Deciduous Forest Mixed Forest

Lawns Citrus Orchard Wet Ground Scattered Vegetation

243.8 Values for prominent elevations

186.0 Numbers for spot elevations, depth soundings, contour lines, etc.

0.2 Velocity of the current, width of river bed, depth of river

180/12 Fractional terms: length and capacity of bridges; depth of fords and condition of the river bottom; height of forest and the diameter of trees

Russian Alphabet (For reference and phonetic interpretation of map text)

А а (A) З з (Z) П п (P) Ч ч (CH)

Б б (B) И и (I) Р р (R) Ш ш (SH)

В в (V) Й й (Y) С с (S) Щ щ (SHCH)

Г г (G) К к (K) Т т (T) Ъ ъ (-)

Д д (D) Л л (L) У у (U) Ы ы (Y)

Е е (E) М м (M) Ф ф (F) Ь ь (')

Ё ё (YO) Н н (N) Х х (KH) Э э (E)

Ж ж (ZH) О о (O) Ц ц (TS) Ю ю (YU or IU)

Я я (YA or IA)

1:25,000 mapping

a. Not drawn to scale b. Drawn to scale

Government and Administrative Buildings Military and Industrial Buildings

Military and Communication Areas Subway Entrance

Partly Demolished Buildings Demolished Buildings

Built-Up Area with Fireproof Buildings Predominant Built-Up Area with Non-Fireproof Buildings Predominant

Individual Fireproof Building Prominent Industrial Building

Individual Dwelling, Fireproof Ruins of an Individual Dwelling

Factory or Mill Chimney Factory or Mill with Chimney Factory or Mill without Chimney Mine or Open Pit Mine

Operating Shaft or Mine Non-Operating Shaft or Mine Salt Mine Tailings Pile

Pit Stone Quarry Gas Pump or Service Station Fuel Storage or Natural Gas Tank

Oil or Natural Gas Derrick Small Hydroelectric Power Station Power Station Transformer Station

Cemetery Burial Mound (height in metres) Triangulation Point on Burial Mound Triangulation Point

Bench Mark Bench Mark (monumented) Telegraph Office Telephone Station

Radio Station Radio Tower Airfield or Seaplane Base Landing Strip

Telegraph/Telephone Lines Main Highway Highway under Construction Improved Dirt Road (former truck road)

Double-track Railroad with First Class Station Dismantled Railroad Railroad Under Construction

Shore Embankment River or Ditch with Embankment Direction and velocity of current Water Gauge Water Level Mark

Well Water Reservoir or Rain Water Pit Spring Isobath with value

Heavy (Index) Contour Line Contour Line and Value Half Contour Line Spot Elevation Value

Coniferous Deciduous Mixed Scrub

Key to Numbers on Mapping



Historical Mapping & Photography included:

Mapping Type	Scale	Date	Pg
Lancashire And Furness	1:10,560	1847 - 1848	3
Lancashire And Furness	1:10,560	1895	4
Lancashire And Furness	1:10,560	1913	5
Lancashire And Furness	1:10,560	1930	6
Lancashire And Furness	1:10,560	1933	7
Lancashire And Furness	1:10,560	1938	8
Ordnance Survey Plan	1:10,000	1955 - 1956	9
Ordnance Survey Plan	1:10,000	1967	10
Ordnance Survey Plan	1:10,000	1972 - 1973	11
Blackpool	1:10,000	1976	12
Ordnance Survey Plan	1:10,000	1983 - 1987	13
Ordnance Survey Plan	1:10,000	1992 - 1993	14
10K Raster Mapping	1:10,000	2001	15
10K Raster Mapping	1:10,000	2006	16
VectorMap Local	1:10,000	2020	17

Russian Map - Slice A

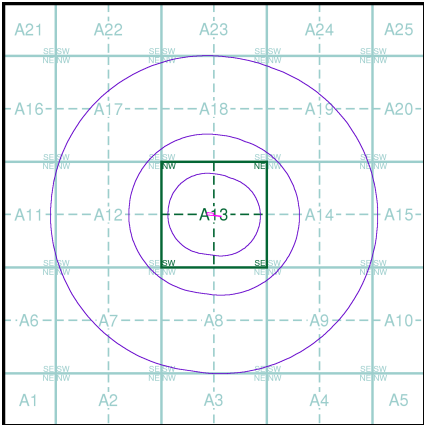

Order Details

Order Number: 272247102_1_1

Customer Ref: LKC 20 1381

National Grid Reference: 333330, 439630

Slice: A

Site Area (Ha): 0.08

Search Buffer (m): 1000

Site Details

157a Blackpool Road, Poulton-le-Fylde, FY6 7QH



Tel: 0844 844 9952

Fax: 0844 844 9951

Web: www.envirocheck.co.uk

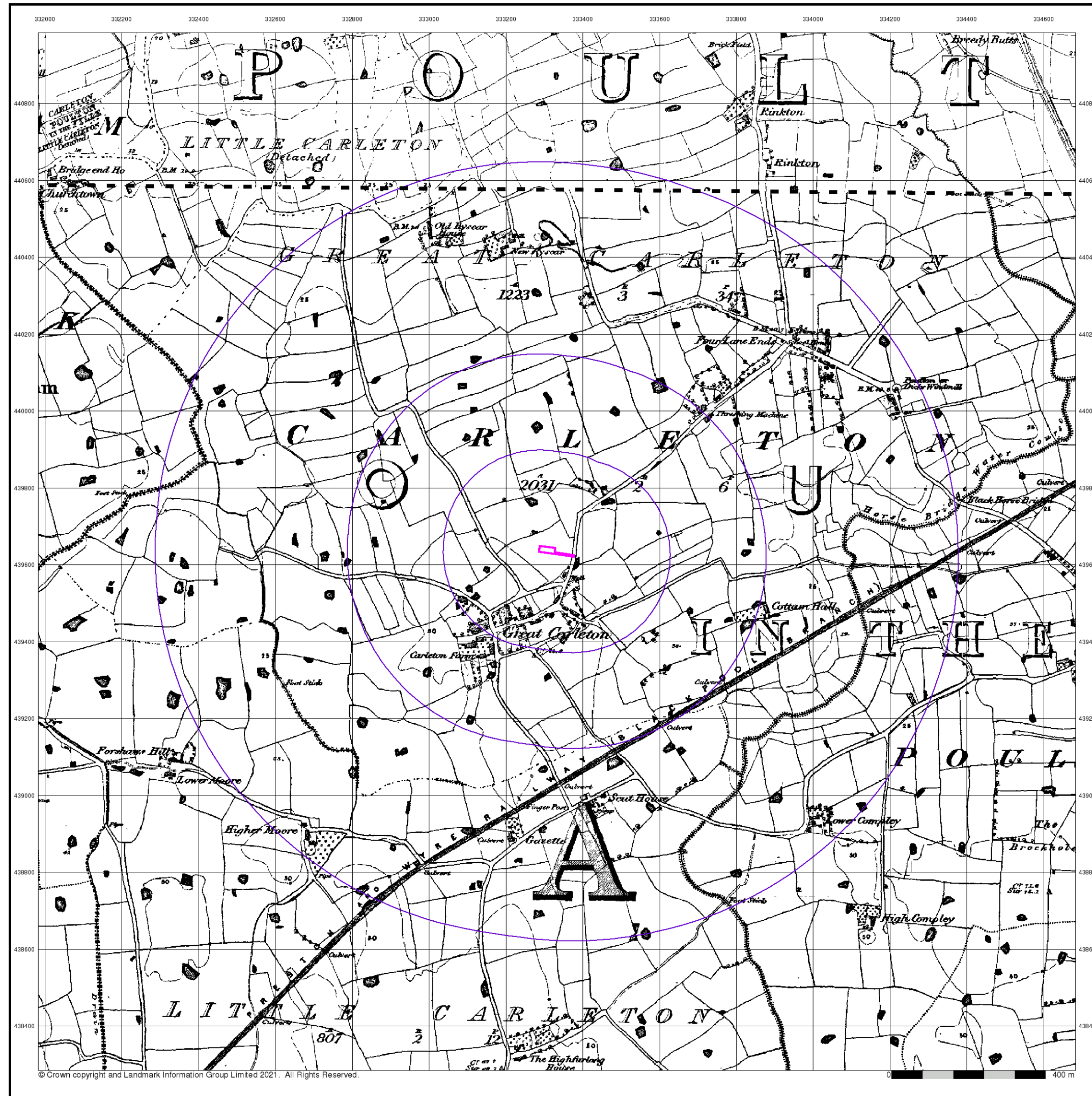

© Crown copyright and Landmark Information Group Limited 2021. All Rights Reserved.

LK GROUP

Lancashire And Furness

Published 1847 - 1848

Source map scale - 1:10,560

The historical maps shown were reproduced from maps predominantly held at the scale adopted for England, Wales and Scotland in the 1840's. In 1854 the 1:2,500 scale was adopted for mapping urban areas; these maps were used to update the 1:10,560 maps. The published date given therefore is often some years later than the surveyed date. Before 1938, all OS maps were based on the Cassini Projection, with independent surveys of a single county or group of counties, giving rise to significant inaccuracies in outlying areas. In the late 1940's, a Provisional Edition was produced, which updated the 1:10,560 mapping from a number of sources. The maps appear unfinished - with all military camps and other strategic sites removed. These maps were initially overprinted with the National Grid. In 1970, the first 1:10,000 maps were produced using the Transverse Mercator Projection. The revision process continued until recently, with new editions appearing every 10 years or so for urban areas.

Map Name(s) and Date(s)

04300
1848
1:10,560
05100
1847
1:10,560

Historical Map - Slice A

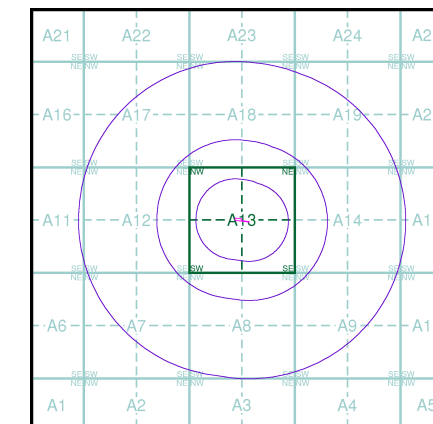

Order Details

Order Number: 272247102_1_1
Customer Ref: LKC 20 1381
National Grid Reference: 333330, 439630
Slice: A
Site Area (Ha): 0.08
Search Buffer (m): 1000

Site Details

157a Blackpool Road, Poulton-le-Fylde, FY6 7QH

Landmark
INFORMATION GROUP

Tel: 0844 844 9952
Fax: 0844 844 9951
Web: www.envirocheck.co.uk

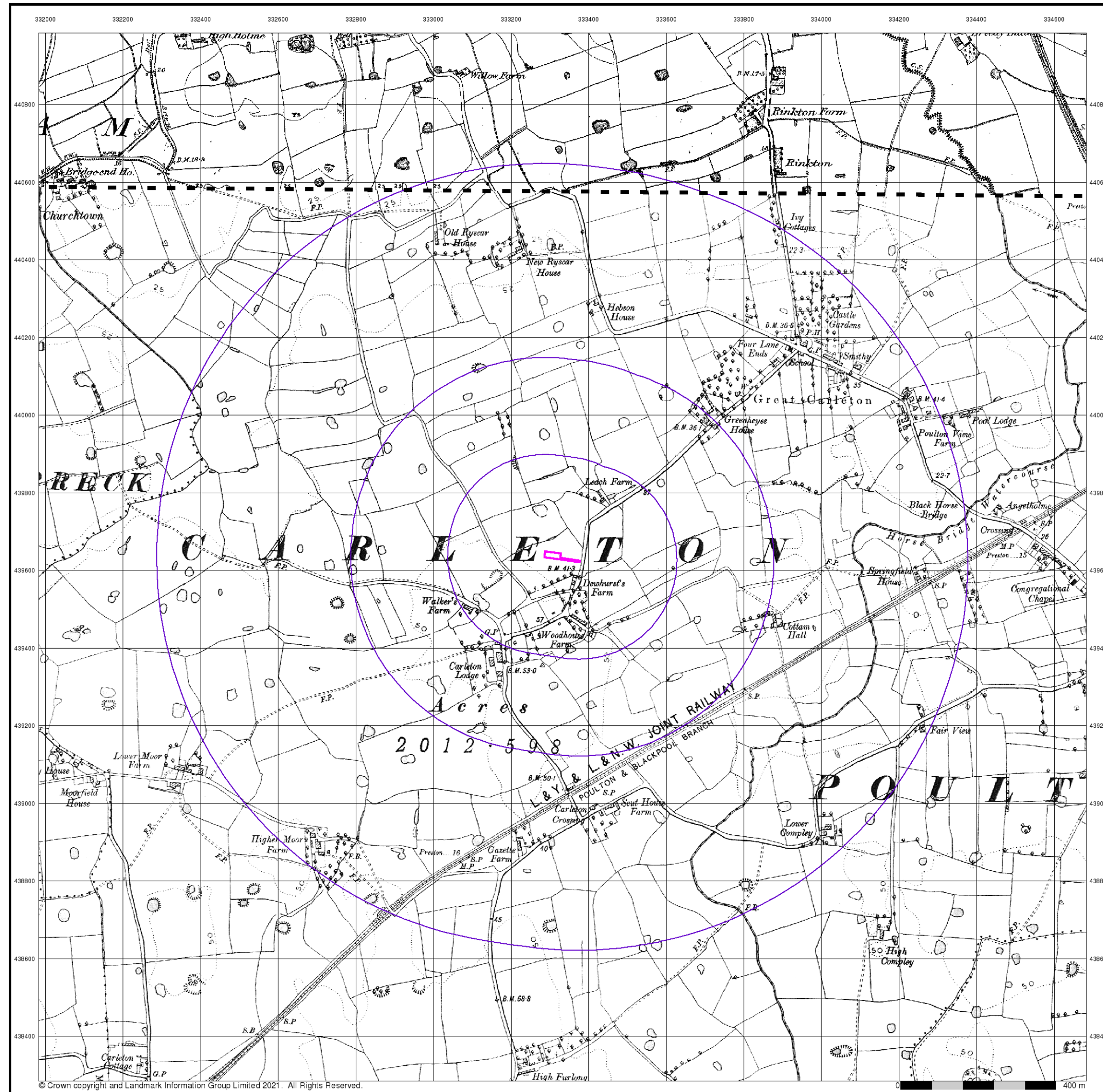

© Crown copyright and Landmark Information Group Limited 2021. All Rights Reserved.

LK GROUP

Lancashire And Furness

Published 1895

Source map scale - 1:10,560

The historical maps shown were reproduced from maps predominantly held at the scale adopted for England, Wales and Scotland in the 1840's. In 1854 the 1:2,500 scale was adopted for mapping urban areas; these maps were used to update the 1:10,560 maps. The published date given therefore is often some years later than the surveyed date. Before 1938, all OS maps were based on the Cassini Projection, with independent surveys of a single county or group of counties, giving rise to significant inaccuracies in outlying areas. In the late 1940's, a Provisional Edition was produced, which updated the 1:10,560 mapping from a number of sources. The maps appear unfinished - with all military camps and other strategic sites removed. These maps were initially overprinted with the National Grid. In 1970, the first 1:10,000 maps were produced using the Transverse Mercator Projection. The revision process continued until recently, with new editions appearing every 10 years or so for urban areas.

Map Name(s) and Date(s)

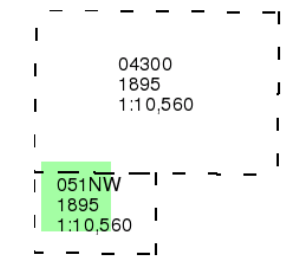

Historical Map - Slice A

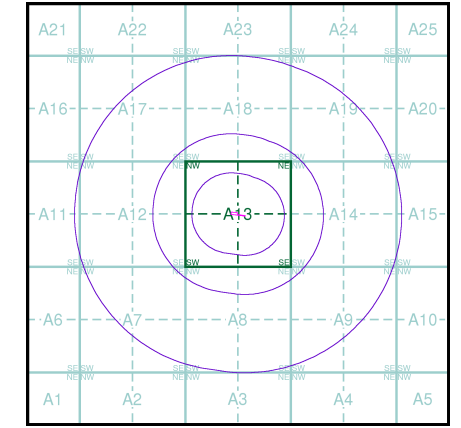

Order Details
Order Number: 272247102_1_1
Customer Ref: LKC 20 1381
National Grid Reference: 333330, 439630
Slice: A
Site Area (Ha): 0.08
Search Buffer (m): 1000

Site Details
157a Blackpool Road, Poulton-le-Fylde, FY6 7QH

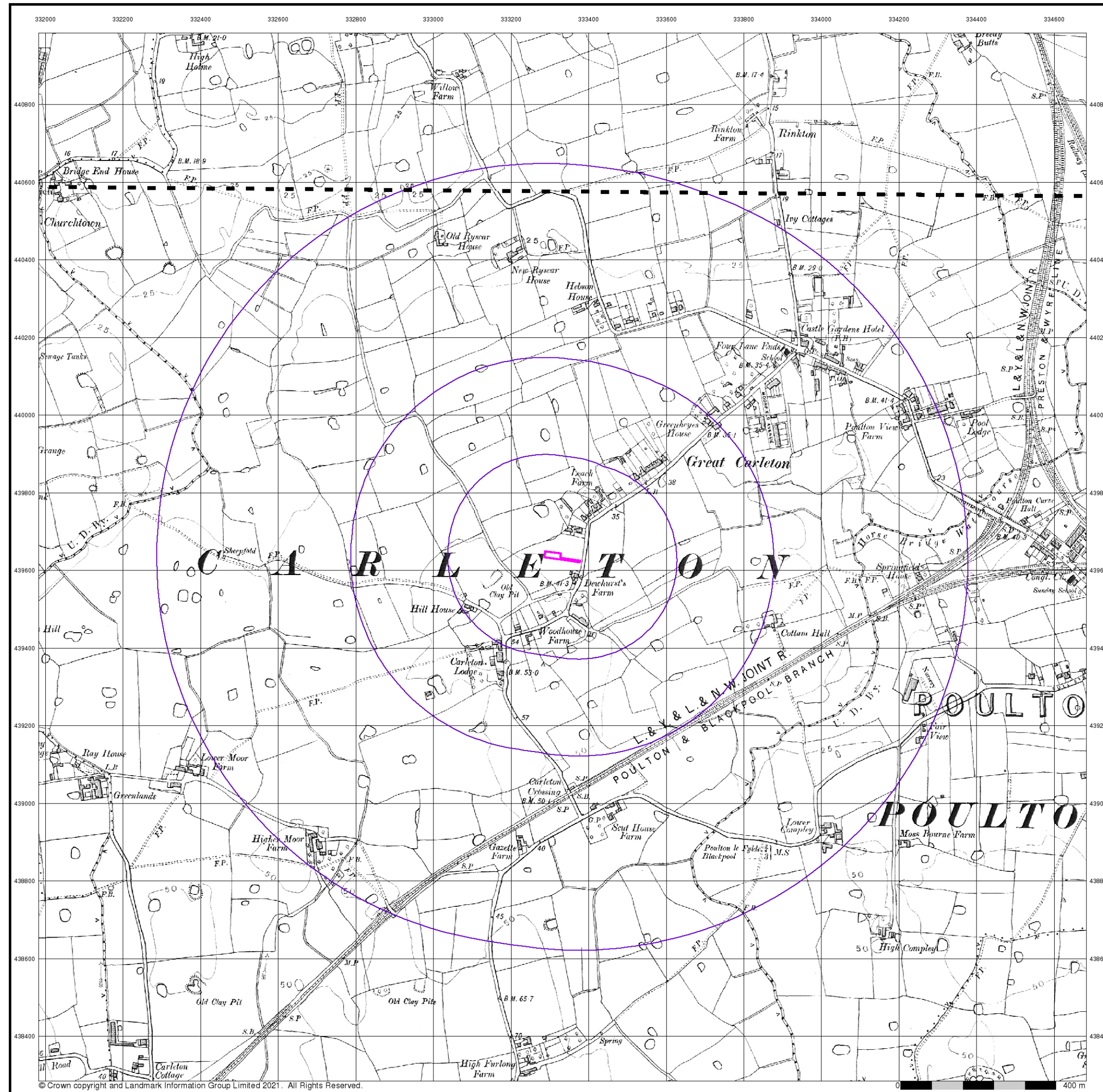

© Crown copyright and Landmark Information Group Limited 2021. All Rights Reserved.

LK GROUP

Lancashire And Furness

Published 1913

Source map scale - 1:10,560

The historical maps shown were reproduced from maps predominantly held at the scale adopted for England, Wales and Scotland in the 1840's. In 1854 the 1:2,500 scale was adopted for mapping urban areas; these maps were used to update the 1:10,560 maps. The published date given therefore is often some years later than the surveyed date. Before 1938, all OS maps were based on the Cassini Projection, with independent surveys of a single county or group of counties, giving rise to significant inaccuracies in outlying areas. In the late 1940's, a Provisional Edition was produced, which updated the 1:10,560 mapping from a number of sources. The maps appear unfinished - with all military camps and other strategic sites removed. These maps were initially overprinted with the National Grid. In 1970, the first 1:10,000 maps were produced using the Transverse Mercator Projection. The revision process continued until recently, with new editions appearing every 10 years or so for urban areas.

Map Name(s) and Date(s)

043SW
1913
1:10,560
051NW
1913
1:10,560

Historical Map - Slice A

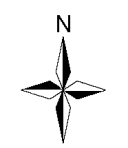
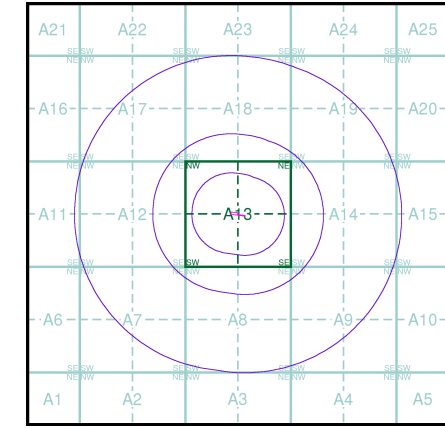

Order Details
Order Number: 272247102_1_1
Customer Ref: LKC 20 1381
National Grid Reference: 333330, 439630
Slice: A
Site Area (Ha): 0.08
Search Buffer (m): 1000

Site Details
157a Blackpool Road, Poulton-le-Fylde, FY6 7QH

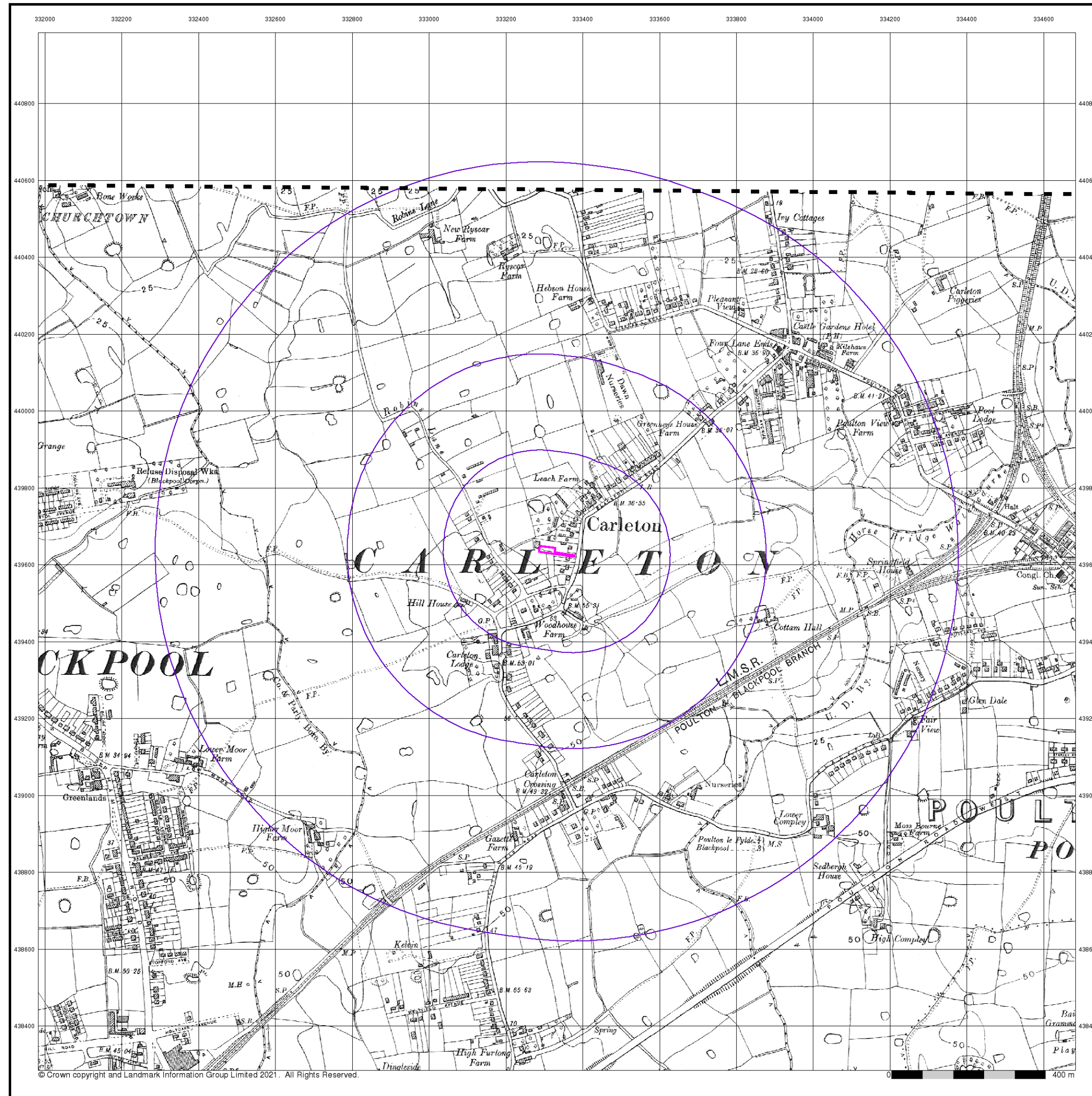

© Crown copyright and Landmark Information Group Limited 2021. All Rights Reserved.

LK GROUP

Lancashire And Furness

Published 1930

Source map scale - 1:10,560

The historical maps shown were reproduced from maps predominantly held at the scale adopted for England, Wales and Scotland in the 1840's. In 1854 the 1:2,500 scale was adopted for mapping urban areas; these maps were used to update the 1:10,560 maps. The published date given therefore is often some years later than the surveyed date. Before 1938, all OS maps were based on the Cassini Projection, with independent surveys of a single county or group of counties, giving rise to significant inaccuracies in outlying areas. In the late 1940's, a Provisional Edition was produced, which updated the 1:10,560 mapping from a number of sources. The maps appear unfinished - with all military camps and other strategic sites removed. These maps were initially overprinted with the National Grid. In 1970, the first 1:10,000 maps were produced using the Transverse Mercator Projection. The revision process continued until recently, with new editions appearing every 10 years or so for urban areas.

Map Name(s) and Date(s)

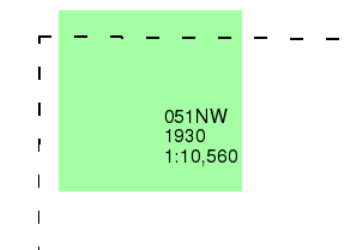

Historical Map - Slice A

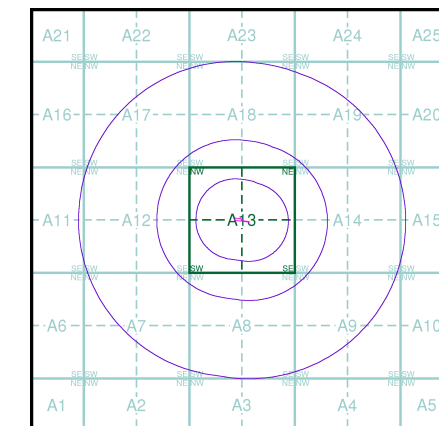

Order Details

Order Number: 272247102_1_1
Customer Ref: LKC 20 1381
National Grid Reference: 333330, 439630
Slice: A
Site Area (Ha): 0.08
Search Buffer (m): 1000

Site Details

157a Blackpool Road, Poulton-le-Fylde, FY6 7QH

Landmark
INFORMATION GROUP

Tel: 0844 844 9952
Fax: 0844 844 9951
Web: www.envirocheck.co.uk

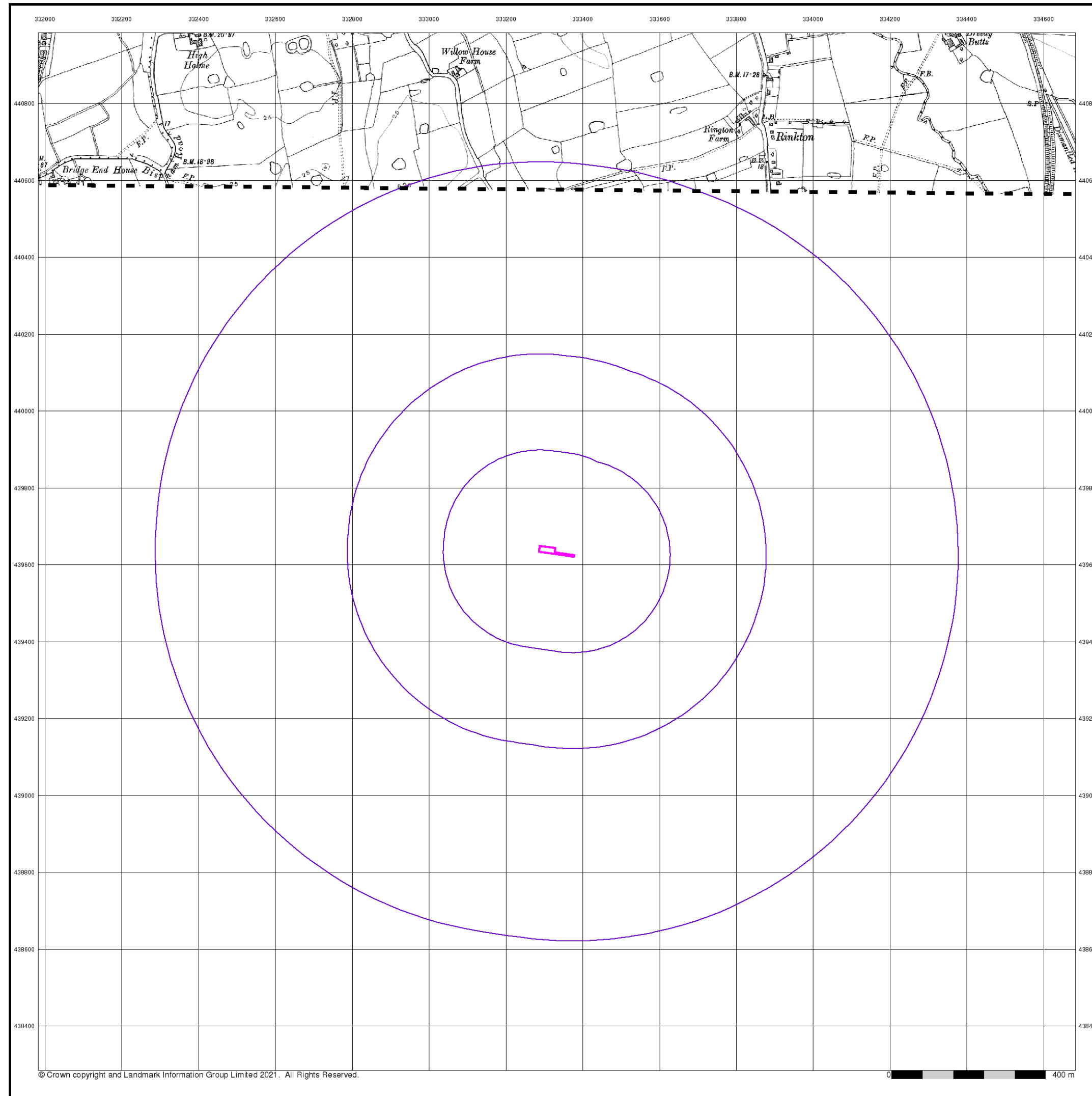

© Crown copyright and Landmark Information Group Limited 2021. All Rights Reserved.

Published 1933

Source map scale - 1:10,560

The historical maps shown were reproduced from maps predominantly held at the scale adopted for England, Wales and Scotland in the 1840's. In 1854 the 1:2,500 scale was adopted for mapping urban areas; these maps were used to update the 1:10,560 maps. The published date given therefore is often some years later than the surveyed date. Before 1938, all OS maps were based on the Cassini Projection, with independent surveys of a single county or group of counties, giving rise to significant inaccuracies in outlying areas. In the late 1940's, a Provisional Edition was produced, which updated the 1:10,560 mapping from a number of sources. The maps appear unfinished - with all military camps and other strategic sites removed. These maps were initially overprinted with the National Grid. In 1970, the first 1:10,000 maps were produced using the Transverse Mercator Projection. The revision process continued until recently, with new editions appearing every 10 years or so for urban areas.

Map Name(s) and Date(s)

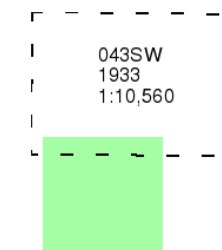

Historical Map - Slice A

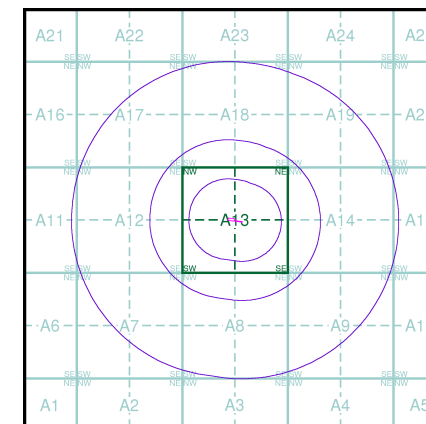

Order Details

Order Number: 272247102_1_1
Customer Ref: LKC 20 1381
National Grid Reference: 333330, 439630
Slice: A
Site Area (Ha): 0.08
Search Buffer (m): 1000

Site Details

157a Blackpool Road, Poulton-le-Fylde, FY6 7QH

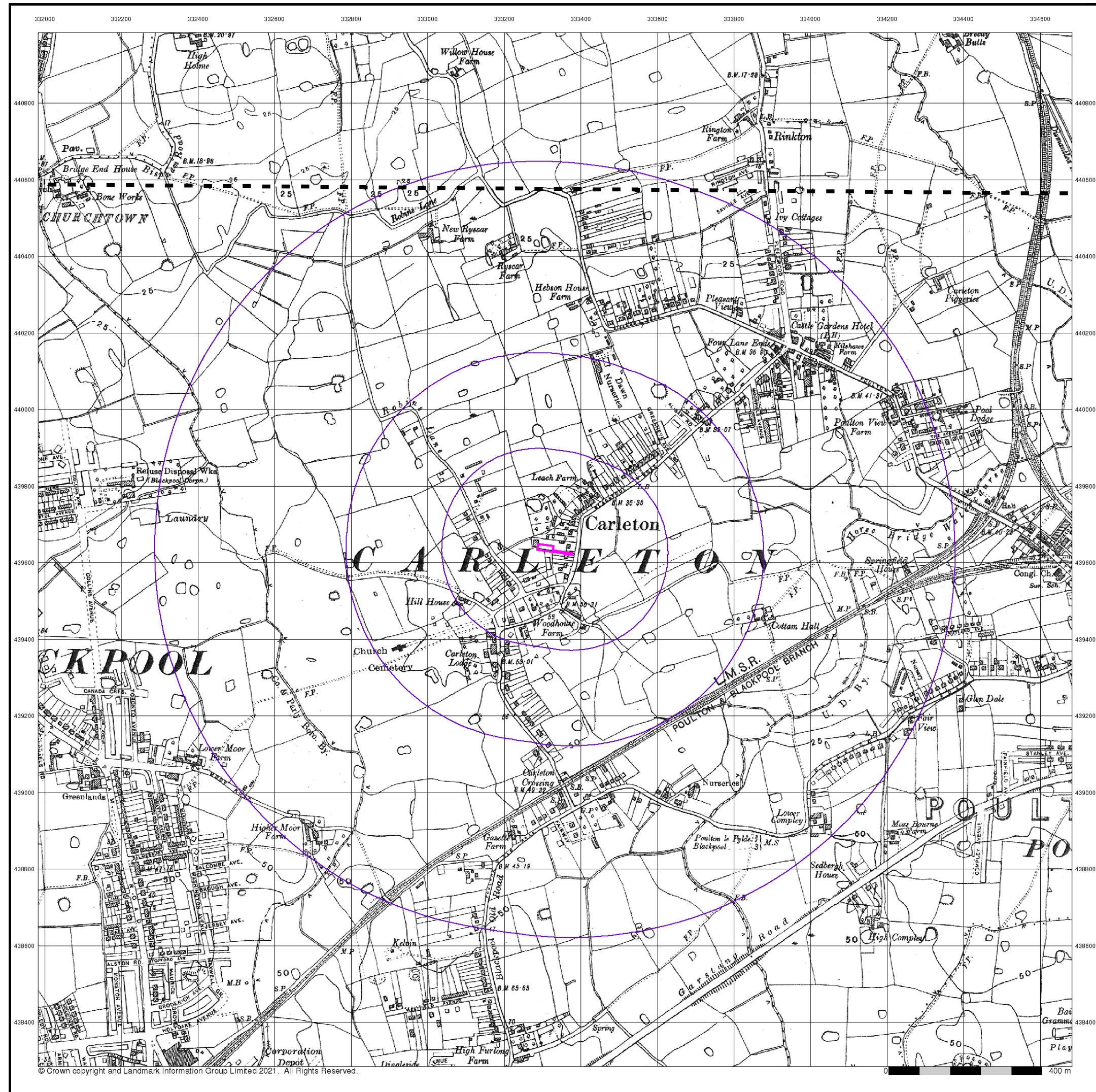

LK GROUP

Lancashire And Furness

Published 1938

Source map scale - 1:10,560

The historical maps shown were reproduced from maps predominantly held at the scale adopted for England, Wales and Scotland in the 1840's. In 1854 the 1:2,500 scale was adopted for mapping urban areas; these maps were used to update the 1:10,560 maps. The published date given therefore is often some years later than the surveyed date. Before 1938, all OS maps were based on the Cassini Projection, with independent surveys of a single county or group of counties, giving rise to significant inaccuracies in outlying areas. In the late 1940's, a Provisional Edition was produced, which updated the 1:10,560 mapping from a number of sources. The maps appear unfinished - with all military camps and other strategic sites removed. These maps were initially overprinted with the National Grid. In 1970, the first 1:10,000 maps were produced using the Transverse Mercator Projection. The revision process continued until recently, with new editions appearing every 10 years or so for urban areas.

Map Name(s) and Date(s)

043SW
1938
1:10,560
051NW
1938
1:10,560

Historical Map - Slice A

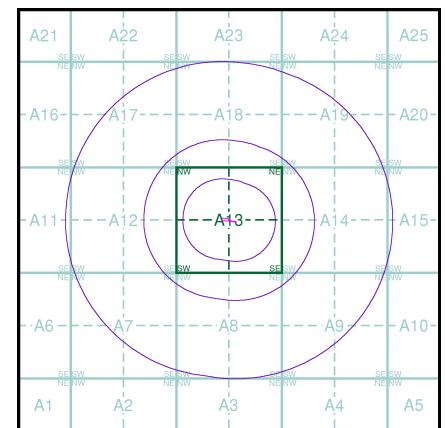

Order Details

Order Number:	272247102_1_1
Customer Ref:	LKC 20 1381
National Grid Reference:	333330, 439630
Slice:	A
Site Area (Ha):	0.08
Search Buffer (m):	1000

Site Details

157a Blackpool Road, Poulton-le-Fylde, FY6 7QH



Tel: 0844 844 9952
Fax: 0844 844 9951
Web: www.envirocheck.co.uk

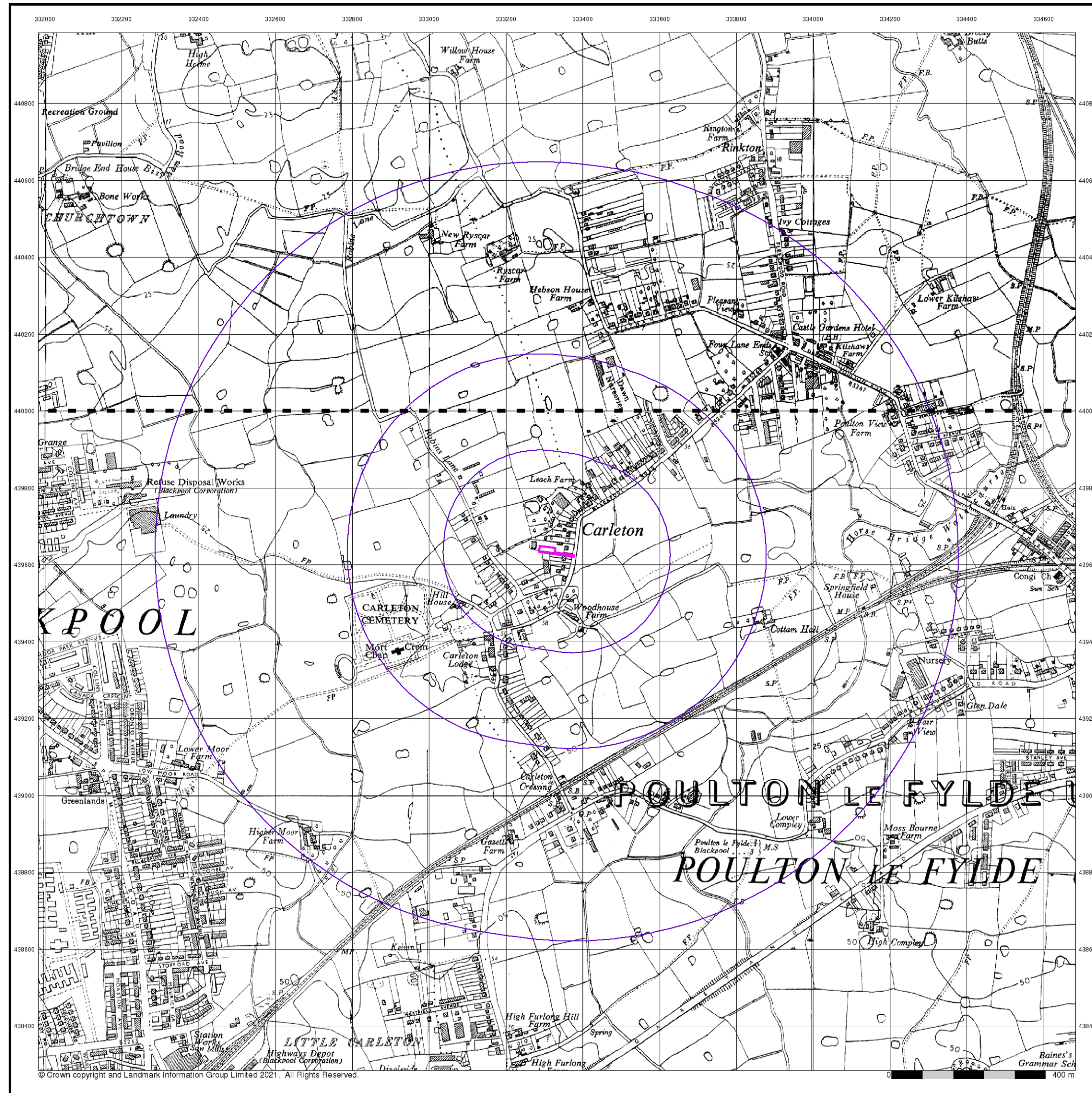

© Crown copyright and Landmark Information Group Limited 2021. All Rights Reserved.



Ordnance Survey Plan

Published 1955 - 1956

Source map scale - 1:10,000

The historical maps shown were reproduced from maps predominantly held at the scale adopted for England, Wales and Scotland in the 1840's. In 1854 the 1:2,500 scale was adopted for mapping urban areas; these maps were used to update the 1:10,560 maps. The published date given therefore is often some years later than the surveyed date. Before 1938, all OS maps were based on the Cassini Projection, with independent surveys of a single county or group of counties, giving rise to significant inaccuracies in outlying areas. In the late 1940's, a Provisional Edition was produced, which updated the 1:10,560 mapping from a number of sources. The maps appear unfinished - with all military camps and other strategic sites removed. These maps were initially overprinted with the National Grid. In 1970, the first 1:10,000 maps were produced using the Transverse Mercator Projection. The revision process continued until recently, with new editions appearing every 10 years or so for urban areas.

Map Name(s) and Date(s)

SD34SW	1955
SD33NW	1956

Historical Map - Slice A

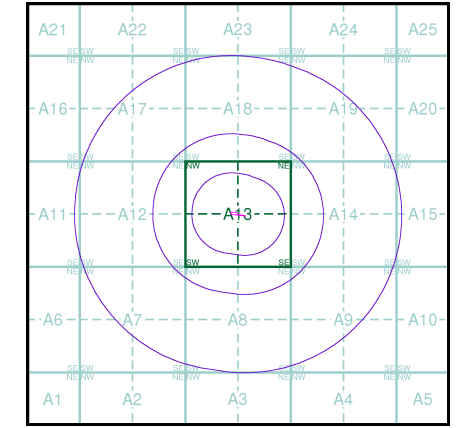

Order Details

Order Number:	272247102_1_1
Customer Ref:	LKC 20 1381
National Grid Reference:	333330, 439630
Slice:	A
Site Area (Ha):	0.08
Search Buffer (m):	1000

Site Details

157a Blackpool Road, Poulton-le-Fylde, FY6 7QH



Tel: 0844 844 9952
Fax: 0844 844 9951
Web: www.envirocheck.co.uk