

SITE OF APPLICATION

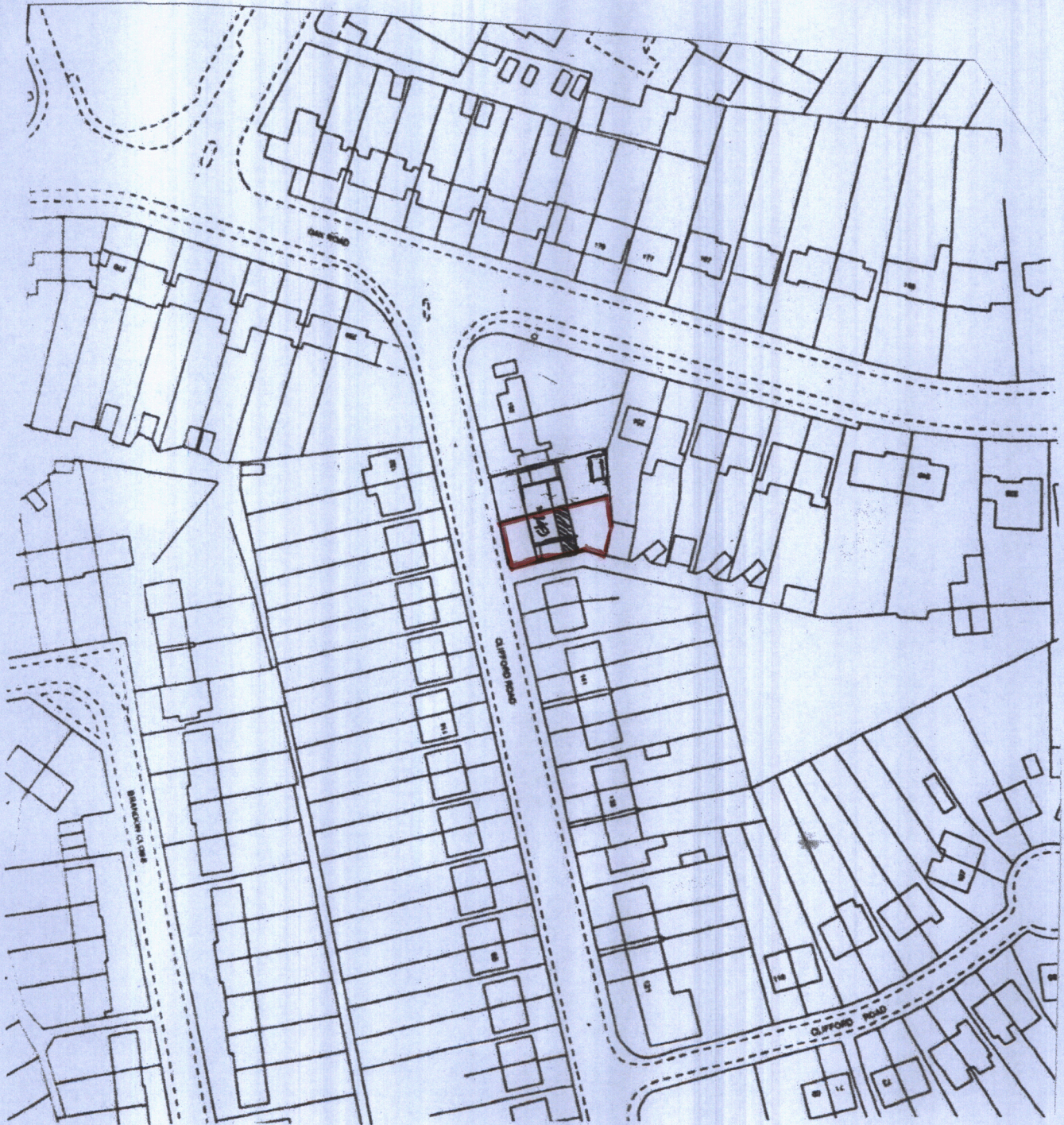

**LOCATION BLOCK PLAN**

( SCALE 1 : 1250 )

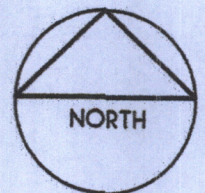

PROPOSED TWO STOREY  
EXTENSION  
AT 149 CLIFFORD ROAD  
WEST BROMWICH  
WEST MIDLANDS B70 8JS

FOR MRS. KASHMIRO KAUR

SCALE. 1 : 1250.

DRAWING NUMBER KK221 - 04.