

**THIS DRAWING MUST NOT BE USED FOR CONSTRUCTION PURPOSES**

Roof covering to consist cement tile and associated capping, verge/eaves details fixed in accordance with manufacturer's details for pitch and exposure as detailed on the drawings. Tiles to be fixed to a minimum 25 x 38mm treated timber batten or to manufacturer's directions and roof timbers to be overlaid with un-tearable breathable underslating to BS 747 or relevant BBA certificate.  
Roof to be formed from kiln-dried stress graded timbers sized, spacing, spans, bracing and fixings as detailed on the drawing. Bracing to BS 5268.  
Foil backed (vapour checked) 12.5mm plasterboard and skim ceiling finish.

Soffits, fascias and barge boards etc to match the existing UPVC to BS 4576, fixed in compliance with manufacturers details.

Fix 12.5mm foil backed plasterboard (joints staggered) and 3mm skim coat of finishing plaster to the underside of all ceilings using galvanized plasterboard nails.

Notches / holes / cuts in structural timbers should be carried out in accordance with BS 5268-22002 and should not be deeper than 0.125 times the depth of the joists and



should be not closer to the support than 0.07 times the span and not further away than 0.25 times the span. Holes should have a diameter not greater than 0.25 times the depth of joist and should be drilled at the joist centre line. They should be not less than 3 diameters (centre to centre) apart and should be located between 0.25 and 0.4 times the span from the support. Notches or holes exceeding the above requirements or cut into other structural members should be checked by a structural engineer.

**Roof restraint**  
Roof and walls to be provided with lateral restraint straps across at least 3 timbers as noted in wall section at ceiling, wall plate and verge levels with 30 x 5mm x 1m galvanized metal straps or other approved to BSEN 845-1 at maximum 2m centers.

**ALL TIMBER AND ROOF DESIGN TO BE APPROVED BY BUILDING CONTROL PRIOR TO WORKS COMMENCING.**

\*Should the pitch of the roof reduce to below 15 deg, then Marley Melodie Clay single interlocking pantiles to be used. Pitch not to go below 12.5deg. Only available in Natural red 90773. Minimum headlap 92mm, to be installed to manufacturers instructions.

**Notes:**

-  - Existing walls
-  - Proposed walls

**COPYRIGHT AND CONFIDENTIAL INFORMATION**  
The copyright of this confidential document and all information contained in it is owned by EB CAD Services. This document and all information in it are not to be made available to the public or to anyone else (whether in the United Kingdom or elsewhere), by written or oral description, or by use, or in any other way, unless by prior written authority from the copyright owner.  
The principle points of construction only are illustrated. Layout and dimensions are subject to confirmation and detailed design.

**U-Value**

# 0.18

W/m<sup>2</sup>K

0.18 ← → 0.20

**Kingspan Kooltherm K107 Pitched Roof Board**

[Click here to view construction build-up](#)

**Construction build-up includes:**

- 3mm skim coated Kingspan Kooltherm K118 Insulated Plasterboard fixed under rafters
- Kingspan Kooltherm K107 Pitched Roof Board partially filling space between rafters
- Ventilated airspace (minimum 50mm) above insulation
- Sarking felt
- Tile/slate batten
- Tile/Slates

[See website for more details](#)

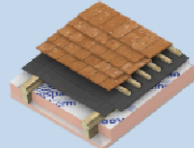

**Construction and Insulation for mono-pitch roof**

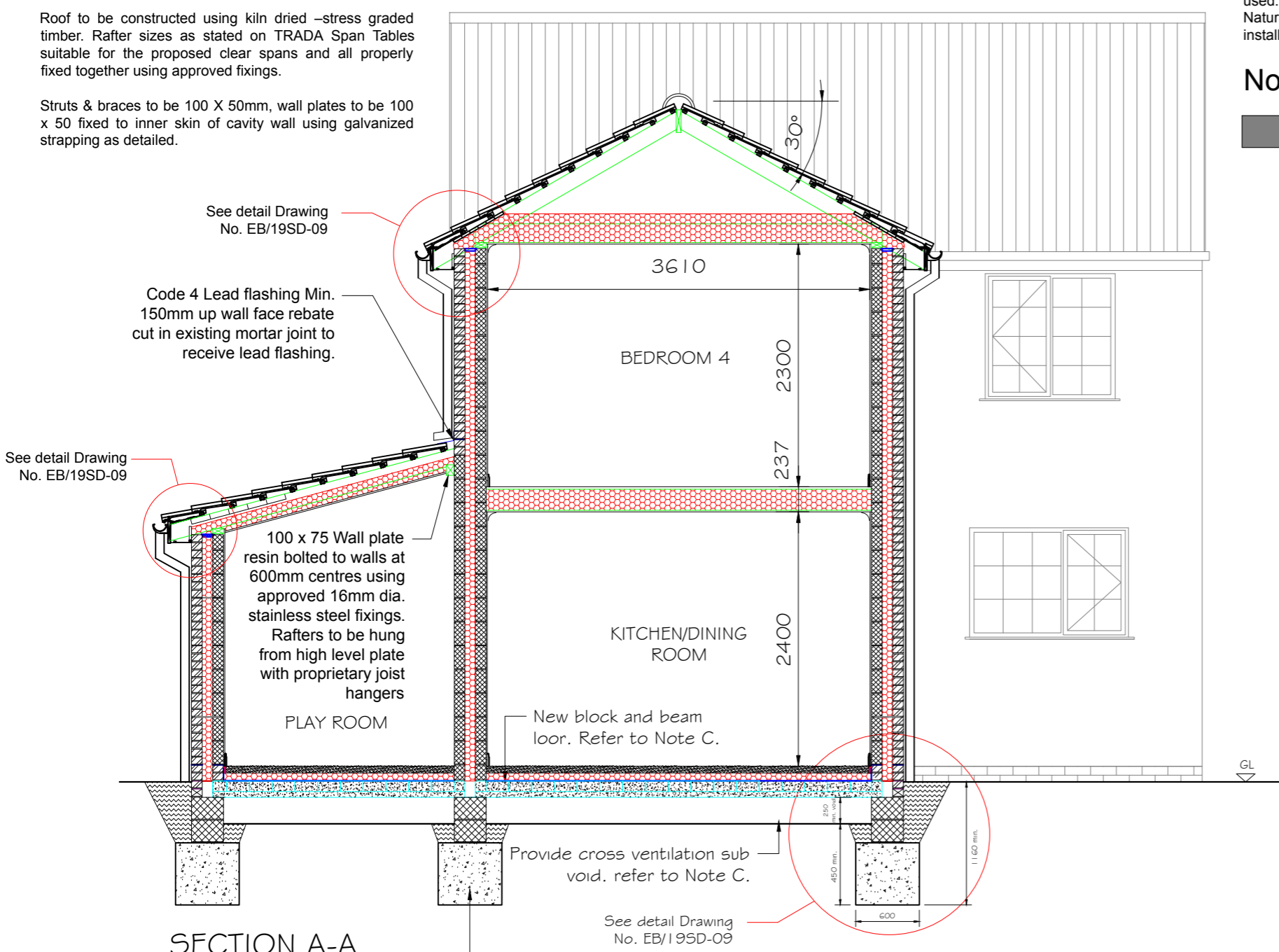

**SECTION A-A**

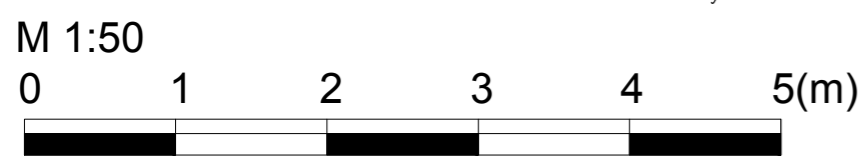

Foundations are to be provided centrally positioned under all exterior and interior load bearing walls, steps in foundation level should not exceed its thickness and should overlap by twice its thickness.

**Drawing status:**  
**BUILDING CONTROL**

Rev.	Description	By	Date
A			
B			
C			
D			
E			
F			
G			
H			

Drawn	Date	Name	<b>PROPOSED SIDE AND REAR EXTENSION</b> 19 SCHOOL DRIVE, NEWTON LONGVILLE MK17 0DD
Approved	Number	Initials	
EB CAD SERVICES 1 THE WILLOWS, EDLESBOROUGH, LU6 2JH Tel: 01525 220 510 www.ebcad.co.uk email: enquiries@ebcad.co.uk			
DWG TITLE:		SECTION A-A	Scale: (A3) 1:50
Drg./File No.		EB/19SD-07	Rev. -