

THIS DRAWING MUST NOT BE USED FOR CONSTRUCTION PURPOSES

COPYRIGHT AND CONFIDENTIAL INFORMATION
 The copyright of this confidential document and all information contained in it is owned by EB CAD Services. This document and all information in it are not to be made available to the public or to anyone else (whether in the United Kingdom or elsewhere), by written or oral description, or by use, or in any other way, unless by prior written authority from the copyright owner.
 The principle points of construction only are illustrated. Layout and dimensions are subject to confirmation and detailed design.

Supreme block and beam floor with 155mm deep beams at 520mm centres or similar proprietary product.

Block and Beam floor calculations to be supplied at a later date

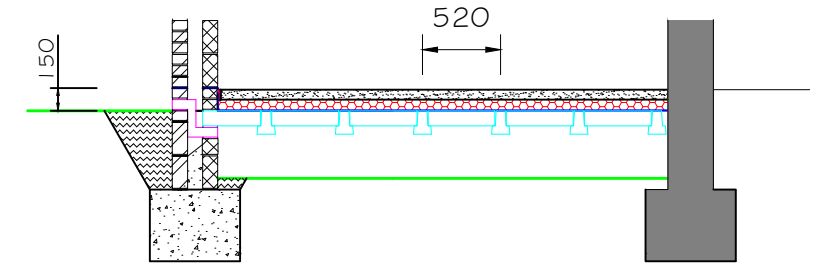

SECTION C-C

Telescopic void ventilator (VV) fitted with anti-rodent grill. To be spaced at no more than 2m centres and within 450mm of each end of the opposing wall

Supreme Suspended Beam and Block floor installed to manufacturers instructions:

- Max. Clear span : 4300mm
- Beam Centres : 520mm
- Structural Depth : 155mm

Calculations based on live load : 1.50kN/m²

Drawing status:
BUILDING CONTROL

Rev.	Description	By	Date
A			
B			
C			
D			
E			
F			
G			
H			

Drawn	Date	Name	PROPOSED SIDE AND REAR EXTENSION 19 SCHOOL DRIVE, NEWTON LONGVILLE MK17 0DD
	20.09.2018	EB	
Number		Initials	
Approved			
EB CAD SERVICES 1 THE WILLOWS, EDLESBOROUGH, LU6 2JH Tel: 01525 220 510 www.ebcad.co.uk email: enquiries@ebcad.co.uk			DWG TITLE: BLOCK & BEAM FLOOR PLAN Scale: (A3) 1:50
Drg./File No. EB/19SD-08			Rev. -

