

THIS DRAWING MUST NOT BE USED FOR CONSTRUCTION PURPOSES

**COPYRIGHT AND CONFIDENTIAL INFORMATION**  
 The copyright of this confidential document and all information contained in it is owned by EB CAD Services. This document and all information in it are not to be made available to the public or to anyone else (whether in the United Kingdom or elsewhere), by written or oral description, or by use, or in any other way, unless by prior written authority from the copyright owner.  
 The principle points of construction only are illustrated. Layout and dimensions are subject to confirmation and detailed design.

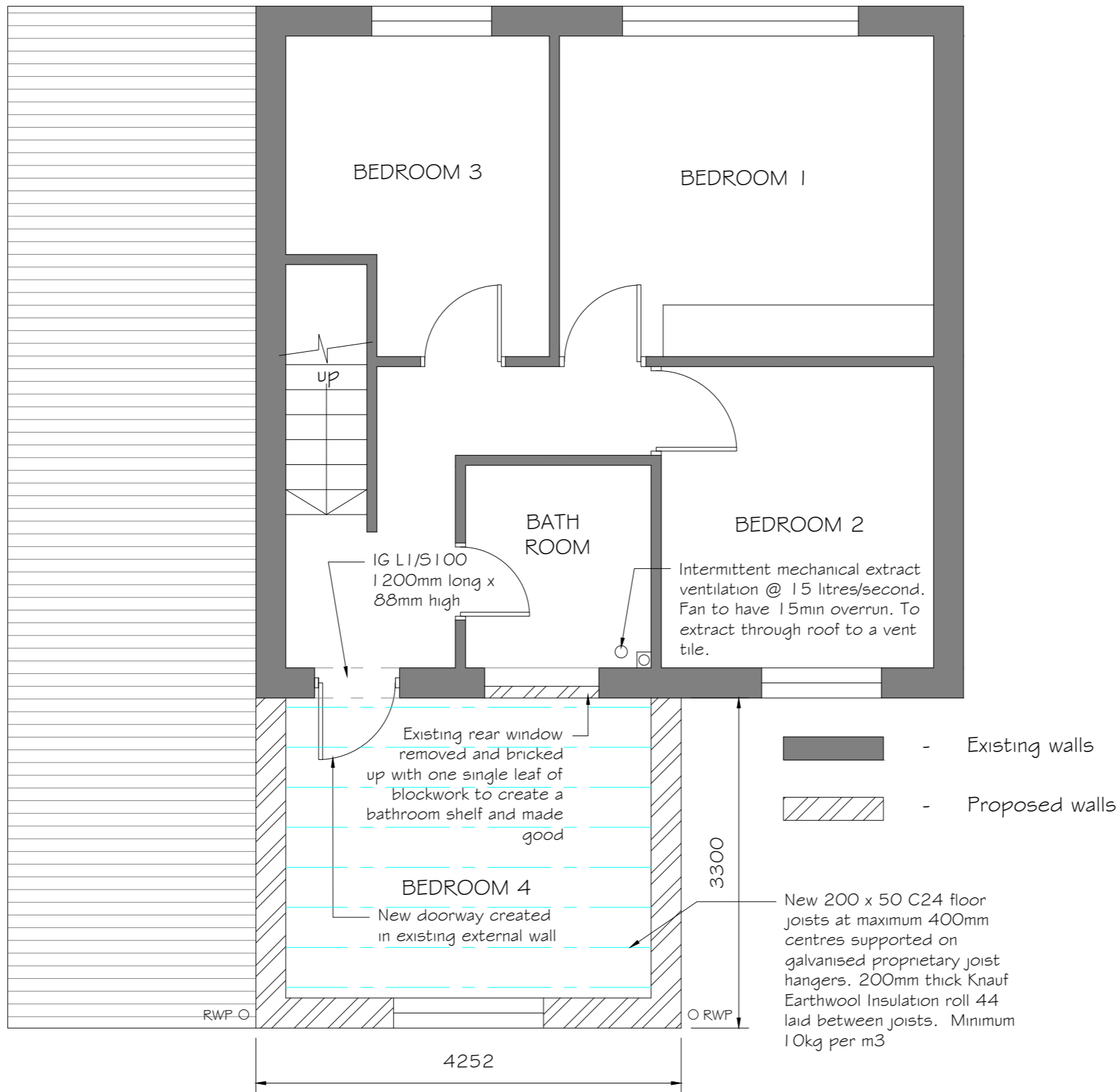

**Joist Notes:**  
 Joists imposed load not exceeding 1.5kN/m<sup>2</sup> and a dead load of no more than 0.25kN/m<sup>2</sup>. Calculated from TRADA load tables.

Joists supported from galvanised joist hangers to BS 6178 Part 1 1999. Restraint joist hangers to BS 5268:Part 1 installed at maximum 2000mm centres to provide lateral restraint.

Double joists under partitions, baths and showers to be mechanically fixed together using at least two bolted connections or at 1/3rd spacing, using 12mm diameter high tensile bolts & 3 x 50mm steel washers at each bolt end.

First and last joists fitted to leave a gap of 50mm from block work or timber frame.

All structural timber is to be grade C24, stress graded to BS 4978 and sawn to BS 4471. All timber is to be protected on site to minimize moisture content which must not exceed 22%.

**GENERAL NOTES:**

**CENTRAL HEATING:**  
 1 additional radiator to be installed by a competent person in accordance with the current issue of Gas Safety (installation and use) Regulations and to manufacturers recommendation. All new radiators to be fitted with TRVs.

**ELECTRICS:**  
 Design and installation of light fittings and switches to be in compliance with Part P demonstrated by issue of a BS 7671 Electrical Installation Certificate.

Provide light fittings (including lamp, control gear and an appropriate housing, reflector, shade or diffuser or other device for controlling the output light) that only take lamps having a luminous efficiency greater than 40 lumens per circuit watt or, fixed energy efficient light fittings that number not less than the greater of one per 25m<sup>2</sup> of dwelling floor area or part thereof or, one per four fixed light fittings. This assessment should be based on the extension only.

**HOT AND COLD WATER SUPPLY:**  
 Designed and installed to comply with The Building Regulations 2000 (2010 edition) Approved Document G

**SMOKE/HEAT ALARMS**  
 All floors to be provided with mains operated interconnected fire detection and fire alarm system to BS 5446 and installed in accordance with the relevant recommendations of BS 5839-6:2004 to at least Category D, LD3 standard. Self contained mains operated smoke alarms with battery back up to be fixed at ceiling level in all circulation areas at each story level, within 7.5m of all doors in habitable rooms.

**STRUCTURAL BEAMS, COLUMNS AND LINTELS:**  
 For structural elements please refer to attached Engineers drawing No. 295 SK-01

- Existing walls
- Proposed walls

PROPOSED FIRST FLOOR PLAN



Drawing status:  
**BUILDING CONTROL**

Rev.	Description	By	Date
A			
B			
C			
D			
E			
F			
G			
H			

Drawn	Date	Name	<b>PROPOSED SIDE AND REAR EXTENSION</b> 19 SCHOOL DRIVE, NEWTON LONGVILLE MK17 0DD
Approved	Number	Initials	
EB CAD SERVICES 1 THE WILLOWS, EDLESBOROUGH, LU6 2JH Tel: 01525 220 510 www.ebcad.co.uk email: enquiries@ebcad.co.uk			
DWG TITLE: PROPOSED FIRST FLOOR PLAN		Scale: (A3) 1:50	Drg./File No. EB/19SD-05