

**RECEIVED**

21/00271/FUL  
12.03.2021



**RE-STAMP**

14.04.2021



Bracknell  
Forest  
Council

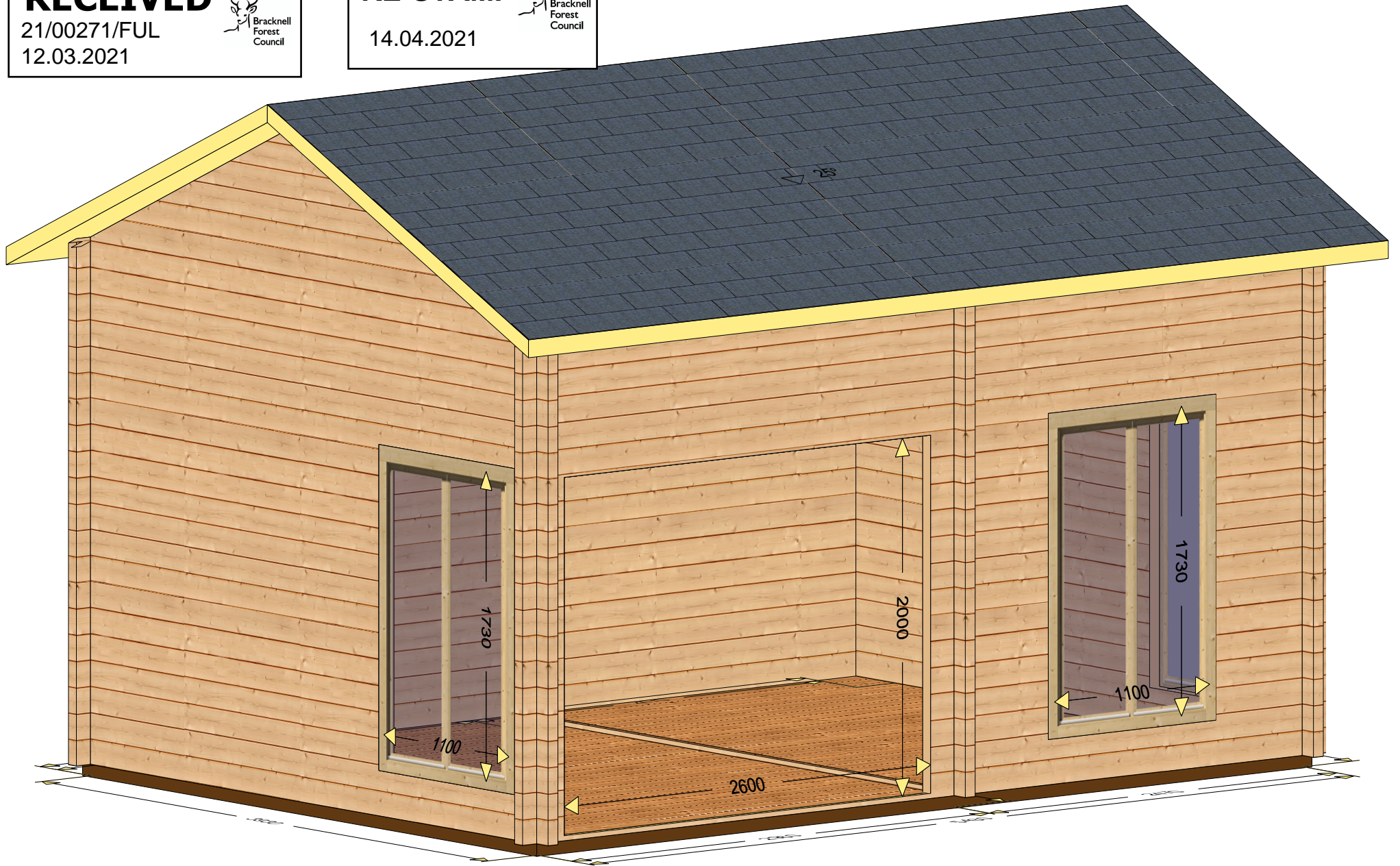

Request nr: 201125.1VF - Bespoke cabin 4x5.5

AS Lasita Maja  
Risu tee 2, Pihva küla  
61407 Tähtvere vald  
Tartumaa, Estonia  
[www.lasita.com](http://www.lasita.com)

**RECEIVED**

21/00271/FUL  
12.03.2021



**RE-STAMP**

14.04.2021

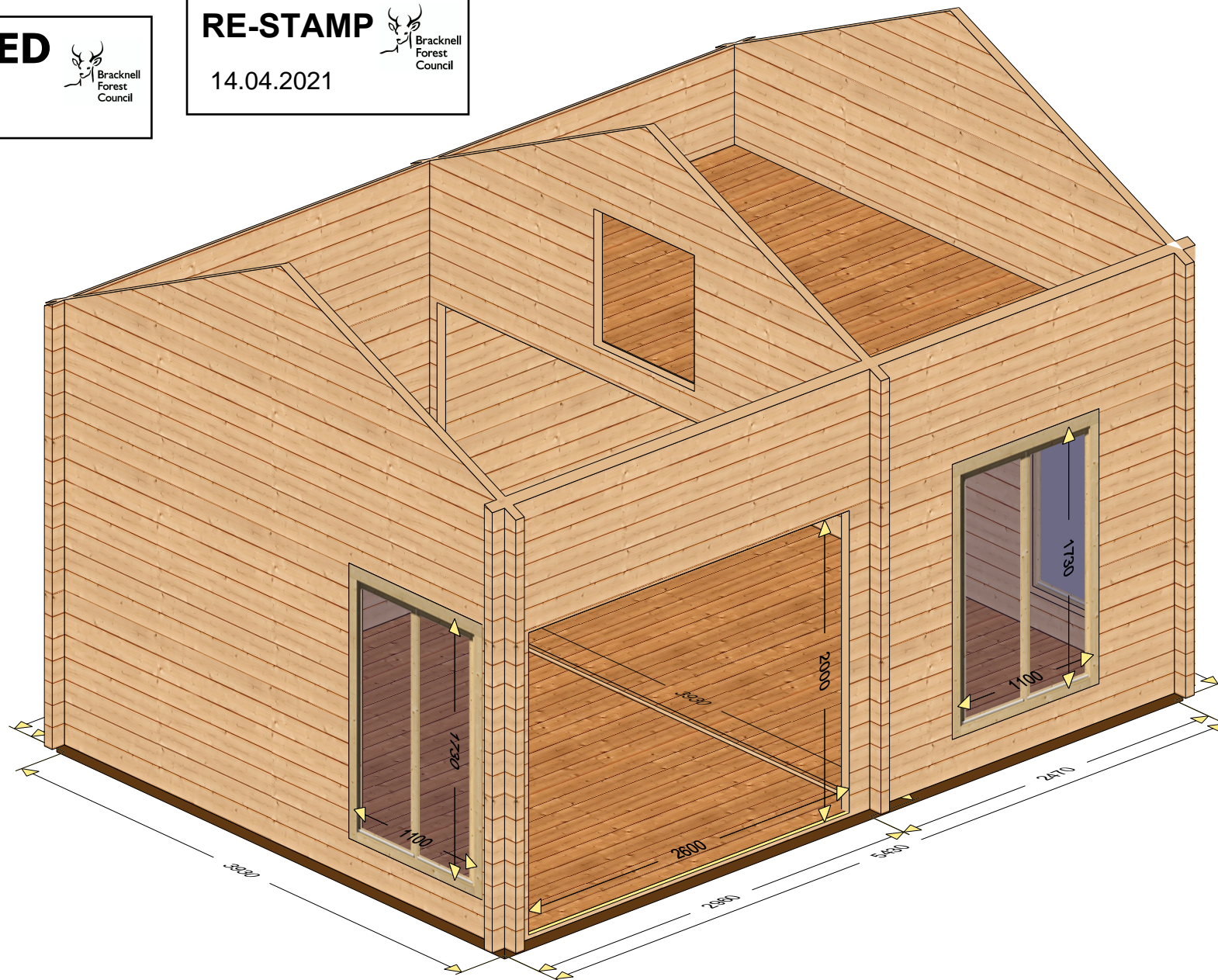

Request nr: 201125.1VF - Bespoke cabin 4x5.5

AS Lasita Maja  
Risu tee 2, Pihva küla  
61407 Tähtvere vald  
Tartumaa, Estonia  
[www.lasita.com](http://www.lasita.com)

**RE-STAMP**  
14.04.2021

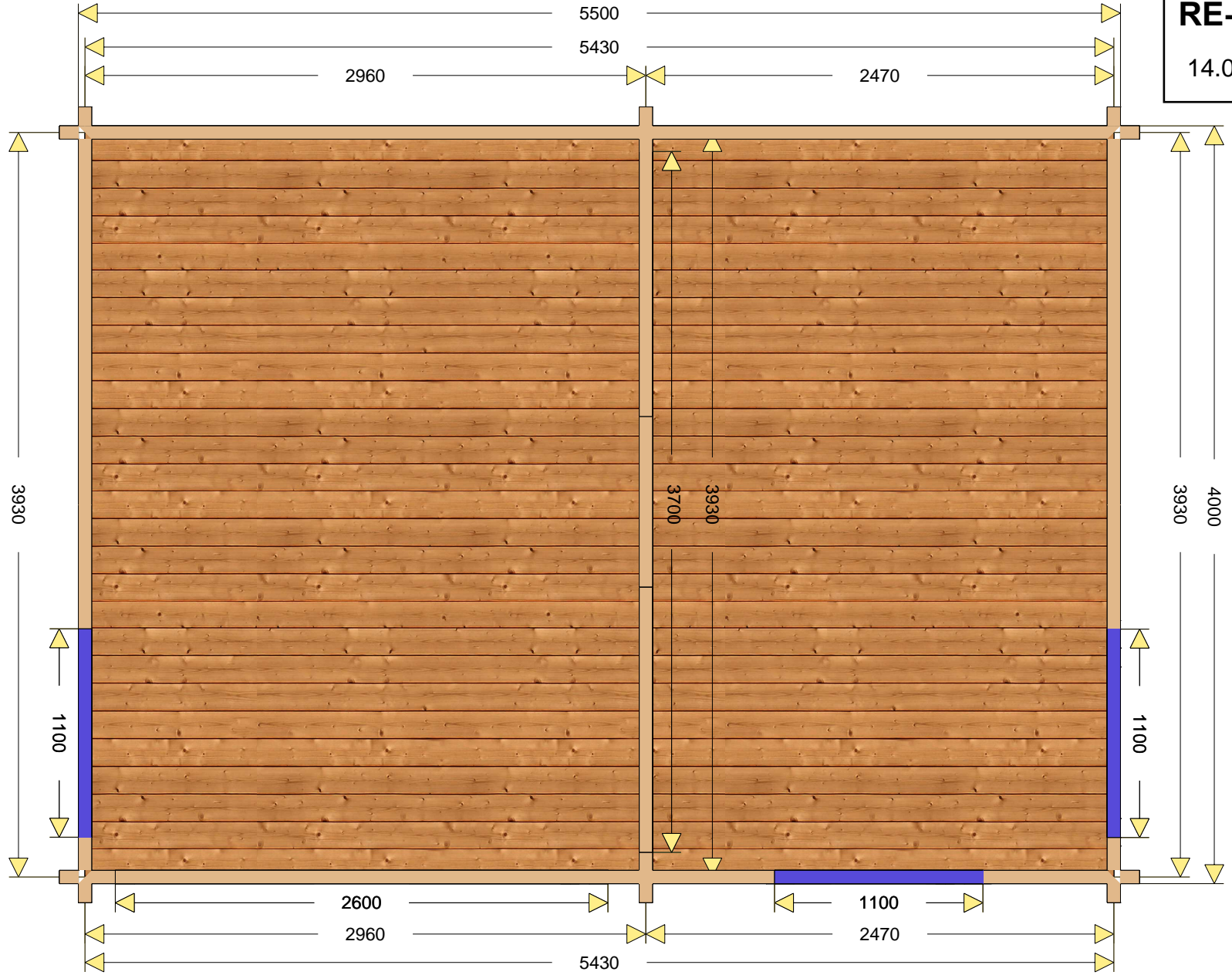

Request nr: 201125.1VF - Bespoke cabin 4x5.5

**RECEIVED**  
21/00271/FUL  
12.03.2021



AS Lasita Maja  
Risu tee 2, Pihva küla  
61407 Tähtvere vald  
Tartumaa, Estonia  
[www.lasita.com](http://www.lasita.com)

**RE-STAMP**  
14.04.2021



**RECEIVED**  
21/00271/FUL  
12.03.2021



Request nr: 201125.1VF - Bespoke cabin 4x5.5

AS Lasita Maja  
Risu tee 2, Pihva küla  
61407 Tähtvere vald  
Tartumaa, Estonia  
[www.lasita.com](http://www.lasita.com)