

Key:

- Existing construction
- Proposed construction
- Demolished

General Notes:
Ceilings: To remain as currently configured
Internal Doors: Where these have been vandalised or removed, doors to be repaired or reinstated with 4 panel doors similar to late 18th / early 19th Century Pattern
Windows: Windows to be altered or replaced. Consider introduction of interior timber folding shutters to supplement curtains or blinds and reduce heat loss.
Repairs to Plasterwork: To be lime based, similar to or compatible with existing haired plasters with lime skin in-situ

Revised Bathroom Layout, with new studwork partition walls, and formation of linen cupboard
 Linen Cupboard installed including HWT and plant for west wing services
 Repair of fireplace to reinstate pre 2002 arrangement with position of slate slab hearth retained. New chimney flue to be formed above fireplace and enclosing second west bay of roof timbers

Hipped roof with lead covered roll
 Slate roof finish
 Slate roof to cover lower half of outshut roof. Other half to be covered by existing thatch roof.

Northern window reinstated including adaptation to lean to roof above north outshut.

Note: ** Denotes joist direction taken to be east-west. Suggesting the existing 20C floorboards overlay earlier floor finish or joists replaced

Bathroom 1 to be refitted
 New hot water cylinder to be installed within existing cupboard

Note: * Denotes joist direction taken to be north-south (as visible in Kitchen below Bedroom 1). Suggesting the existing 20C floorboards overlay earlier floor finish or joists replaced

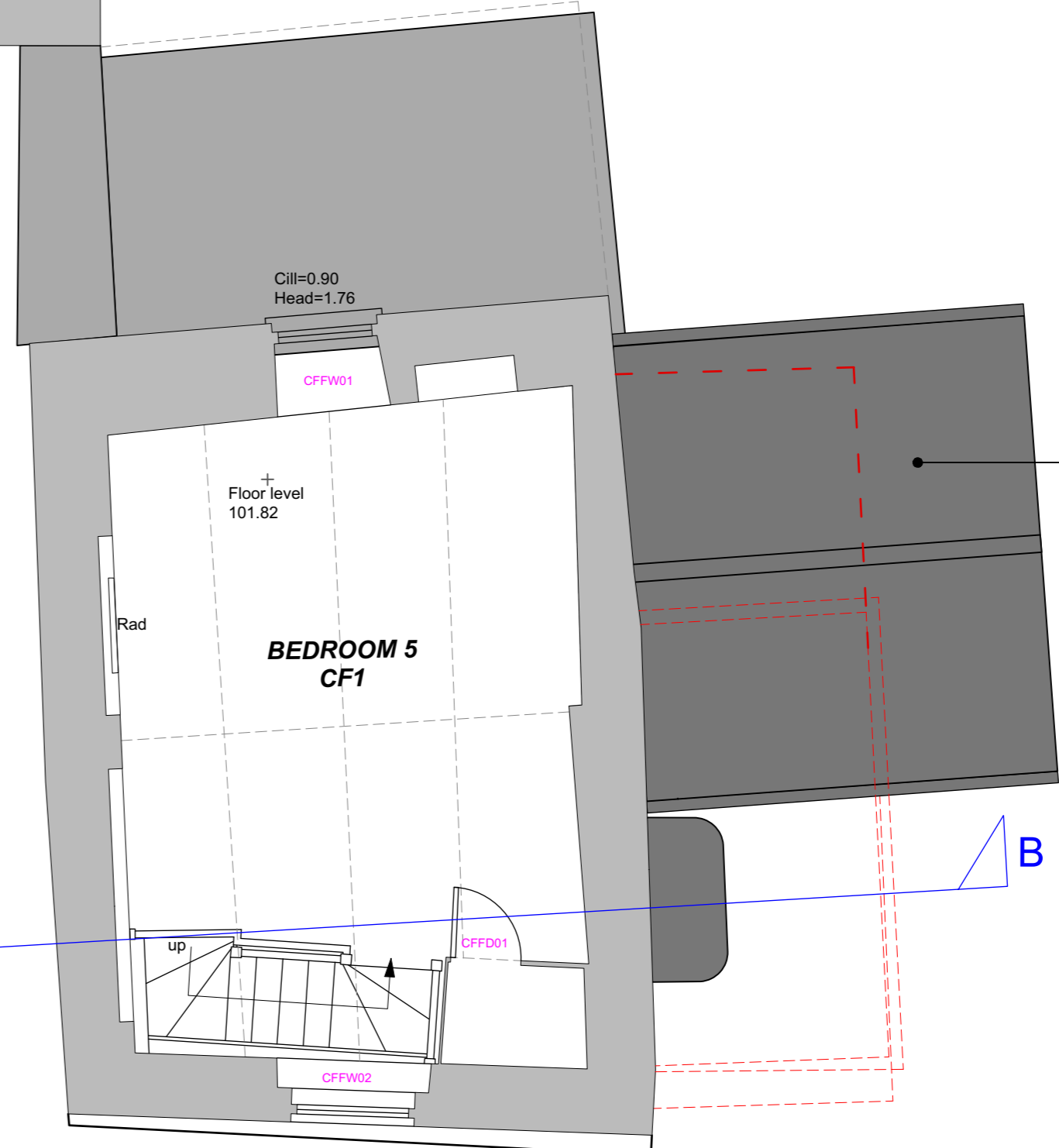

Roof of proposed oak framed extension to be covered using natural slate.

Proposed First Floor Plan
 1:50@A1, 1:100@A3

B

B

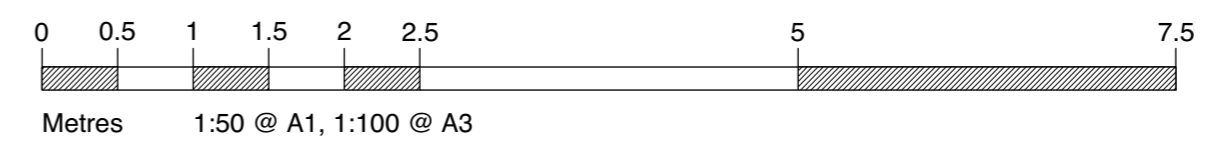

B - 22.12.20 - FFD08 remains as existing. Alterations to outshut roof finish - NW
 REVISIONS A - 08.12.20 - Roof finish modified to slate, hip roof introduced with lead covered roll - NW

TITLE 1967.0 Great Barton, Clyst St Lawrence
 DRAWING Proposed First Floor Plan
 NUMBER & REVISION 1967.0/303 B
 DATE July 2020
 SCALE 1:50 @ A1, 1:100 @ A3
 DRAWN CA

THE POTATO STORE QUEENSGATE HOUSE
 WITHYCOMBE 48 QUEEN STREET
 MINEHEAD EXETER
 SOMERSET DEVON
 TA24 6QB EX4 3SR
 T: 01984 640988 T: 01392 260490

design@larchitects.co.uk www.larchitects.co.uk
LOUISECROSSMAN ARCHITECTS

The contractor is to check all site dimensions and levels before commencing work to his/her own satisfaction. Do not scale from drawings other than for purposes of the Town and Country Planning Act. The information on the drawing must be read in conjunction with, and checked against, all other relevant drawings, reports and specifications. The contractor is to ensure that all work is carried out in accordance with the relevant Building Regulations and other applicable legislation. The copyright in this drawing belongs to Louise Crossman Architects. It may not be copied, reproduced or issued without the written agreement of Louise Crossman Architects. Registered in England and Wales Co No: 5762972. Registered Office: The Potato Store, Court Place, Withycombe, Minehead, Somerset TA24 6QB.