

General Notes

1. Dimensions are in millimetres unless stated otherwise.
2. Levels are in metres AOD unless stated otherwise.
3. Dimensions govern. Do not scale off drawing.
4. All dimensions to be verified on site before proceeding.
5. All discrepancies to be notified in writing to BAL Architecture Ltd.

©BAL Architecture Ltd 2020

Notes:

- This drawing is based upon the latest available OS and site survey data compiled and verified by others.
- The party wall and site boundary condition with No.1 Crimscott Street is shown indicatively and is subject to a party wall agreement including detailed site survey to be carried out prior to any construction work commencing.

REV	Date	Reason For Issue	Chk
00	08/06/2020	For Planning	

Planning
DRAWING STATUS

BAL
 Architecture
 www.balarchitecture.com

Client
Almero Crimscott II Ltd

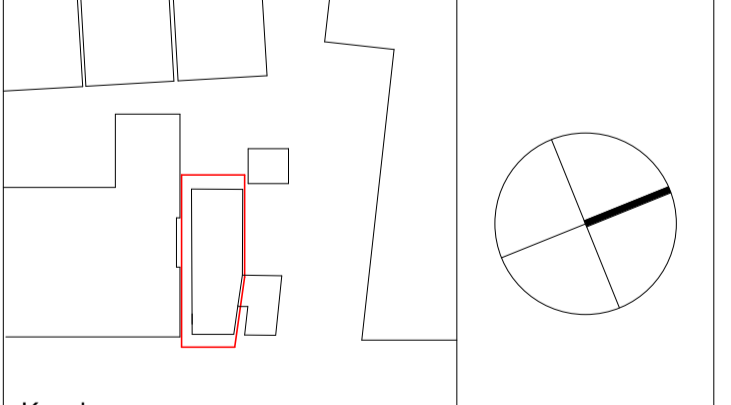

Project
2 Crimscott Street

Drawing Title
**Basement Plan
Proposed**

Scale at A1 1 : 50	Date 08/06/2020
Project No. 007	Rev No. 00
Drawing No. P1999	

