

This copy has been made by or with the authority of Midlothian Council pursuant to Section 47 of the Designs and Patents Act 1988. Unless that Act provides a relevant exception to copyright, the copy must not be copied without the prior permission of the copyright owner.



ROOF SPEC.
SEE ROOF SECTION
DETAILS.

GARAGE ROOF:
CONC. ROOF TILES TO MATCH
EXISTING. ON BATTENS &
COUNTER BATTENS ON
UNDERSLATING FELT ON
12mm FLY SHEETING ON
SIZ BUILT TRUSSES AT MAX
400 CRS.
SEE ROOF LAYOUT PLAN.

GRADE 4 LEAD FLASHING,
RAGGED INTO EX WALL
ROOF COVERING DRESSED UP
WALL MIN 150mm

ROOF LANTERN LEFT OUT
FOR CLARITY.

NEW SVT

NO 6 LEAD UPVC GUTTERS

BI-FOLD DOORS.

FLOOR SPEC -
SEE FOUNDATION DECA

WEAK MIX CONC. TO
CAVITY TO P.C.L.

GARAGE WALLS,
100mm 7N BLOCK WITH
19mm RENDER TO MATCH
EXISTING.

FOR FLOOR CONSTRUCTION
AND FOUNDATIONS SEE
FOUNDATION PLAN.

DPC MIN 150
ABOVE FFL.

DPM / GAS MEMBRANE TO
OVER LAP & BE SEALED AS
MANUFACTURERS DETAILS

SECTION THRO EXTENSION

SECTION THRO GARAGE EXTENSION

KEY TO MATERIALS :-	
1	Visqueen Zedex CPT DPC.
2	Visqueen GR DPC.
3	Visqueen Gas Barrier.
4	Visqueen Double Sided Tape (10m x 50mm).
5	Visqueen Gas Resistant Foil Tape.
6	Rigid Insulation by others to support gas DPC.

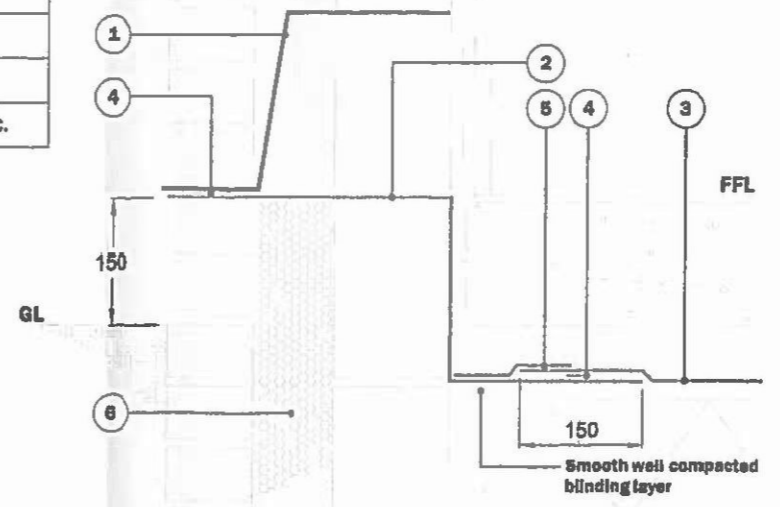
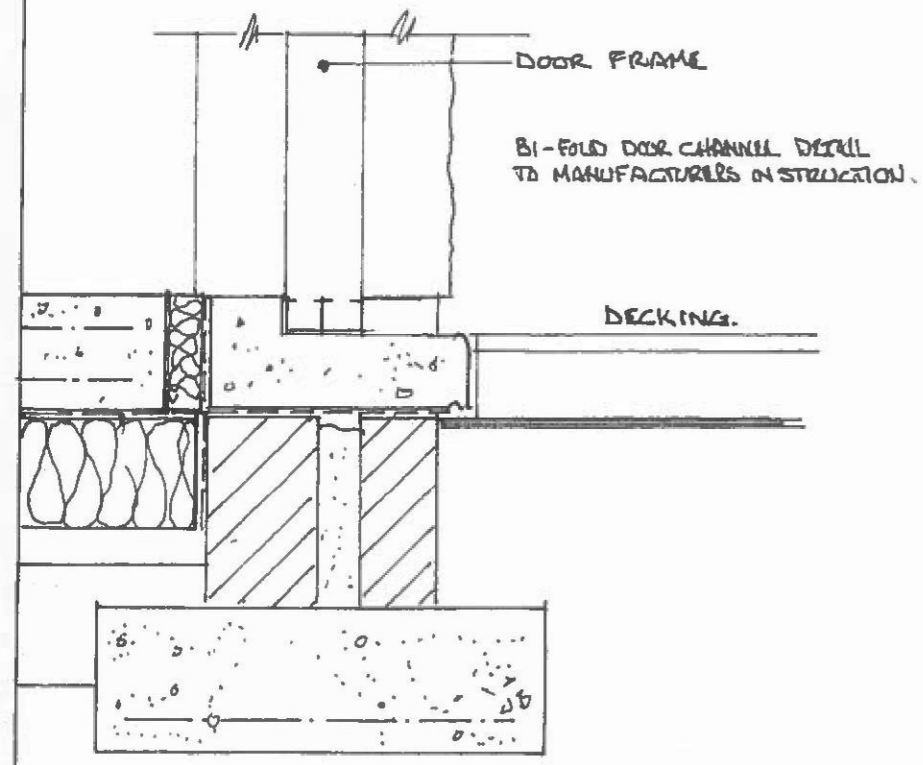

© Copyright reserved. This drawing may not be reproduced or amended without prior written permission.

Drawn for Guidance Only. Designer's Approval Required.

The construction sequencing should be assessed before the appropriate Visqueen Standard Detail is selected & approved by the Designer.

In order to develop a robust design for preventing a structure against groundwater, a Risk Assessment must be carried out in line with the guidance given in BS8102:2009.

The Designer may need to specify one or a combination of waterproofing measures.

All Visqueen materials must be installed in order compliance with the manufacturer's instructions. Refer to the current Visqueen data sheets.

Do Not Scale - Use Pictured Dimensions Only.

Standard Detail



www.visqueen.com

Scale : NTS
Date : Dec.2018
Drawing No : GB-21

THRESHOLD DETAILS 1:10



Typical Edge Detail - Ground Bearing Slab.

JAMES BROWN
ARCHITECTURAL SERVICES
47 Polton Street
Bonnyrigg
Midlothian EH19 3DD
Telephone : 0181 680 5548
E-mail : james.brown@jbcutlook.com

MR. D. GALLAGHER

11 REDCROFT ROAD
DANDERHALL.

SECTIONS + DETAILS

E=50 + 1:10

MARCH 21.

2102/06