



The interior of the Chapel looking west. The poppy head bench ends are an important part of the nineteenth century furniture. The perimeter benches are modern.



The North Porch almshouse entrance. The stonework condition is poor and the entrance poorly defined. Cement mortars are also present.



The North wall of the Chapel. The 'signposting' of the North Porch entrance is poor.

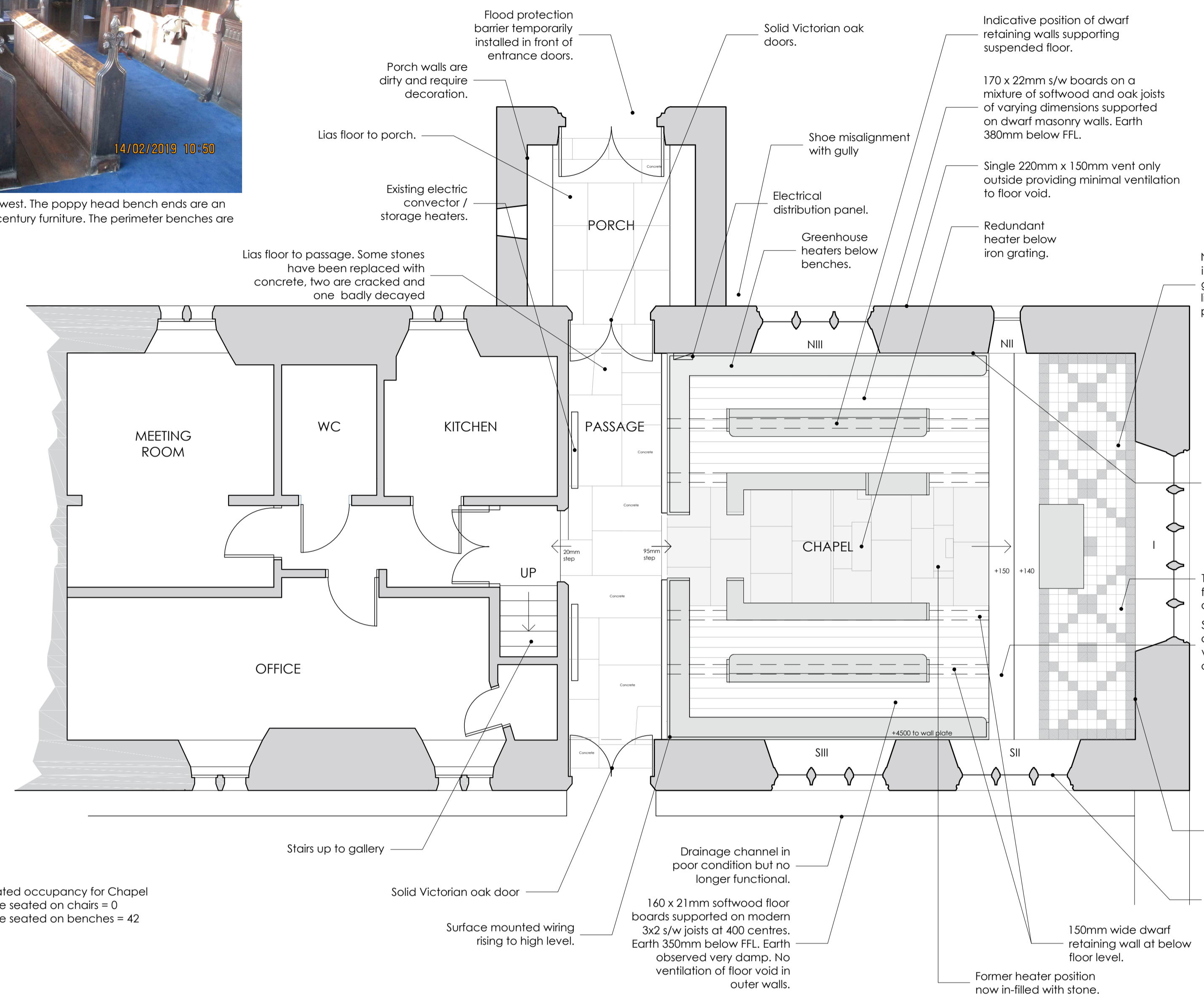

Estimated occupancy for Chapel  
 People seated on chairs = 0  
 People seated on benches = 42



The East Wall of the Chapel. Open joints in the copings are causing water to flow into the wall. High ground levels are the cause of plaster problems internally.



The South Wall of the Chapel. Cement pointing should be removed and ideally the wall should be repointed. The ground gutter in front requires repair.



The passage with medieval screen. The floor is a combination of stone and concrete.



The existing benches and carpeted floor over a combination of a stone and suspended timber floor. There is no cross ventilation.



The medieval glass in window NIII. The window has been the subject to a specialist conservation report prepared by Holywell Glass.



The doors in the screen. The benches have been secured to the screen.



The Chapel looking out from the Gallery. An infrared heater hangs from the ceiling.



The carpet pulled back in the central aisle revealing a worn but not archaeologically significant limestone floor. The good quality priests stall is on the north side.



Decay to Sanctuary panelling in part caused by high ground levels outside.



The Chapel interior looking west with the medieval curtain covered screen in front and the modern timber balustrade behind. A further modern screen at gallery level further sub-divides the original space.