

© This drawing is copyright.
 It is sent to you in confidence and must not be reproduced or disclosed to third parties without our prior permission.
 Do not scale from this drawing, other than for Local Authority Planning purposes.
 This drawing is to be read in conjunction with all relevant consultants, specialist manufacturers drawings and specifications.
 Any discrepancies in dimensions or details on or between these drawings should be drawn to our attention.
 All dimensions are in millimetres unless noted otherwise.

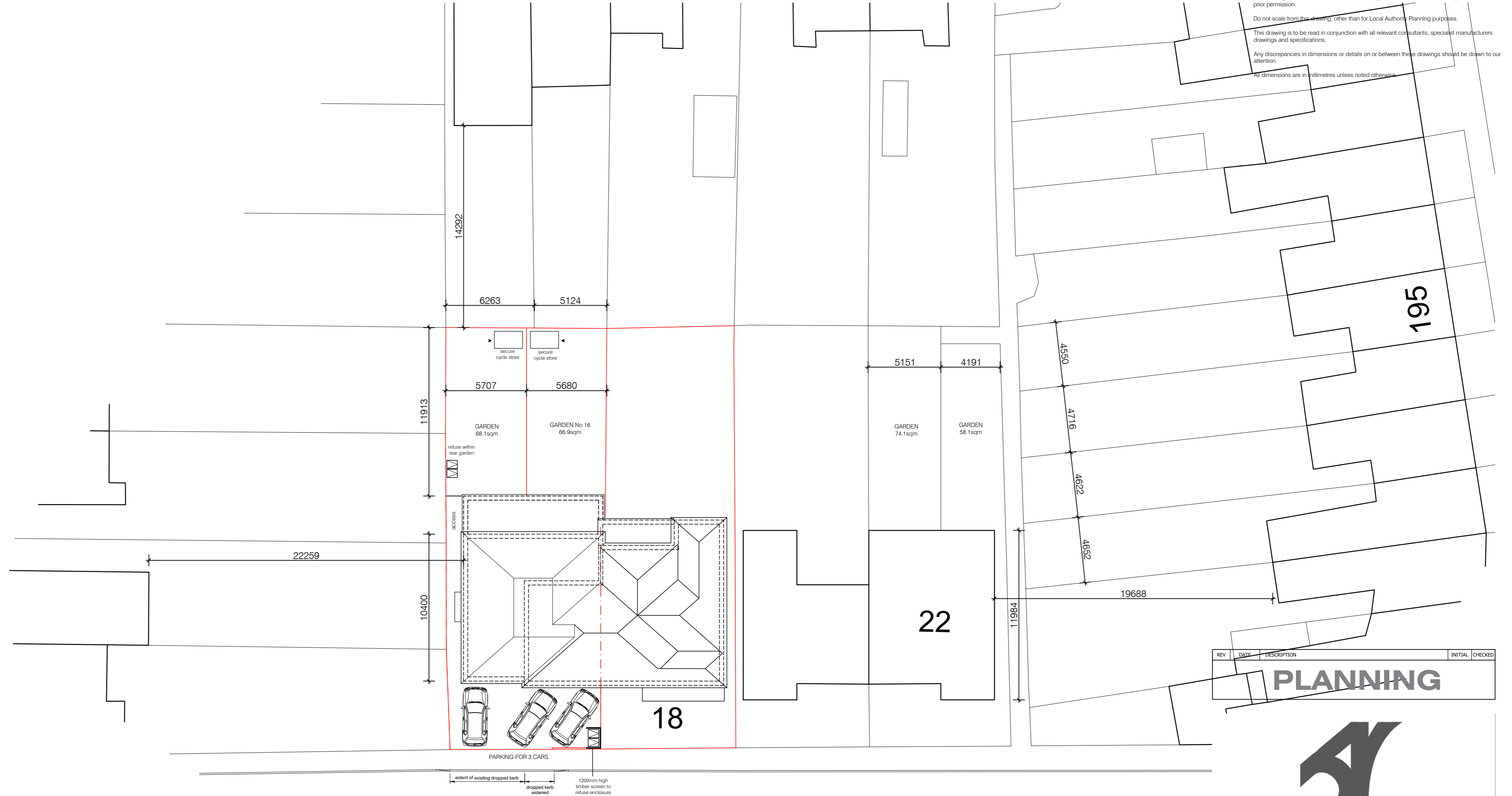

OMEGA ROAD

REV	DATE	DESCRIPTION	INITIAL	CHECKED
PLANNING				



harding rose architects

CLIENT	Mr Muhammad Riaz		
PROJECT	16 Omega Road, Woking, GU21 5DZ		
TITLE	Proposed Site Plan		
SCALE	1:200 @A2	DATE	09.07.20
DRAWN	JC	PROJECT NO.	19.794
			S.10

