



Materials Schedule Key

- BRICKS**
- B1.0 Brick – Buff variegated brick – Stretcher bond, light grey colour mortar
 - B1.1 Brick – Buff variegated brick – Recessed soldier bond, light grey colour mortar
 - B2.0 Brick – Brown variegated brick – Stretcher bond, light grey colour mortar
 - B2.1 Brick – Brown variegated brick – Recessed soldier bond, light grey colour mortar
 - B3.0 Brick – Red/blue variegated brick – Stretcher bond, light grey colour mortar
 - B3.1 Brick – Red/blue variegated brick – Recessed soldier bond, light grey colour mortar
 - B4.0 Brick – Grey/purple variegated brick – Stretcher bond, light grey colour mortar
 - B4.1 Brick – Grey/purple variegated brick – Recessed soldier bond, light grey colour mortar
 - B4.2 Brick – Grey/purple variegated brick – Soldier bond, light grey colour mortar
 - B5.0 Brick – Striped brick – Grey/purple and Red/blue variegated brick alternate every 2 coursing – Stretcher bond, light grey colour mortar
 - B5.1 Brick – Striped brick – Buff and Red/blue variegated brick alternate every other coursing – Stretcher bond, light grey colour mortar
 - B6.0 Feature Brick – Red/blue variegated brick with randomized red glazed brick – Soldier bond, light grey colour mortar
 - B7.0 Glazed Brick – Colour to match apartment block colour* - Stretcher bond, light grey colour mortar

- EXTERNAL WALL FINISH**
- F1.0 Wall finish – Render - Light grey

- EXTERNAL DOORS**
- D1.0 Communal entrance door – Glazed door with curtain walling - Colour to match apartment block colour*
 - D2.0 Balcony door – Glazed door with fixed sidelight panel - Light grey colour
 - D2.1 Balcony door – Single glazed door - Light grey colour
 - D2.2 Balcony door – Glazed door with fixed sidelight panel and louvres - Light grey colour
 - D3.0 Louvre doors – Double doors for refuse/cycle stores with ventilation louvres - Dark grey colour
 - D4.0 Single door – Dark grey colour

- BALCONIES**
- A1.0 Balcony – PPC Contemporary flat metal railing with metal fascia and soffit - Light grey colour
 - A1.1 Balcony – PPC contemporary perforated metal panel balustrading with metal fascia and soffit - Light grey colour
 - A1.2 Balcony – PPC contemporary solid metal panel balustrading with metal fascia and soffit - Balustrading, fascia and soffit colour to match apartment block colour*
 - A2.0 Balcony – Brick upstand wall with PPC contemporary flat metal railing and soffit – Brick upstand colour to match adjacent brick colour. Balcony railing and soffit colour in light grey colour
 - A2.1 Balcony – Brick upstand wall with PPC contemporary perforated metal panel balustrading and soffit - Brick upstand colour to match adjacent brick colour. Balcony railing and soffit colour in light grey colour

Notes:
Do not scale. All dimensions are in millimetres unless otherwise stated. This drawing should be read in conjunction with all relevant project information and contract documentation. All dimensions to be checked prior to fabrication and or commencement of works. All works to comply with all relevant legal standards, building regulations and warranty provider requirements. Report any discrepancies, if in doubt ask.

Rev	Status	Date	Description	Drm	Chkd
C01	A3	15.04.21	Planning Issue	TC	AA

Materials Schedule Key Continued

- WINDOWS**
- W1.0 Openable window – Single openable window - Light grey colour
 - W1.1 Openable window – Single openable window with attenuation louvres - Light grey colour
 - W2.0 Openable window – Single openable window with side fixed glazing - Light grey colour
 - W2.1 Openable window – Single openable window with side fixed glazing and attenuation louvres - Light grey colour
 - W3.0 Openable window – Double openable window - Light grey colour
 - W3.1 Openable window – Double openable window with attenuation louvres - Light grey colour
 - W4.0 Openable window – Double openable window with central fixed panel - Light grey colour

- W4.1 Openable window – Double openable window with central fixed panel and attenuation louvres - Light grey colour
- W5.0 Fixed curtain walling - Frame colour to match apartment block and house colour*
- W6.0 Louvred window – Single ventilated louvre window - Light grey colour
- W6.1 Louvred windows – Single, frosted, fixed window with ventilated louvres above - Light grey colour

- RAILINGS**
- R1.0 Balcony metal screen – PPC contemporary perforated screen, full height - Light grey colour

- SUNDRIES**
- T1.0 Concrete roof tiles – Dark grey
 - T2.0 Pressed metal capping – Dark grey
 - T3.0 Metal RWP/Hoppers/Gutters – Dark grey
 - T4.0 Canopy – PPC Folded Metal - Light grey
 - T5.0 Dry Riser Inlet
 - T6.0 Roof Services (Roof Overrun, AOV, etc)
 - T7.0 Photovoltaic (PV) panels and Air Source Heat Pumps (ASHP) units. Numbers shown and location are indicative
 - T8.0 Finished concrete to exposed structural columns

- NOTES**
- Apartment Blocks and House Terraces to have dedicated colour: Block A – Blue, Block B – Yellow, Block C – Blue Green, Block D – Green, Block E – Red and House Terraces – Dark Grey - please refer to Design & Access Statement
 - Front door colour for houses to vary - please refer to Design & Access Statement
 - Engineering, frost resistant bricks proposed above damp proof course (approx up to 300mm) on all external brickwork walls. Colours to match brickwork above

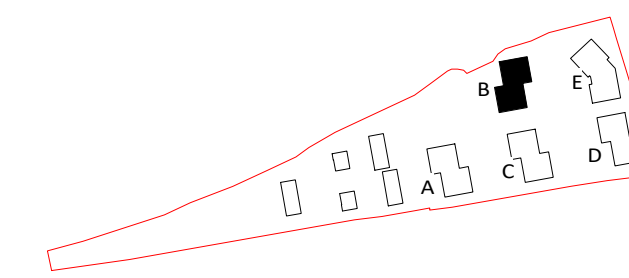

Key Plan

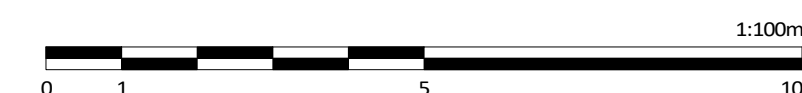

Client Name: **Sempra Homes**

Project Name: **Chapel Gate**

Drawing Name: **Block B Elevation - East**

Drawing Number: **CPK-BPTW-11-ZZ-DR-A-2021** Rev: **C01** Status: **A3**

Project No: **20-173** RIBA Stage: **3** Drawn By: **TC** Scale: **1:100 @ A2**

PLANNING ISSUE

40 Norman Road,
Greenwich, London
SE10 9QX
t. 020 8293 5175
bptw.co.uk