

EXISTING SITE LAYOUT (1:200)

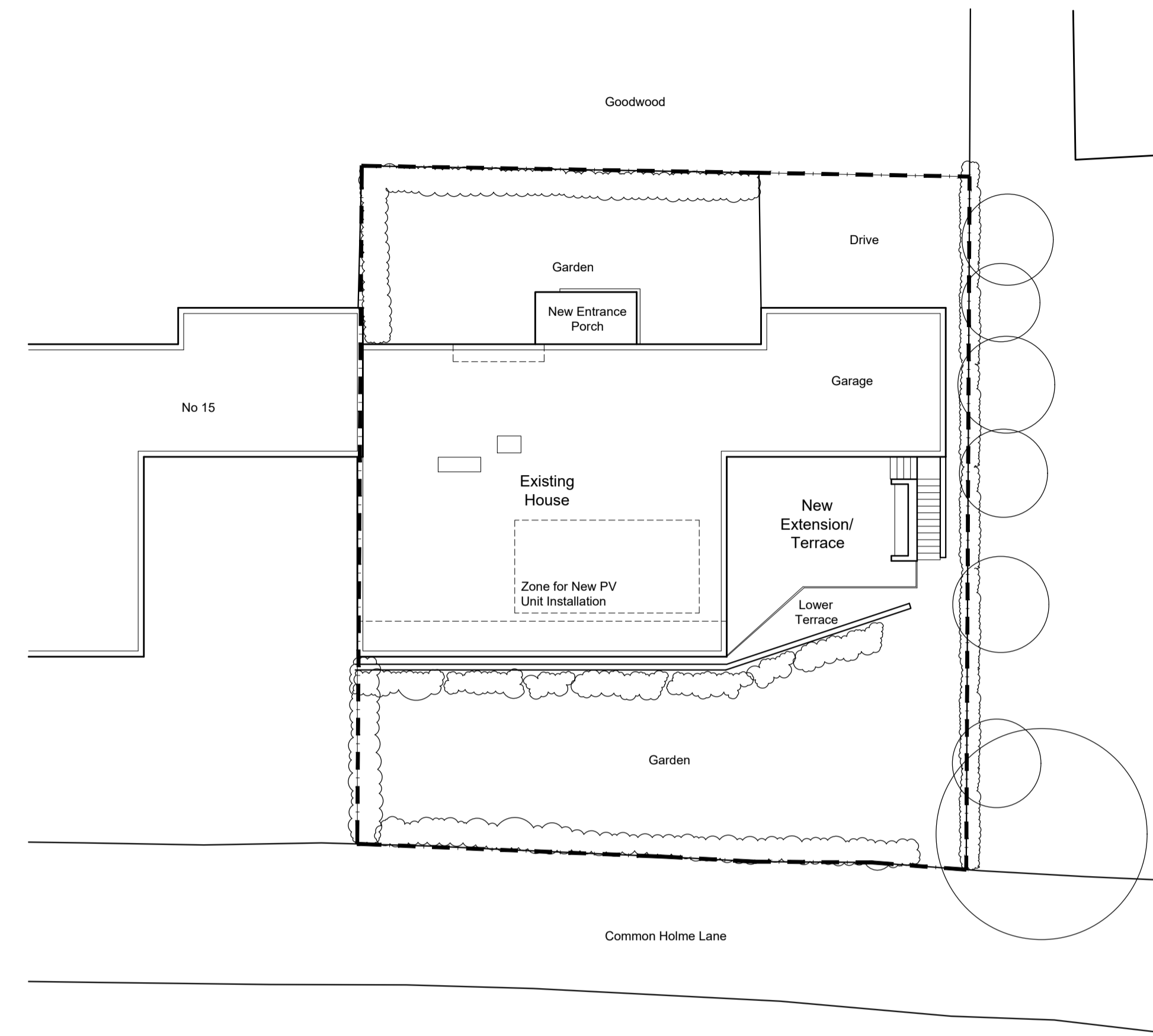

PROPOSED SITE LAYOUT (1:200)

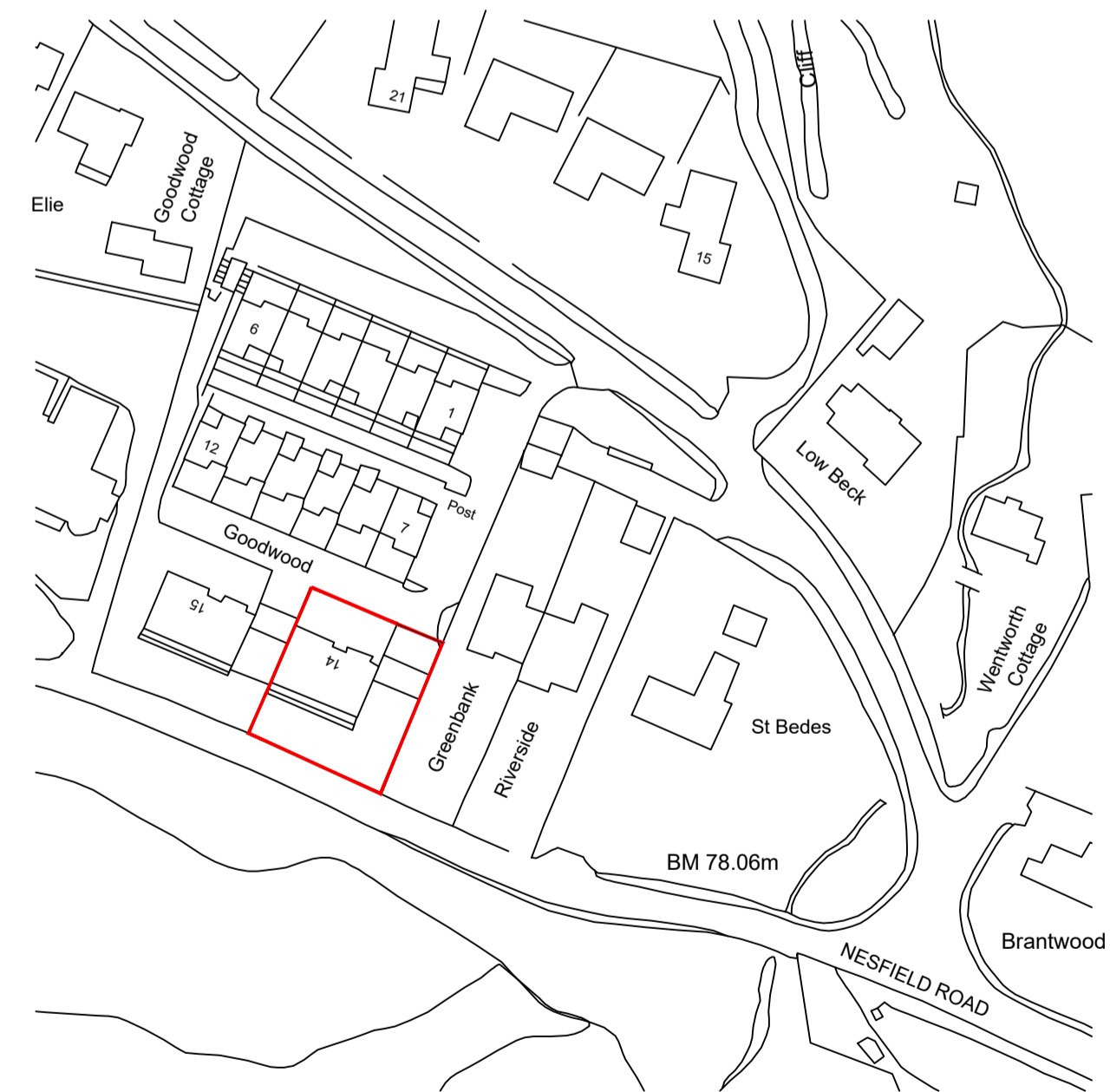

LOCATION PLAN (1:1250)

MHAARCHITECTURE

Bethel Hall
Morton Lane
East Morton
West Yorkshire
BD20 5UE

T: East Morton Office: 01274 512639
Leeds Office: 0113 2732706

Proposed Extension & Alterations
14 Goodwood
Ilkley
for
Mr & Mrs Clark

Existing and Proposed Site Plan

Date:	Drawn By:	Checked By:	Scale: A1@
Mar' 21	PS		Varies
Project No:	Drawing No:	Revision:	
4017	005	-	