

**Proposed Rear Skylight Aperture Opening, under "Permitted Development"**

**38 Fitzwilliam Road, London, SW4 0DN**

**Harry Westall – 07508 954 858 – [harrywestall@hotmail.co.uk](mailto:harrywestall@hotmail.co.uk)**

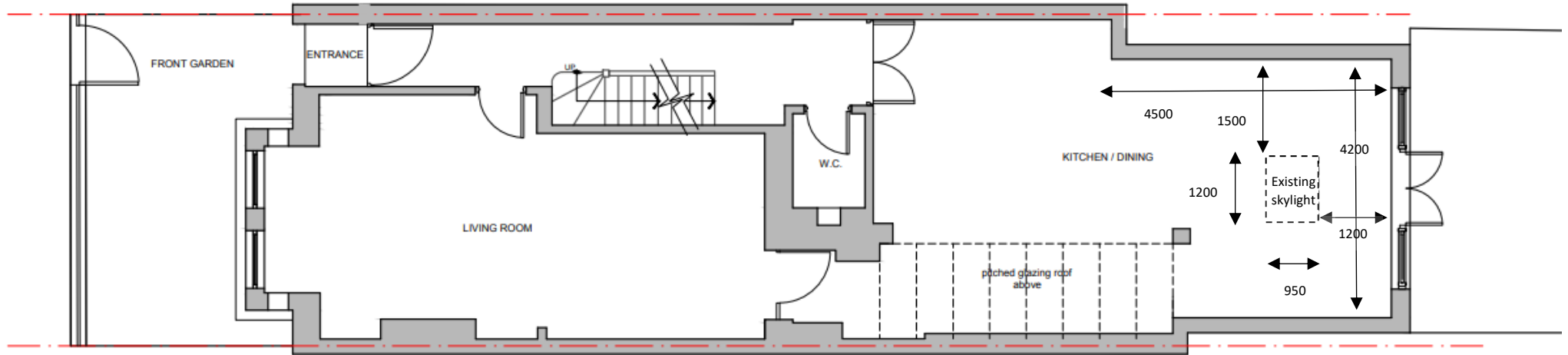

**EXISTING GROUND FLOOR PLAN**

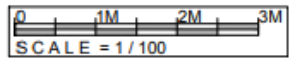

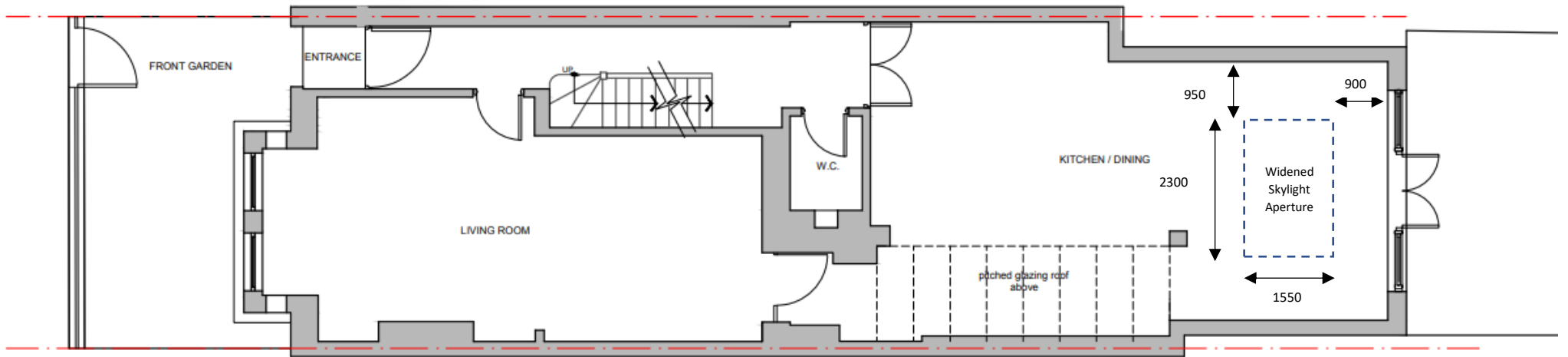

PROPOSED GROUND FLOOR PLAN

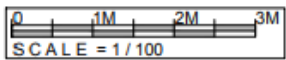

No. 36  
Fitzwilliam Road

No. 38  
Fitzwilliam Road

No. 40  
Fitzwilliam Road

