

Design and Access Statement

Temporary Sculpture Installation

Summer 2021

Forest to Forest

Purpose

This Design and Access Statement has been prepared on behalf of the Forest of Dean Sculpture Trust for the temporary sculpture installation between TBC 2021 and TBC 2021. The sculptures provide a temporary addition to the existing sculpture trail which is located at Forest of Dean Sculpture Trail, Speech House Road, Coleford, Gloucestershire as additional 'content' for visitors to the site in the summer of 2021.

The temporary, time limited permission will allow the installation of eight artworks to be added to the site:

Number	Artist	Name	Description
01	Monsieur Plant	Tree Hug	Tree Hugging arms
02	Robin Collings	The Trees are Talking	Metal Cylinder poem
03	Michelle Cain	Animal Shelter	Badger Shelter over existing Bench
04	Baker & Borowski	Graphic Rewilding	Flower Banners
05	LandArt	Shovel Bugs	Shovel Bugs
06	Edith Musnier	Escapade	Hanging Quavers
07	Seyi Adelekun	Plastic Pavillion	Hanging Bottles Installation
08	Alicja Biala	Totems	3x totems

Further information about each artwork can be found in document D-FDST-ST-21-007

The purpose of this document is to explain the primary design principles of the temporary installation.

The trail welcomes around 300,000 visitors each year, and it is hoped that these temporary additions will encourage further visitors as the country starts to recover from the Covid-19 pandemic.

The Location

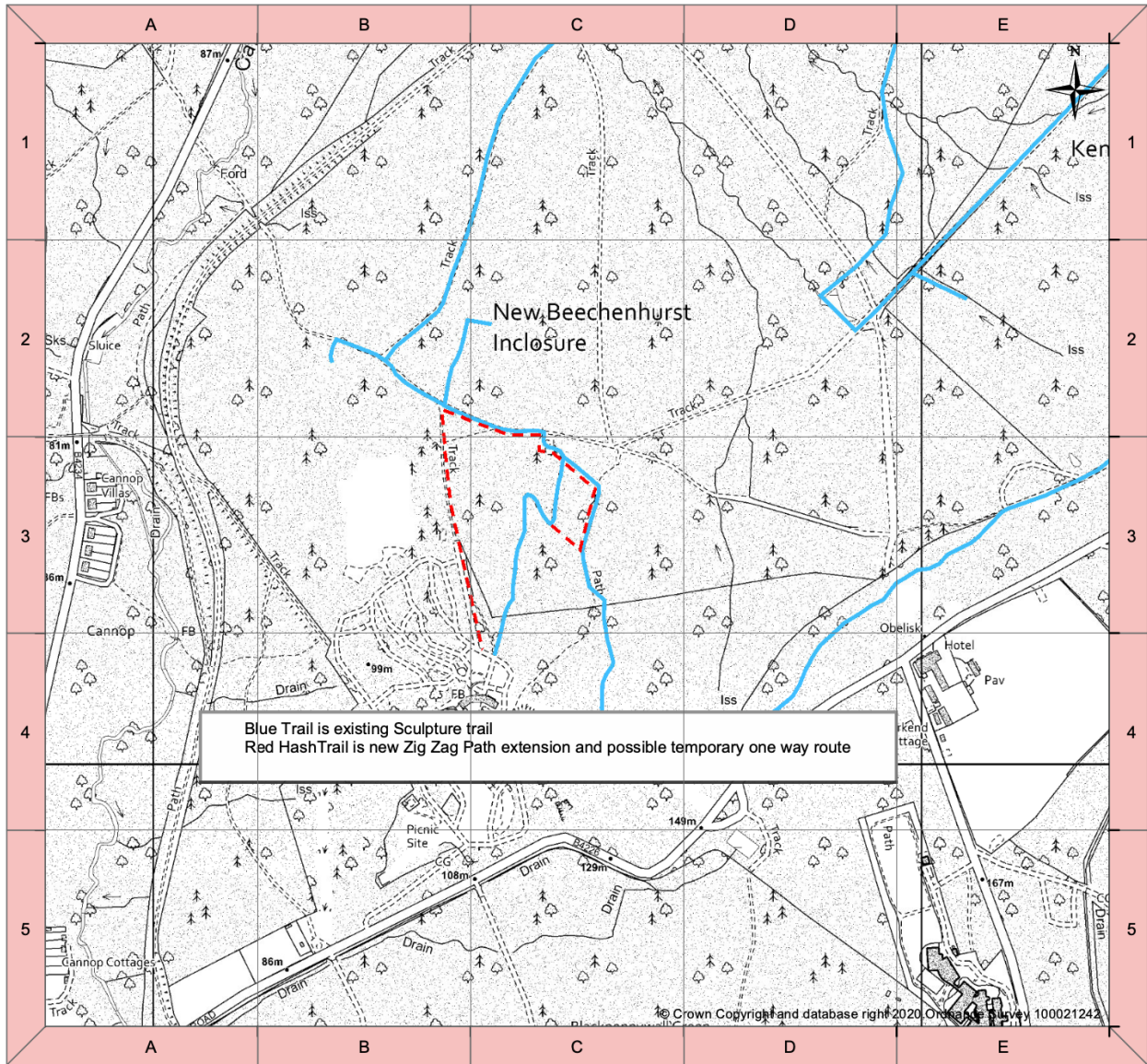

Site Location Plan

The Forest of Dean Sculpture Trust and Forestry England have worked in partnership for the last 30 years to create this vital 4.5 mile long Sculpture Trail that enjoys visitors of over 300,000 people per year. The Forest of Dean Sculpture Trail was established in 1986, and was one of the first to open in the UK. The original commissions, collectively titled Stand and Stare, came out of the land art movement, in which landscape and the works of art were seen as inextricably connected. Following that first wave of commissions the Forest of Dean Sculpture Trust was set up to oversee the maintenance of the trail and to commission new works – both permanent and temporary. The Trust has sought to stay true to the vision of our founders, whilst reflecting current movements in sculpture.

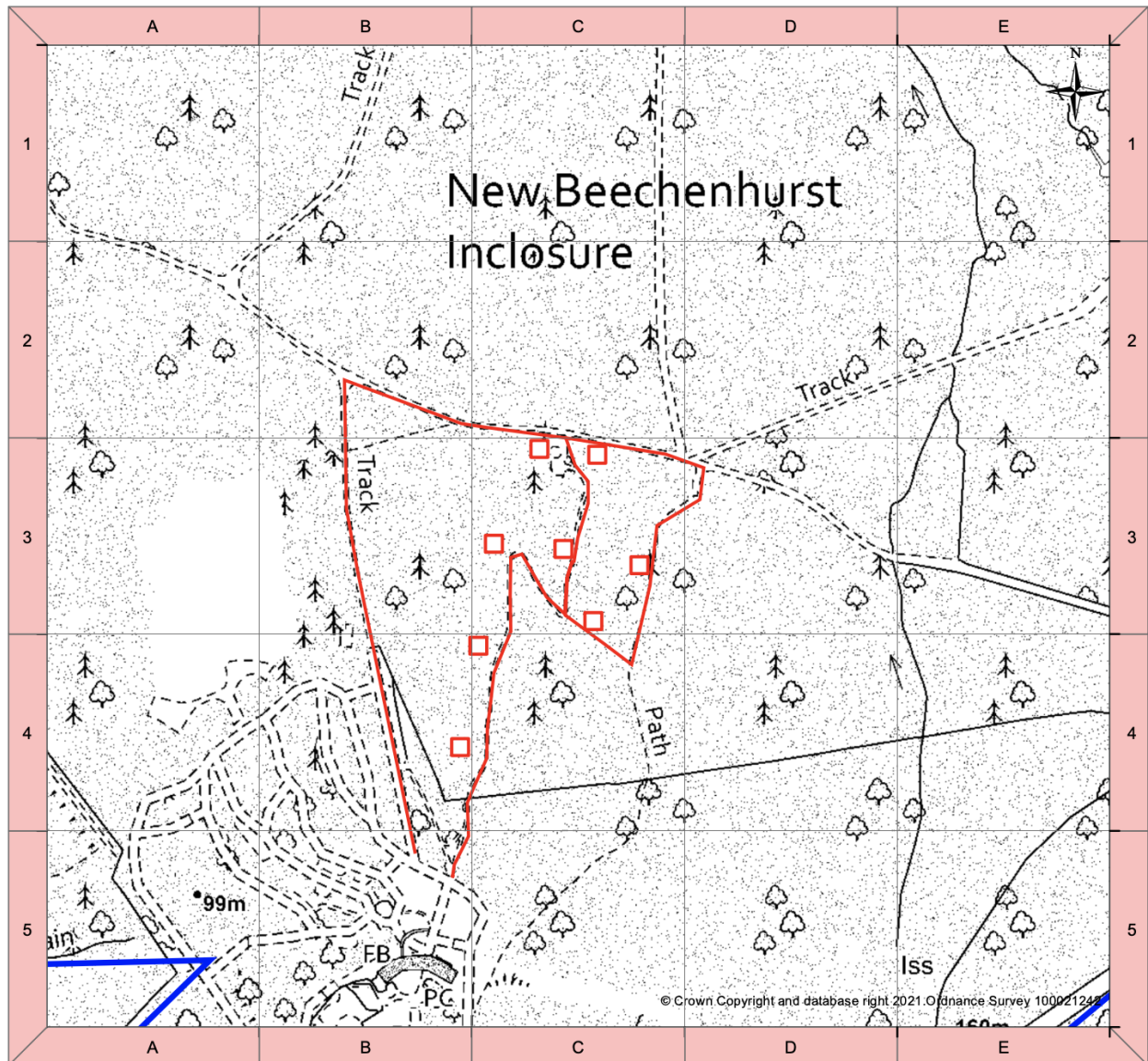

Site Plan

The new sculpture installations will be located in various sites across the wider Sculpture Trail site. Detailed plans are attached to this application detailing the location of each installation and their relative location to each other, within the Beechenhurst site.

The Proposal

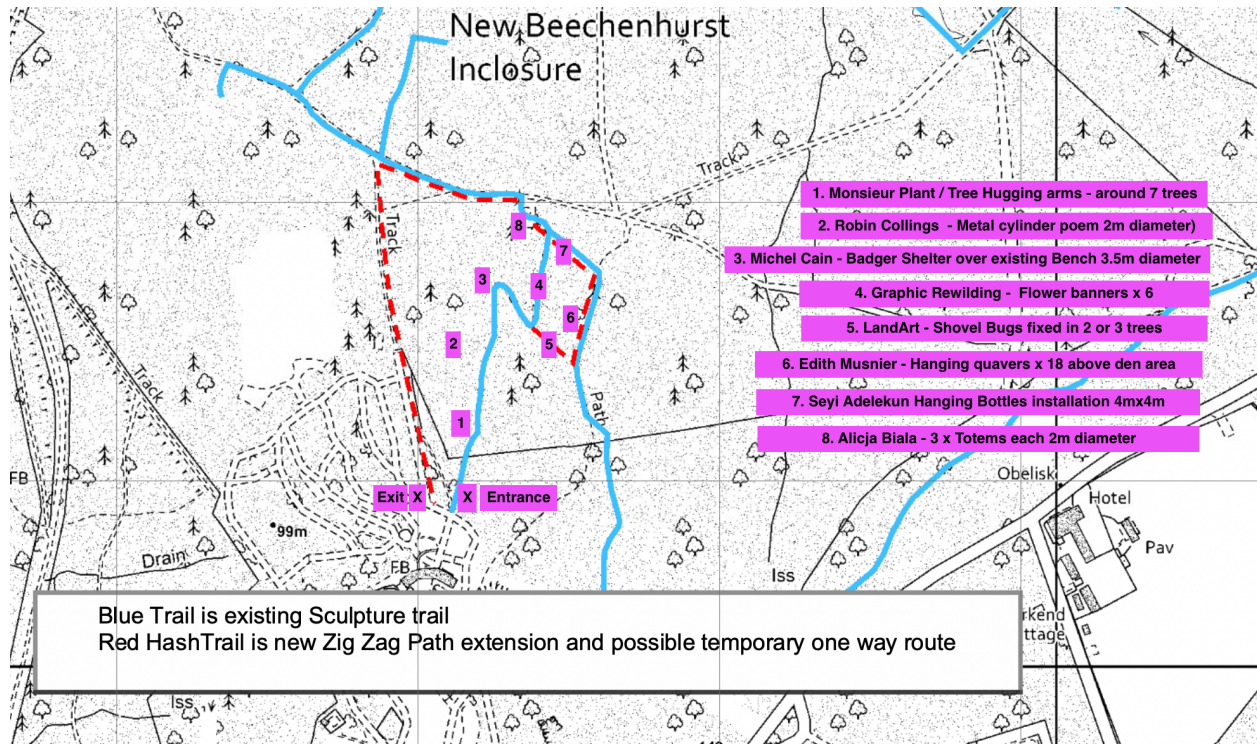

Artwork Locations

Forest to Forest is a new temporary sculpture trail running alongside the existing trail on the Beechenhurst site. It has been conceived to create a shorter, more accessible, fun and family orientated trail.

As a post-lockdown offering it complements the wider trail it is intended to allow for a one way route to be formed and for shorter audience visits than the 4.5mile route currently allows for and adds an alternative offer to the huge number of visitors that will be coming back to the site through the summer months. Selecting works that reflect and respond to the natural environment of the site but utilising a light touch approach that has low impact on the site and brings colour and family friendly works to the site.

Creation of a trail of temporary works for a period of up to 6 months also reinvigorates the site / trail for our regular local audiences that are keen to see new works on the site as plans for new longer term / permanent commissions have been delayed due to covid lockdown.

Each of the different sculptures is different in size/ colour and has a different finish and installation method. Further details about each of the sculptures can be found in document D-FDST-ST-21-007.

None of the installations will be fenced off or barriered. There will no description or signage with any of the installations - by design, visitors will arrive at and leave each installation to make their own judgement and opinion without explanation.

Siting

- The programme has been designed with accessibility in mind
 - The route is shorter than the existing sculpture trail to make the activity more appealing to all - especially coming out of lockdown
 - The route is hoped to be more family friendly, and easier to navigate than the existing trail
- The route makes use of existing tracks within the Forest of Dean Sculpture Trail - no additional clearance of trees, shrubs or ground fauna is required
- The programme is designed to make efficient use of the existing resources at the Forest of Dean Sculpture Trail
- Nothing is visible outside of the boundary of the wider Forest of Dean Sculpture Trail - so there is no external visual impact
- There are no permanent fixings or foundations - everything will be removed at the end of the project
- Consideration has been given to ecological impacts - please see D-FDST-ST-21-008

Scale

Number	Location	Height	Footprint	Installation
01	361455 , 212237	Various	0m x 0m	Attached
02	361462 , 212287	2.0m	2.0m x 2.0m	Freestanding
03	361495 , 212359	3.5m	3.5m x 3.5m	Freestanding
04	361552 , 212338	Various	Various	Attached
05	361551 , 212346	Various	0m x 0m	Attached
06	361560 , 212355	Various	2.8m x 1.2m each	Attached
07	361552 , 212398	5m	4m x 4m	Freestanding
08	361517 , 212422	4m	2.8m x 1.2m each	Freestanding

Access

Access to the sculpture is via the pedestrian trail. During the proposed construction phase materials and machinery will be transported to the site via suitable vehicles (and carried, by hand, where required) using existing forest access tracks and paths. No trees will be removed, nor will the ground be cleared for the installation or removal processes.

Ecology

There will be minimal if no disruption to coexisting flora and fauna as the artworks are either viewed from the existing hard stone path or are located in woodland where ground flora is limited, being bare ground, leaf litter with some bramble.

The trail has been in use for a substantial amount of time, the footfall in the area has prevented the establishment of vegetation due to the site's popularity.

Furthermore the area proposed has not been classified with any legally restricting designations such as Sites of Special Scientific Interest.

Conclusion

Consideration has been given to four key areas for this application:

1. Sustainable development
 - Site layout designed to make efficient use of existing resources
 - Consideration given to using local suppliers
 - Time limited to minimise long term impact
2. The local economy
 - Encouraging more visitors to the area
 - Providing additional business for local traders
3. The environment
 - Significantly low with minimal disturbance to coexisting flora and fauna
 - Low carbon footprint as locally sourced suppliers and contractors will be used to undertake the construction and installation
 - Time limited to minimise long term impact
4. Social development
 - Prime example of social enhancement in rural areas