

Windows on front elevation to remain the same

Light grey K-Rend finish to walls

Windows on front elevation to remain the same

Timber canopy finished in flat slate tiles to match roof and surrounding buildings

Recessed Crittall style doors in aluminium powder coated black

**FRONT ELEVATION**  
1:50

Sliding windows in aluminium powder coated black

Glazed balustrade

Light grey K-Rend finish to walls

**SIDE ELEVATION**  
1:50

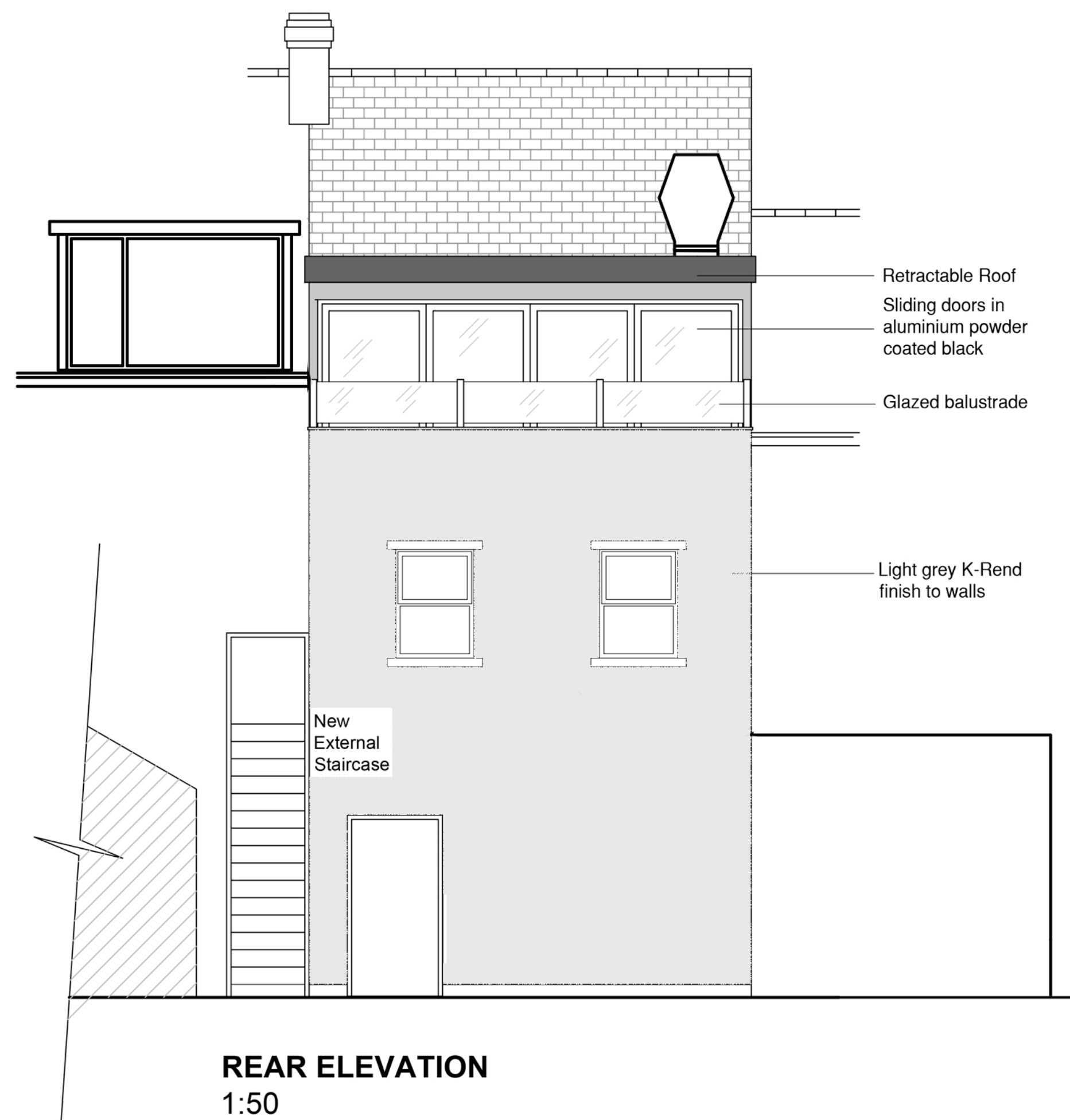

Retractable Roof

Sliding doors in aluminium powder coated black

Glazed balustrade

Light grey K-Rend finish to walls

New External Staircase

**REAR ELEVATION**  
1:50

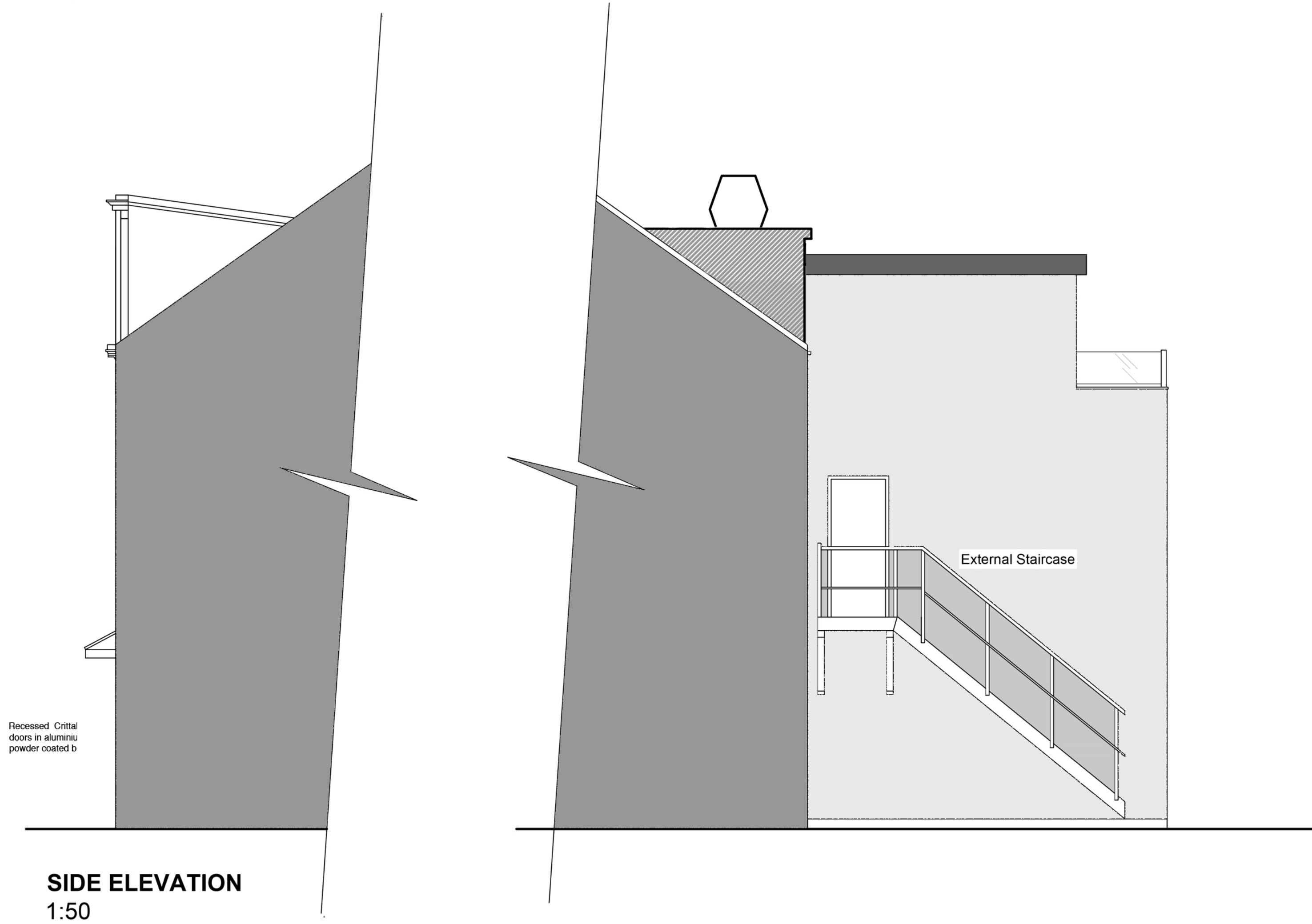

Recessed Crittall doors in aluminium powder coated black

**SIDE ELEVATION**  
1:50



Project  
3 storey rear extension with retractable roof system. New recessed restaurant entrance

Address  
3 Ball Street  
Poulton-le-Fylde  
FY6 7BA

Client  
Gochu Ltd.

Date  
28.02.2021

Scale  
1:50

Drawing Title  
PROPOSED ELEVATION

Drawing Number  
MCS/21001/002

Rev  
A