

KILLEARN PRIMARY SCHOOL

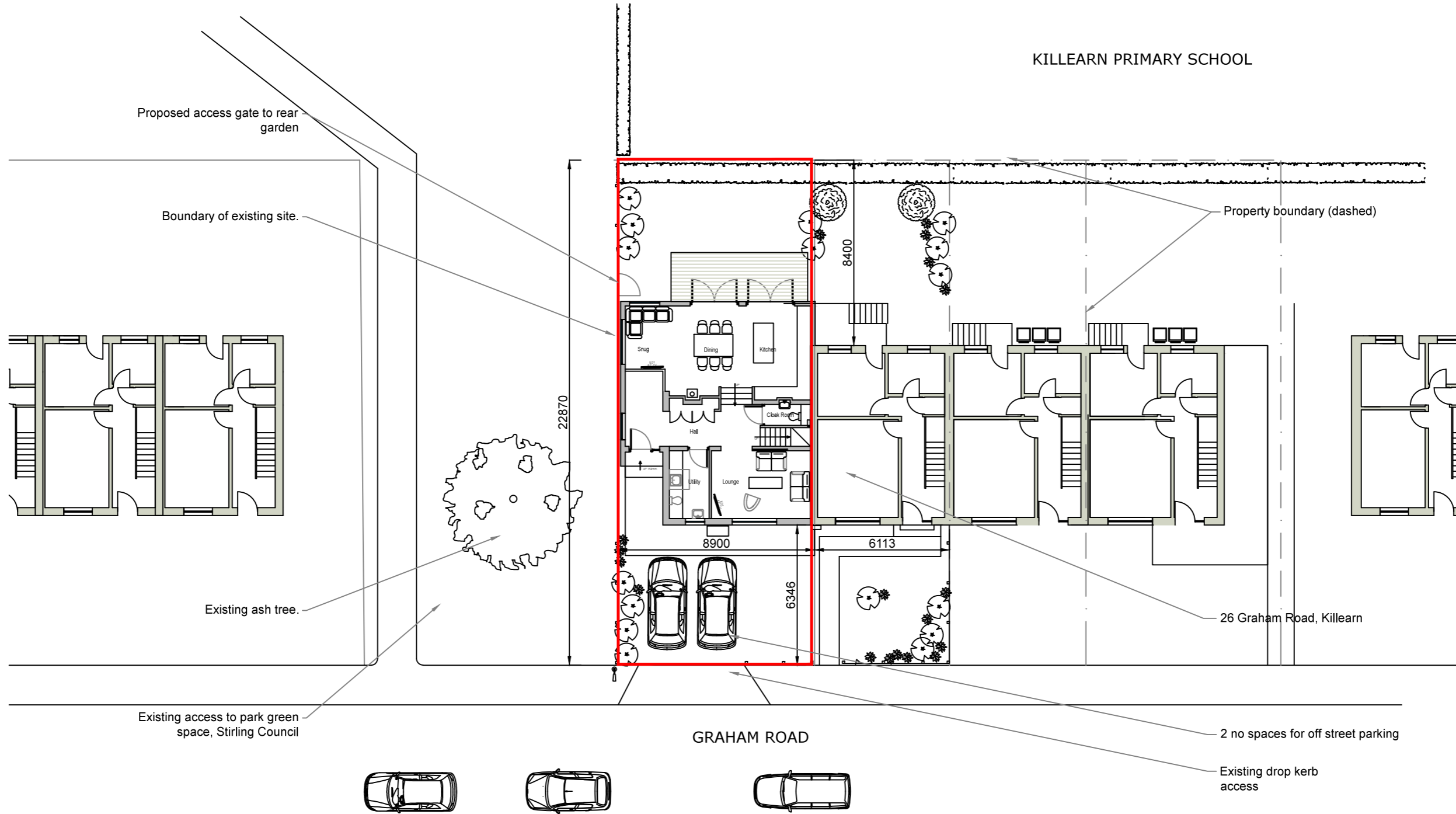

Proposed site boundary, currently part of no. 26 Graham Road

PROPOSED SITE PLAN
1:200



Scale in metres - 1:200 scale bar

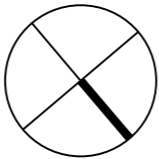

Porcupine Design 26 Muirpark Way Drymen G63 0DX		www.porcupinedesign.co.uk	
DO NOT SCALE. Use figured dimensions only. All dimensions, spot levels and drainage positions to be checked on site by Contractor prior to construction. Any discrepancies to be reported back to Porcupine Design. Drawings to be read & fully understood before work commences. IF IN DOUBT ASK.			
A	Proposed Site Plan included	14 01 21	SJK
rev	description	date	by checked

client Millar Shaw	date 27 Oct 2020
address 26 Graham Road Killearn	drawn SJK
title Proposed Site Plan	checked SJK
	scale 1:200 @ A3

PLANNING		job number 6126-G-PLA	dwg no A199	rev A
-----------------	--	---------------------------------	-----------------------	-----------------