

NEW ROOF OVERLAP @ EXIST'. REMOVE TILE, BATTENS, MEMBRANE & SARKING ON EXIST' ROOF.

COOTHS @ RAFTERS: 12.5mm DUPLEX PL' BD ON 50mm KINGSPAN TO UPS RAFTERS. 125mm KINGSPAN BETWEEN RAFTER. 50mm AIRSPACE.

CEMENT FILLET ON TOP OF OUTER SKIN. ROCKWOOL OR EQUAL SHORT FIRE RESISTANT CAVITY CLOSURE @ WALLHEAD.

19mm PLANK + 12.5mm FIRELINE ON INSIDE OF THIS WALL INSTEAD OF OSB

ROUGHCAST FINISHED ON ALUMI BELL-CAST BEAD @ DPC LEVEL.

FLOOR:- 22mm T&G MOISTURE RESISTANT FLOORING GRADE CHIPBOARD ON 175x47mm JOISTS @ 600mm CTRS. JOISTS ON 25mm WALL PLATE & DPC. 175mm KINGSPAN TF BETWEEN JOISTS. NETION OF UPS JOISTS.

ROOF CONSTRUCTION: MARLEY ROLLED BOLD (SMOOTH FINISH) COLOUR TO MATCH EXISTING. 100mm HEADLAP. MIN. PITCH 17 1/2° ACTUAL PITCH 18 1/2°. ON 38x25mm TREATED BATTENS & 38x19mm TREATED COUNTER-BATTENS. DALTEX ROOFSHIELD BREATHER MEMBRANE ON 19mm SARKING (ENSURE 2mm GAP BETWEEN BOARDS) 175x47mm RAFTERS @ 600mm CTRS. 120x47mm CEILING TIES. 2/220x47mm AS RIDGE. SAW-TOOTHED WASHERS & BOLTS CONNECTIONS RAFTER BIRD-ROUCHED CHECKED @ WALLHEAD.

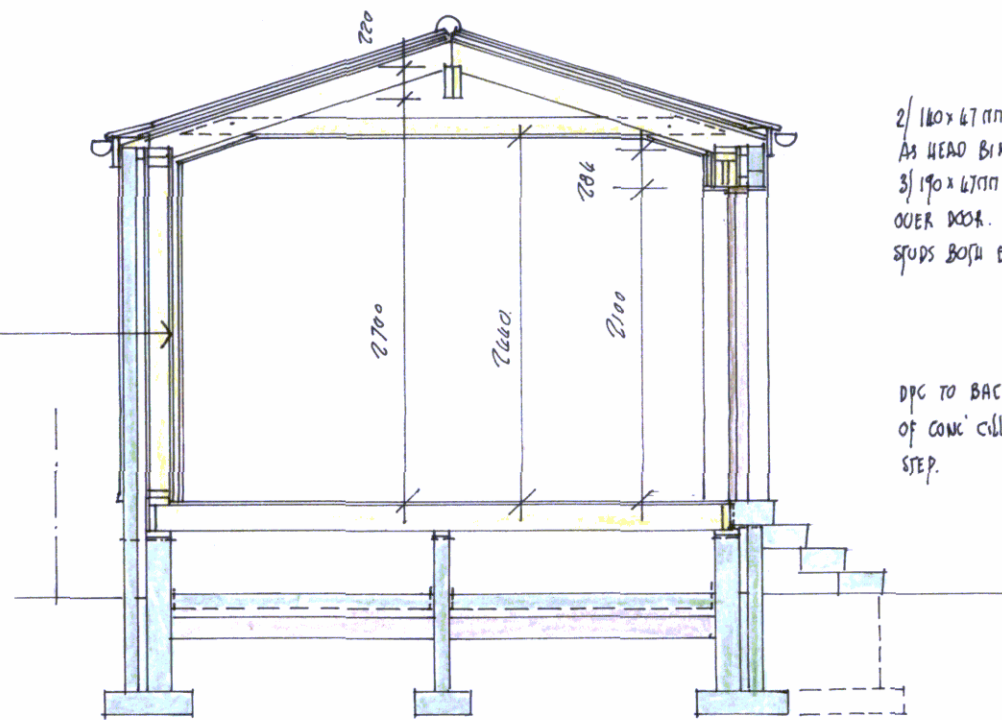

SECTION 'A'

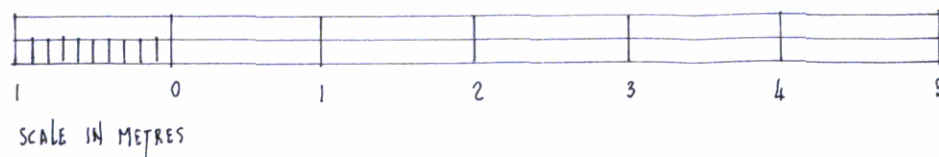

190x90mm STEEL CHANNEL WITH 150x150mm HTS. ANGLE (ANGLE FOR OUTER SKIN) OVER WINDOW.

2/180x47mm RUNNERS AS HEAD BINDER TO 3/190x47mm RUNNERS OVER DOOR. CRIPPLE STUDS BOTH ENDS.

DPC TO BACK ENDS & UPS OF CONC. CILL & TOP CONC. STEP.

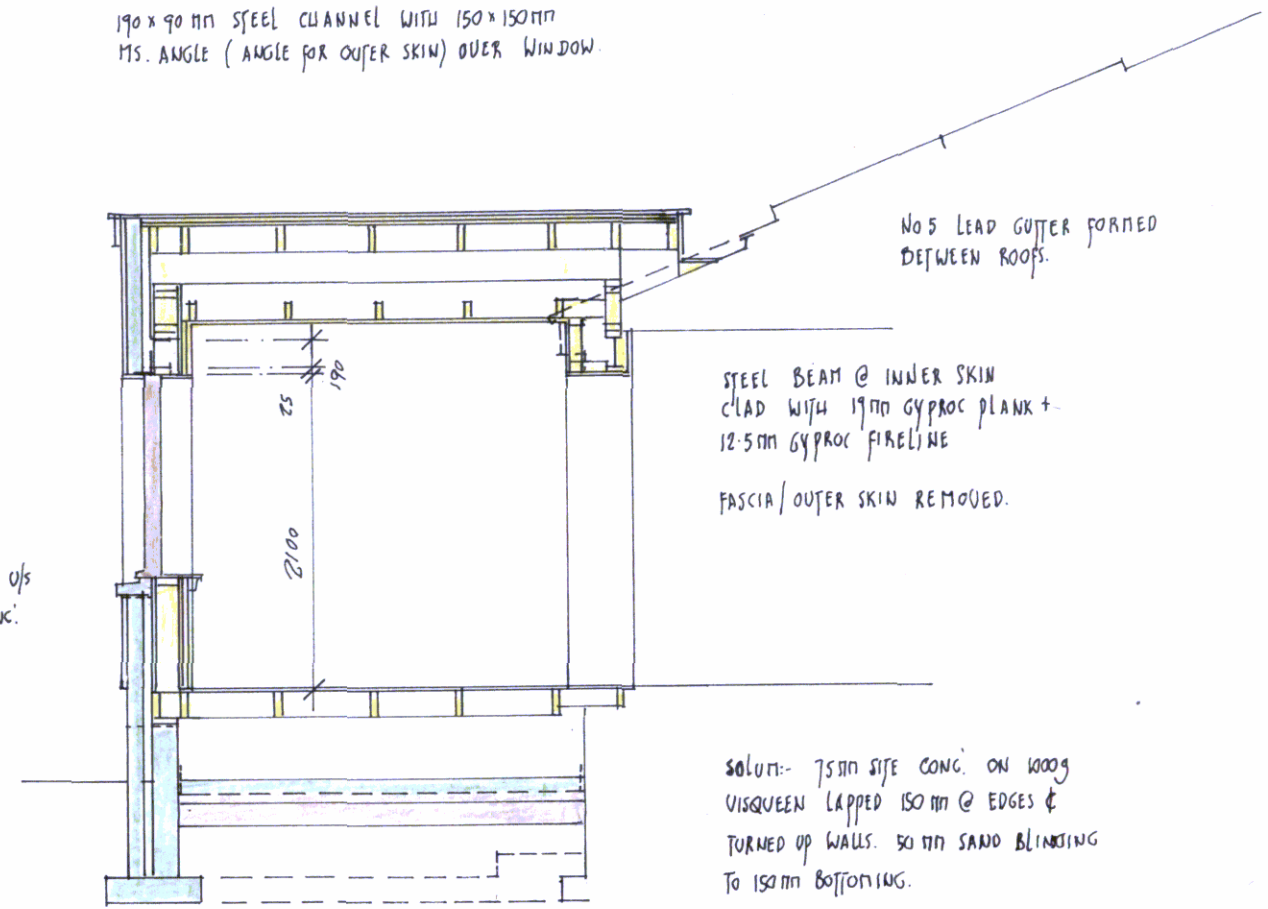

SECTION 'B'

SOLU:- 75mm SFE CONC. ON 1000g VISQUEEN LAPPED 150mm @ EDGES & TURNED UP WALLS. 50mm SAND BLINDING TO 150mm BOTTOMING.

17 BERRYDALE ROAD, BLAIRGOWRIE.  
DRG. No:- 3353/3 SCALE:- 1:50 @ A3.