

**Note:**  
DO NOT SCALE from this drawing. Please contact this office for any additional information required.  
Contractors, Sub-Contractors and Suppliers must check all relevant dimensions and levels of the site and building before commencing any workshop drawings or building work. Any discrepancies should be recorded to the Office.  
Where applicable this drawing is to be read in conjunction with the Consultants' drawings.

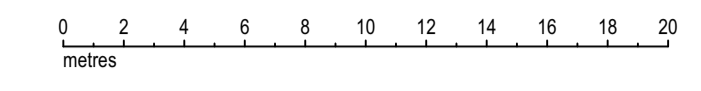

NOTE: Existing ground levels within pink coloured root protection zones to remain as existing. Retaining walls and their foundations are not to encroach into the root protection zones.

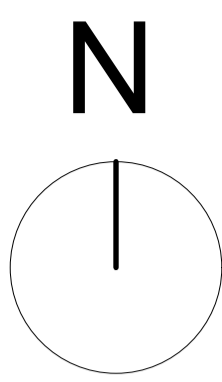

- LEGEND**
- SV Sluice valve
  - DK Drop kerb
  - FH Fire hydrant
  - MH Manhole
  - SC Stop cock
  - WM Water meter
  - BT Telecom manhole
  - LP Lamp post
  - RG Road gully
  - SP Sign post
  - ELP Electricity pole
  - TP Telephone pole
  - PW Post and wire
  - PR Post and rail
  - T/P Timber panel
  - CB Close boarded
  - BW Barbed wire
- Grid and levels are to OS Datum

- Rev F: Plot 4 rotated to accommodate site levels - 30 March 2021
- Rev E: Planning application red line amended - 20 Nov 2019
- Rev D: Planning scheme proposals added - 19 Nov 2019
- Rev C: Drawing size amended - 18 Oct 2019
- Rev B: Small windows to Bed 1 removed - 25 Sept 2019
- Rev A: Attenuation adjacent Plot 5 amended - 16 Sept 2019

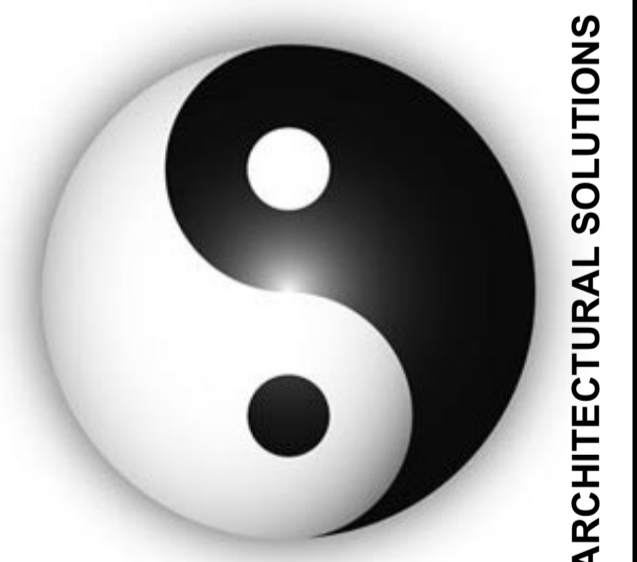

**SYNERGY**

W: [www.synergy-as.co.uk](http://www.synergy-as.co.uk)  
E: [kevin@synergy-as.co.uk](mailto:kevin@synergy-as.co.uk)  
T: 01548 810780 M: 07749 525591

Client: **Mr A Harding**

Project: **Site at Halwill Junction, Devon**

Drawing Title: **Proposed Site Layout**

Drawing Status: **Planning**

Scale	Paper Size	Date	Drawn
1:250	A1	12.06.19	KJS

Job No.	Drawing Number	Rev.
S1905	P02	F