

NOTES

PROTECTION OF EXISTING VEGETATION

Existing vegetation to be retained on site shall be protected where necessary during works by a tree protective barrier, secured to a scaffold tubing framework with fluorescent tape to the top rail. Protective fencing shall be erected on the canopy drip line wherever possible. Laminated, waterproof A4 signs shall be fixed to the fence posts at 10m intervals bearing the words 'PROTECTED TREE ZONE - NO STORAGE OR OPERATIONS WITHIN FENCED AREA'.

Tracking of machinery, storage of chemicals and building materials shall not be permitted within the protected area. Leaks or spills should be removed immediately and the contaminated soil replaced. No bonfires shall be lit within 5m of the canopy spread. Any excavation work beneath the canopy spread shall be carried out by hand.

All works affecting trees within the development shall be subject to BS 5837:2012.

TREE PLANTING

Trees will be planted across the site to mitigate for the loss of existing trees. Where possible along the housing frontages, extra heavy standard trees will be planted, which will provide instant impact and a tree lined frontage to the site. Within the site, selected standard trees will be planted within front gardens. The trees will be ornamental varieties, which will create an attractive tree lined street. At key focal points trees will be also planted within rear gardens as selected or standard sized trees. The trees will be Foundation design of new buildings shall accommodate proposed tree planting in accordance with NHBC guidelines.

Species to be selected from:

- | | |
|----------------------------------|---|
| Acer campestre (Ac) | Prunus avium (Pa) |
| Acer campestre 'Elsrijk' (AcE) | Pyrus calleryana 'Chanticleer' (PcC) |
| Alnus glutinosa (Ag) | Pyrus calleryana 'Redspire' (PcR) |
| Betula pendula (Bp) | Sorbus aucuparia (Sau) |
| Betula utilis jacquemontii (BuJ) | Sorbus aucuparia 'Sheerwater Seedling' (SaSS) |
| Carpinus betulus (Cb) | Sorbus 'Joseph Rock' (SJR) |

SHRUB PLANTING

A mix of evergreen and deciduous shrubs will be planted in selected front gardens to soften the development and to provide a valuable food source for birds and invertebrates. A mix of medium/low shrubs will be planted to shrub beds with medium/large varieties used against high walls and fences.

Species to be selected from: () density/m2

- Berberis frikartii 'Amstelveen' (5), Berberis thunbergii 'Atropurpurea Nana' (5),
 Bergenia cordifolia 'Silberlicht' (6), Buddleia davidii 'Lochin' (2), Ceanothus
 thyrsiflorus repens (4), Chaenomeles superba 'Jet Trail' (4), Cornus alba 'Spaethii' (2),
 Cornus stolonifera 'Flaviramea' (2), Cotoneaster conspicuus 'Decorus' (6), Cotoneaster
 lacteus (2), Cytisus 'Allgold' (4), Eleagnus pungens 'Maculata' (3), Escallonia 'Apple
 Blossom' (4), Euonymus fortunei 'Emerald Gaiety' (6), Festuca spp (6), Geranium
 'Johnson's Blue' (4), Hebe albicans 'Red Edge' (4), Hebe 'Autumn Glory' (4), Hypericum
 x moserianum (4), Juniperus sabina 'Tamariscifolia' (3), Lavandula 'Hidcote' (6),
 Lonicera 'Maygreen' (4), Lonicera 'Silver Beauty' (4), Nepeta faassenii (4), Perovskia
 'Blue Spire' (6), Phormium var. 'Potentilla' 'Red Ace' (5), Prunus laurocerasus
 'Zabellana' (3), Pyracantha 'Orange Charm' (3), Rubus x 'Betty Ashburner' (4),
 Spiraea 'Gold Flame' (4), Spiraea 'Shirobana' (4), Viburnum tinus 'Eve Price' (3)

HEDGE PLANTING

Hedges will be planted in selected plots to strengthen boundaries and improve screening between properties and against the site boundary. Ornamental hedge planting will consist of evergreen flowering Escallonia, which will contribute to all year round colour and texture.

NATIVE PLANTING

New native hedging is to be planted at the existing entrance to the field to complement the existing hedgerow that is to be retained and to help create a soft rural entrance to the site. There is also proposed gap planting to the east of plot 16 to close their boundary.

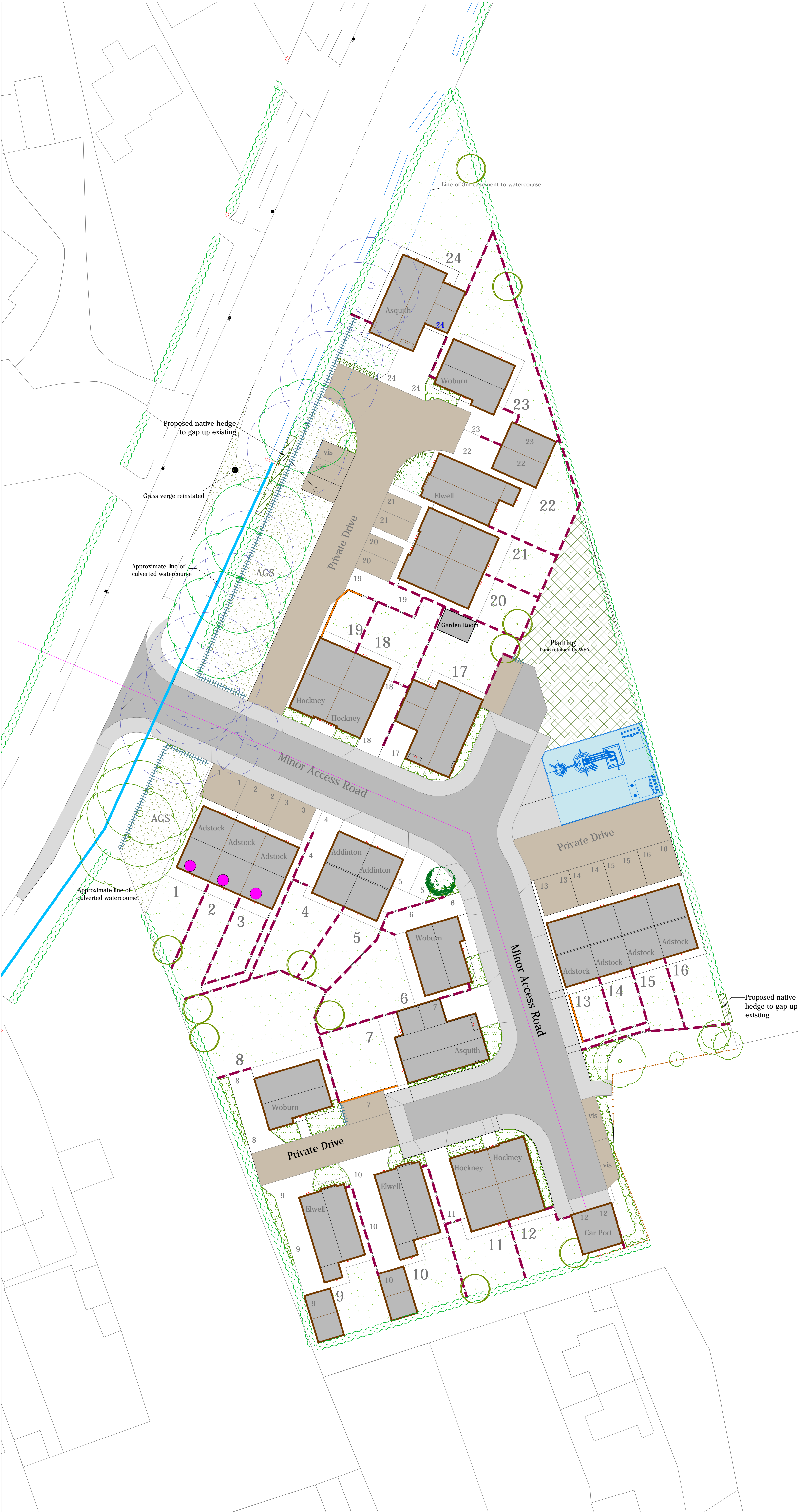

KEY

- Existing trees, hedges and vegetation to be retained.
- Existing trees, hedges and vegetation to be removed.
- Proposed Extra heavy standard (14-16cm girth) tree
- Proposed heavy standard (12-14cm girth) tree
- Proposed selected standard (10-12cm girth) tree
- Proposed evergreen flowering hedge (Escallonia)
- Proposed native hedge
- Proposed ornamental shrub planting
- Proposed turf
- Rear gardens
- Proposed amenity grass seed
- Proposed 1800mm high timber close boarded fence (detailed by others)
- Proposed 1800mm high brick walls (detailed by others)
- Proposed 1200mm estate railings (detailed by others)

Rev C: Amended in line with client comments (SEL) Apr 21
 Rev B: Amended in line with Site Layout Rev C (SEL) Apr 21
 Rev A: Amended in line with current site plan (SEL) Dec 20

<p>Sue Farmer BA MALD MLI Landscape Architect</p> <p>fdalandscape</p> <p>Westleigh Hall Wakefield Road Denby Dale Huddersfield HD8 8QJ telephone 01484 861611 fax 01484 861616 isdh 01484 866900 email info@fdalandscape.co.uk www.fdalandscape.co.uk</p>	client	Ward Homes, Yorkshire		
	project	Residential Development SPROATLEY ROAD PRESTON		
	drawing title	LANDSCAPE LAYOUT		
	scale	date	drawn by	drawing no
1:250/A1	Nov 20	SEL	R/2415/1C	