

**NOTES**

1. All dimensions must be checked on site and not relied upon for setting out.

2. The site is divided into seven plots (Plots 1-7) by a central 'PRIVATE DRIVE' and 'PUBLIC RIGHTS OF WAY'.

3. The site is bounded by 'DEHAM ROAD' to the north and 'VAUGHAN ROAD' to the west.

4. The site is bounded by 'NEW 15th NINE FOOTING' to the east.

5. The site is bounded by 'PUBLIC RIGHTS OF WAY' to the south.

6. The site is bounded by 'PUBLIC RIGHTS OF WAY' to the east.

7. The site is bounded by 'PUBLIC RIGHTS OF WAY' to the south.

8. The site is bounded by 'PUBLIC RIGHTS OF WAY' to the east.

9. The site is bounded by 'PUBLIC RIGHTS OF WAY' to the south.

10. The site is bounded by 'PUBLIC RIGHTS OF WAY' to the east.

11. The site is bounded by 'PUBLIC RIGHTS OF WAY' to the south.

12. The site is bounded by 'PUBLIC RIGHTS OF WAY' to the east.

13. The site is bounded by 'PUBLIC RIGHTS OF WAY' to the south.

14. The site is bounded by 'PUBLIC RIGHTS OF WAY' to the east.

15. The site is bounded by 'PUBLIC RIGHTS OF WAY' to the south.

16. The site is bounded by 'PUBLIC RIGHTS OF WAY' to the east.

17. The site is bounded by 'PUBLIC RIGHTS OF WAY' to the south.

18. The site is bounded by 'PUBLIC RIGHTS OF WAY' to the east.

19. The site is bounded by 'PUBLIC RIGHTS OF WAY' to the south.

20. The site is bounded by 'PUBLIC RIGHTS OF WAY' to the east.

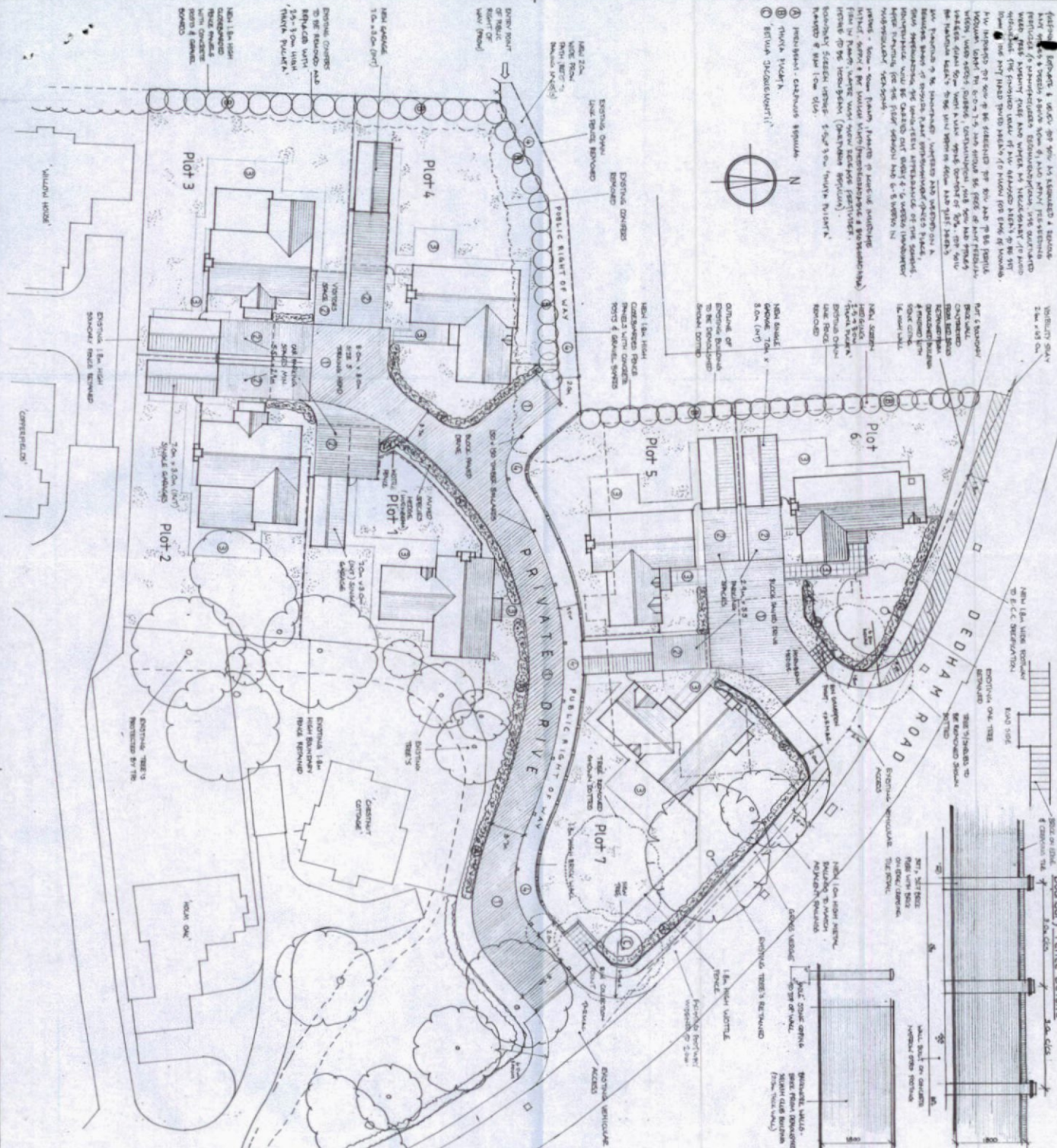
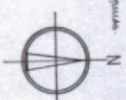

**Boundary Fence Details**

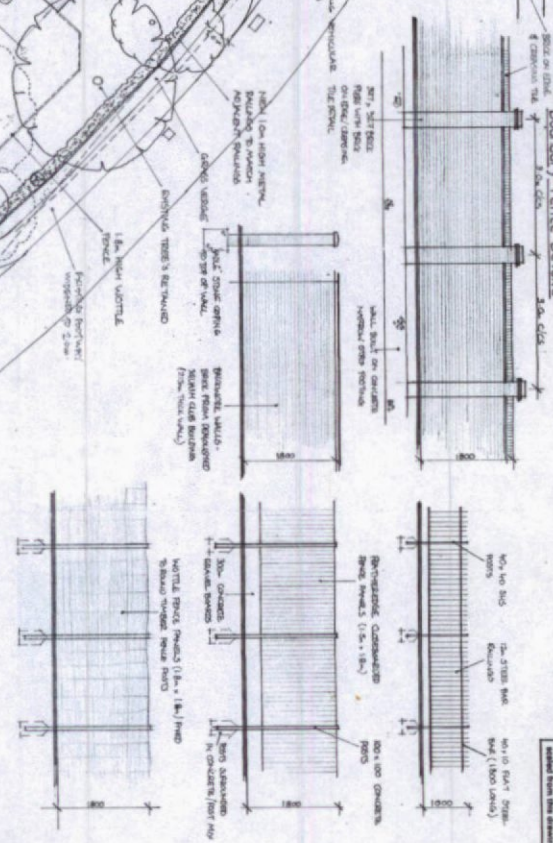

- LEGEND**
- 1. PERIMETER WALL (1.5m x 1.5m)
  - 2. PERIMETER WALL (1.5m x 1.5m)
  - 3. PERIMETER WALL (1.5m x 1.5m)
  - 4. PERIMETER WALL (1.5m x 1.5m)
  - 5. PERIMETER WALL (1.5m x 1.5m)
  - 6. PERIMETER WALL (1.5m x 1.5m)
  - 7. PERIMETER WALL (1.5m x 1.5m)
  - 8. PERIMETER WALL (1.5m x 1.5m)
  - 9. PERIMETER WALL (1.5m x 1.5m)
  - 10. PERIMETER WALL (1.5m x 1.5m)
  - 11. PERIMETER WALL (1.5m x 1.5m)
  - 12. PERIMETER WALL (1.5m x 1.5m)
  - 13. PERIMETER WALL (1.5m x 1.5m)
  - 14. PERIMETER WALL (1.5m x 1.5m)
  - 15. PERIMETER WALL (1.5m x 1.5m)
  - 16. PERIMETER WALL (1.5m x 1.5m)
  - 17. PERIMETER WALL (1.5m x 1.5m)
  - 18. PERIMETER WALL (1.5m x 1.5m)
  - 19. PERIMETER WALL (1.5m x 1.5m)
  - 20. PERIMETER WALL (1.5m x 1.5m)

<p><b>VAUGHAN &amp; BLYTH</b>                  Building Services Engineers Ltd                  100, 102, 104, 106, 108, 110, 112, 114, 116, 118, 120, 122, 124, 126, 128, 130, 132, 134, 136, 138, 140, 142, 144, 146, 148, 150, 152, 154, 156, 158, 160, 162, 164, 166, 168, 170, 172, 174, 176, 178, 180, 182, 184, 186, 188, 190, 192, 194, 196, 198, 200, 202, 204, 206, 208, 210, 212, 214, 216, 218, 220, 222, 224, 226, 228, 230, 232, 234, 236, 238, 240, 242, 244, 246, 248, 250, 252, 254, 256, 258, 260, 262, 264, 266, 268, 270, 272, 274, 276, 278, 280, 282, 284, 286, 288, 290, 292, 294, 296, 298, 300, 302, 304, 306, 308, 310, 312, 314, 316, 318, 320, 322, 324, 326, 328, 330, 332, 334, 336, 338, 340, 342, 344, 346, 348, 350, 352, 354, 356, 358, 360, 362, 364, 366, 368, 370, 372, 374, 376, 378, 380, 382, 384, 386, 388, 390, 392, 394, 396, 398, 400, 402, 404, 406, 408, 410, 412, 414, 416, 418, 420, 422, 424, 426, 428, 430, 432, 434, 436, 438, 440, 442, 444, 446, 448, 450, 452, 454, 456, 458, 460, 462, 464, 466, 468, 470, 472, 474, 476, 478, 480, 482, 484, 486, 488, 490, 492, 494, 496, 498, 500, 502, 504, 506, 508, 510, 512, 514, 516, 518, 520, 522, 524, 526, 528, 530, 532, 534, 536, 538, 540, 542, 544, 546, 548, 550, 552, 554, 556, 558, 560, 562, 564, 566, 568, 570, 572, 574, 576, 578, 580, 582, 584, 586, 588, 590, 592, 594, 596, 598, 600, 602, 604, 606, 608, 610, 612, 614, 616, 618, 620, 622, 624, 626, 628, 630, 632, 634, 636, 638, 640, 642, 644, 646, 648, 650, 652, 654, 656, 658, 660, 662, 664, 666, 668, 670, 672, 674, 676, 678, 680, 682, 684, 686, 688, 690, 692, 694, 696, 698, 700, 702, 704, 706, 708, 710, 712, 714, 716, 718, 720, 722, 724, 726, 728, 730, 732, 734, 736, 738, 740, 742, 744, 746, 748, 750, 752, 754, 756, 758, 760, 762, 764, 766, 768, 770, 772, 774, 776, 778, 780, 782, 784, 786, 788, 790, 792, 794, 796, 798, 800, 802, 804, 806, 808, 810, 812, 814, 816, 818, 820, 822, 824, 826, 828, 830, 832, 834, 836, 838, 840, 842, 844, 846, 848, 850, 852, 854, 856, 858, 860, 862, 864, 866, 868, 870, 872, 874, 876, 878, 880, 882, 884, 886, 888, 890, 892, 894, 896, 898, 900, 902, 904, 906, 908, 910, 912, 914, 916, 918, 920, 922, 924, 926, 928, 930, 932, 934, 936, 938, 940, 942, 944, 946, 948, 950, 952, 954, 956, 958, 960, 962, 964, 966, 968, 970, 972, 974, 976, 978, 980, 982, 984, 986, 988, 990, 992, 994, 996, 998, 1000</p>	
<p><b>Client:</b> Ardleigh Hall LLP</p> <p><b>Site:</b> Proposed Development, Deham Road, Ardleigh</p> <p><b>Scale:</b> 1:200</p> <p><b>Date:</b> Dec '15</p> <p><b>Drawn by:</b> [Name]</p> <p><b>Check by:</b> [Name]</p> <p><b>Project No.:</b> 605/1</p> <p><b>Sheet:</b> D</p>	