

Playing fields as existing

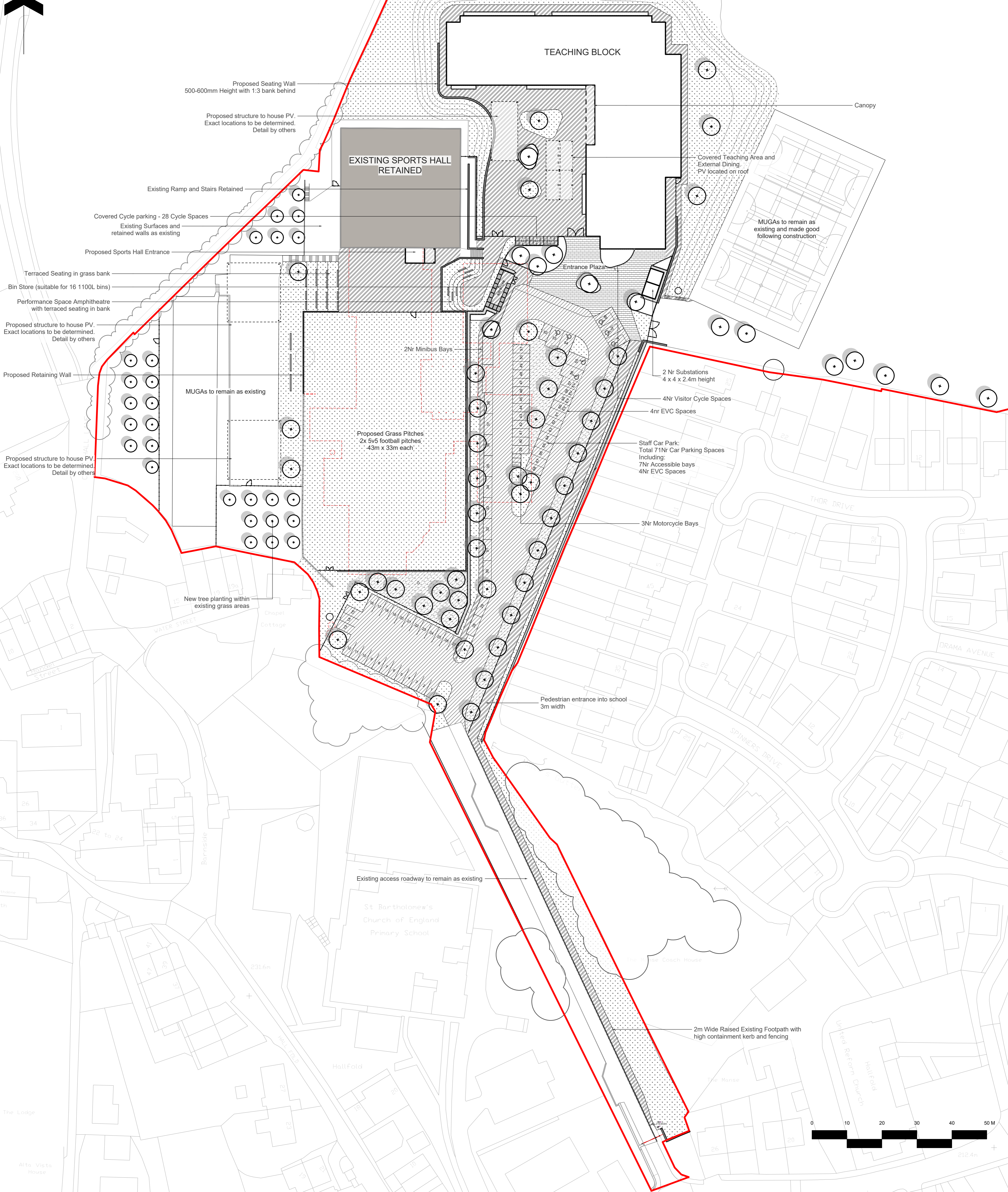

Notes
1. Do not scale from this drawing
2. To be read in conjunction with Project Risk Register REF: XXX
3. To be read in conjunction with all other Landscape Architect's drawings

| ID | RISK | MITIGATION | Date Mitigated |
|-------------------------------|------|------------|----------------|
| RESIDUAL PROJECT RISKS | | | |

KEY

Site

- Planning Application Boundary
- Proposed Level
- Existing Level
- Gradient
- Proposed Building
- Existing Building to be demolished
- Existing Tree
- Existing Tree to be removed

Planting

- Proposed Tree
- Grass Seed
- Amenity Planting

Paving

- Hedge Planting
- Swale Meadow Planting
- Pedestrian Macadam
- Vehicle Macadam
- Concrete Block Paving

Furniture

- Cycle Stands
- Covered Cycle Spaces
- Covered Canopy
- Existing Picnic Bench Relocated

Fencing and Structures

- Existing Fencing Retained
- Proposed Fencing
- Proposed Gates
- Retaining Wall
- Structure to house PV

| DATE | REV | DESCRIPTION OF REVISION | DRAWN BY | APPROVED BY |
|------------|-----|-------------------------------|----------|-------------|
| 20/04/2021 | P03 | Issued for Planning | AEK | SB |
| 25/03/2021 | P02 | Updated to latest road layout | HS | SB |
| 05/03/2021 | P01 | Issued for Draft CP's | HS | SB |

REVISIONS

STATUS
S2 - PLANNING

ares
LANDSCAPE ARCHITECTS

Ares Landscape Architects LTD
Caticrasher, 51 Eyre Lane, Sheffield S1 4RB
t: 0114 276 2000
e: hello@aresdesign.co.uk
w: ares.eu.com

CLIENT:
Wates

PROJECT TITLE:
Whitworth Community High School

DRAWING TITLE:
Landscape General Arrangement (Block Plan)

DRAWING SCALE: 1:500
PAPER SIZE: A1

DRAWN BY: HS
APPROVED BY: SB

DRAWN DATE: 15.02.2021
ALA PROJECT CODE: ALA663

DRAWING NUMBER: **WHS-ALA-00-XX-DR-L-0009**
STATUS: **S2**
REVISION: **P03**