

65 NORTHWAY

67 NORTHWAY

71 NORTHWAY

OUTBUILDINGS

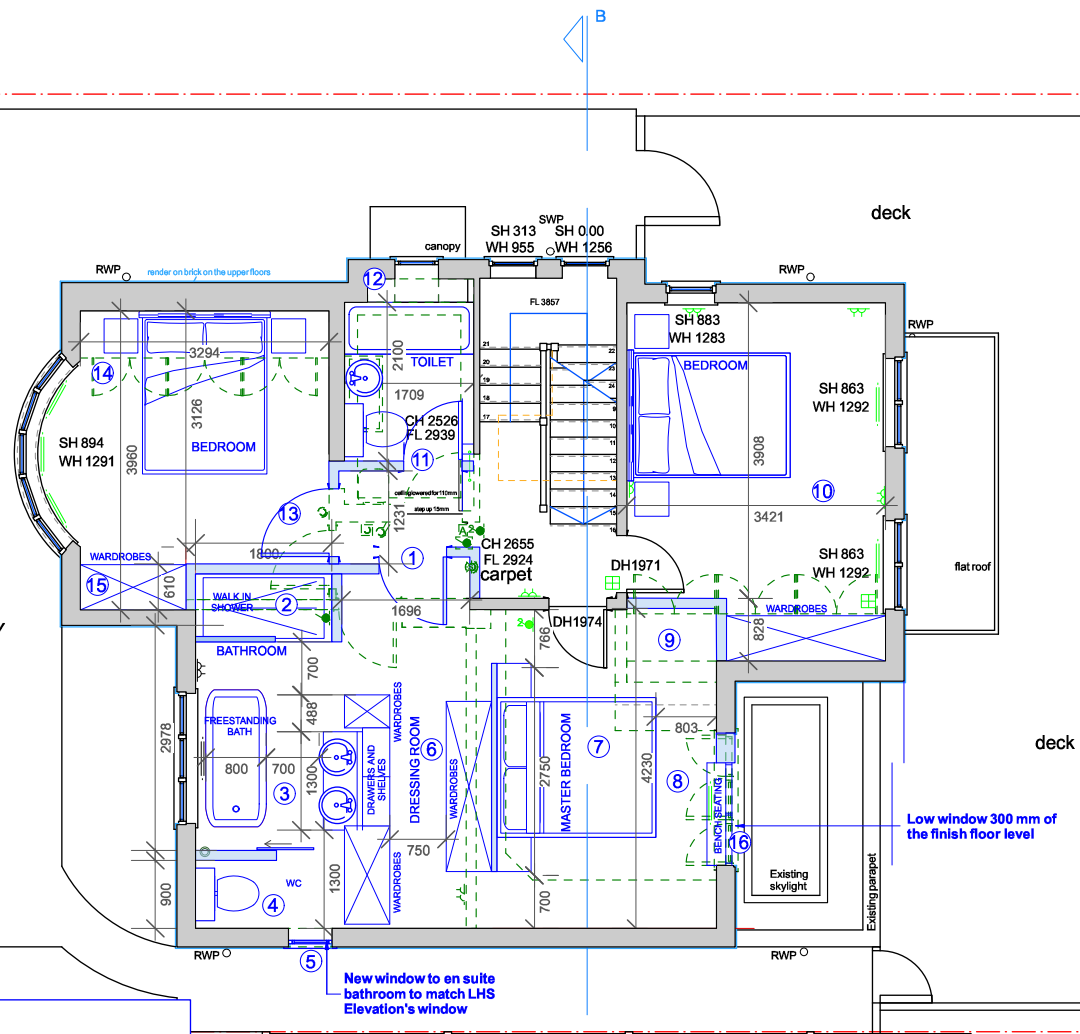

NOTES :

1. NEW DOOR AND AREA ADDED TO BEDROOM SPACE
2. NEW WALK IN SHOWER
3. NEW WASHBASIN AND FREESTANDING BATH
4. NEW WC AREA
5. NEW WINDOW
6. NEW DRESSING ROOM WITH CUPBOARDS
7. MASTER BEDROOM AREA
8. EXISTING WINDOW CHANGED INTO DOUBLE DOOR
9. NEW AREA ADDED TO BEDROOM SPACE
10. BEDROOM AREA REPOSITIONED, NEW WARDROBE ADDED
11. EXISTING BATHROOM REDUCED AND REARRANGED
12. EXISTING WALL BUILD UP SUBJECT TO SITE INVESTIGATION
13. NEW DOOR OPENING
14. EXISTING BEDROOM REARRANGED
15. NEW WARDROBES
16. LOW WINDOW, 300MM OF THE FINISH FLOOR LEVEL WITH BENCH SEATING ON THE INTERNAL SIDE

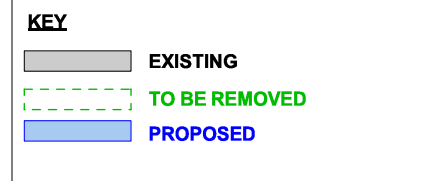

--- ASSUMED EXISTING BOUNDARY

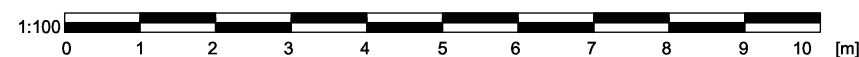

PROPOSED FIRST FLOOR PLAN

FOR HGST

REV.	DATE	DESCRIPTION	REV.	DATE	DESCRIPTION	REV.	DATE	DESCRIPTION	NOTE:	CLIENT:	PROJECT:	SIMON MILLER ARCHITECTS		DATE:	APRIL 2021
									FOR THE PURPOSE OF PLANNING ONLY DRAWINGS CAN BE SCALED OFF.	LOREN BERKOWITZ	INTERNAL AND EXTERNAL ALTERATIONS	T+44 (0)20 8201 9875		DRAWN BY:	AT
									ALL DIMENSIONS ARE IN MILLIMETERS. INCONSISTENCIES ARE TO BE REPORTED TO THE ARCHITECT IMMEDIATELY.	SITE:	DRAWING TITLE:	info@simonmillerarchitects.com simonmillerarchitects		SCALE:	1:100 @ A3
									COPYRIGHT IS HELD BY SIMON MILLER ARCHITECTS LTD.	67 NORTHWAY, LONDON, NW11 6PD	PROPOSED FIRST FLOOR PLAN	11 Portsdown Mews Temple Fortune London NW11 7HD		DRAWING NO.:	520 PL02
														REVISION:	-