

Location Plan  
1 : 200

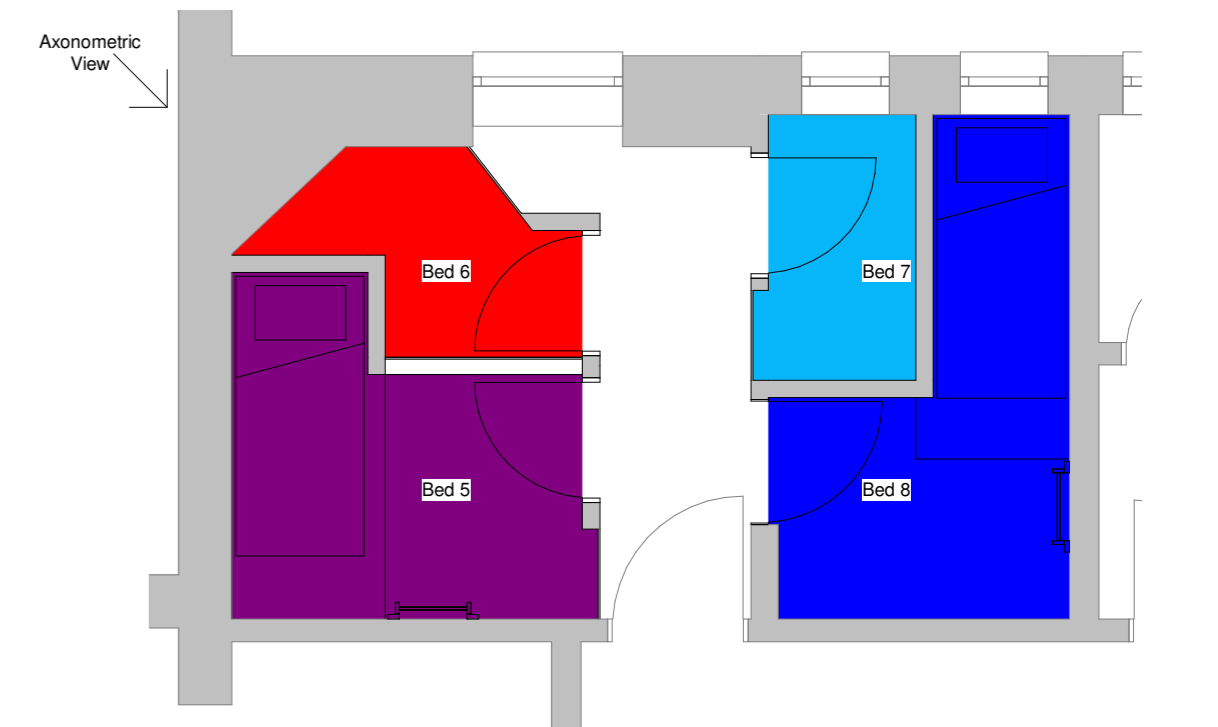

Room 2 Top Bunks (Cut 2000mm above Ground Floor Level)  
1 : 50

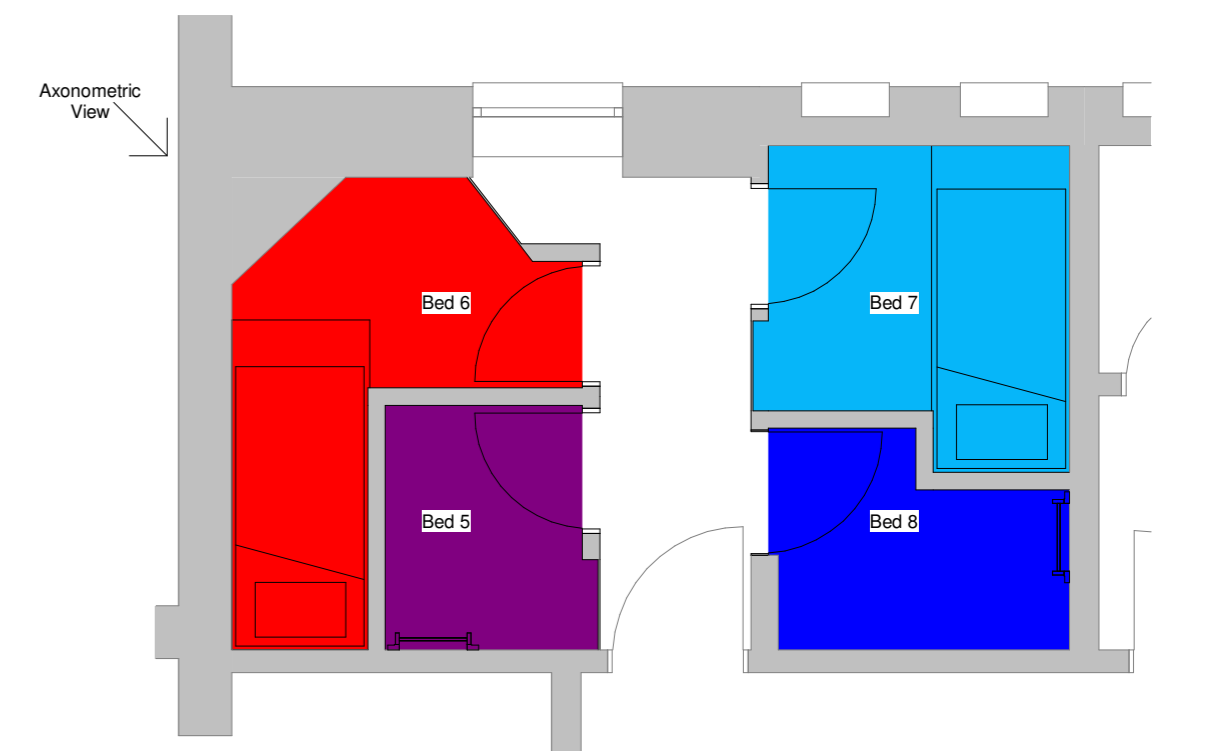

Room 2 Bottom Bunks (Cut 1000mm above Ground Floor Level)  
1 : 50

We have referred to the 'Hostel Accommodation Quality Standards' document using this as our guidance. In order to maximise the number of units we have taken the approach of providing self-contained bunks accessed from a central core which has natural light and ventilation. This has allowed us to provide eight self-contained pods, each bunk has a minimum of 2 metres floor space with full head height to allow for access and storage of belongings for the night.

In order to get the most amount of beds in, using the simple bunk bed structure with partitions allows double the number of available beds whilst dividing the spaces to conform to COVID-19 separation measures. With individual access to each bed space this will decrease the shared spaces between users and therefore prevent the spread of the virus.

Room One contains one large window, using this as a communal window allows for four beds to have access to the natural light and ventilation from this opening.

Room Two has three windows which allows for direct ventilation and natural light into two of the sleeping pods.

Pos	Rev	Date	Initial Issue	Note	KM	By

Falcon House | Eagle Road | Langage Business Park |  
Plympton | Plymouth | PL7 5JY  
01253 34977  
www.4darchitectsstudio.co.uk  
info@4darchitectsstudio.co.uk

Project title **Hamoaze House**  
Sheet Name **Room 2 Sleeping Pod Formation**  
Client **BCHA**  
Drawing Ref **2018-4DAS-DR-A-101-002** Scale @ Size As indicated @ A1  
Drawn By **KM**  
Approved By **LC**  
Revision **P01**  
Date **18 Sept 2019**



Do not scale for construction purposes from this drawing. ALL dimensions and levels to be checked on site and any discrepancies reported before work commences - if in doubt, PLEASE ASK.

This drawing is © Copyright of 4D Architects Studio Limited