

NOTES

GENERAL NOTES :-

ALL LEVELS ARE IN METRES DERIVED FROM GPS TRANSFORMATION.
THIS DRAWING HAS BEEN PRODUCED WITH A PLOT SCALE ACCURACY OF 1:50

BUILDING SURVEY KEY :-

- ⊘ - room height
- ⊘ - floor boards
- ⊘ - pipe diameter
- g/b - air brick
- ab - alarm box
- ah - arch head height
- bd - back drop
- bk - brick
- conc - concrete
- cr - cable riser
- db - door height
- ap - depth
- g/mtr - electricity metre
- elec - electricity
- f/p - fire place
- fh - floor to head height
- fl - floor level
- fs - floor to sill height
- g/mtr - gas metre
- gr - gas riser
- hr - heater
- hwt - hot water tank
- ic - inspection cover
- mb - manhole cover
- OSBM - Ordnance Survey bench mark
- q/dies - quarry tiles
- rad - radiator
- rw - rain water pipe
- sfc - soil filled chamber
- sh - floor to sill height
- sp - arch springing point
- sp - soil pipe
- susc - suspended ceiling
- svp - soil vent pipe
- Lr/cil - heated towel rail
- TBM - temporary bench mark
- tl - threshold level
- top - top of cap
- top - top of pipe
- tot - top of tank
- u/s - underside height
- UFL - unable to lift
- vp - vent pipe
- wf - water fountain
- wfc - water filled chamber
- wp - waste pipe

SERVICES KEY :-

- ⊘ - strip light
- ⊘ - light
- ⊘ - wall light
- ⊘ - emergency light
- ⊘ - spot light
- ⊘ - pull cord
- ⊘ - vent/extractor
- ⊘ - switch
- ⊘ - light switch
- ⊘ - fused switch
- ⊘ - isolator switch
- ⊘ - cooker switch
- ⊘ - fuse
- ⊘ - blank socket
- ⊘ - single socket
- ⊘ - double socket
- ⊘ - ceiling socket/luse/switch
- ⊘ - thermostat
- ⊘ - card access point (swipe card)
- ⊘ - emergency door release
- ⊘ - alarm keypad
- ⊘ - intercom
- ⊘ - alarm control panel
- ⊘ - speaker
- ⊘ - projector
- ⊘ - closed circuit tv
- ⊘ - sensor
- ⊘ - network point
- ⊘ - coaxial aerial
- ⊘ - smoke detector
- ⊘ - heat detector
- ⊘ - fire alarm siren
- ⊘ - fire breakglass
- ⊘ - fire sprinkler
- ⊘ - fire blanket
- ⊘ - water fire extinguisher
- ⊘ - co2 fire extinguisher
- ⊘ - powder fire extinguisher
- ⊘ - fire extinguisher
- ⊘ - fire alarm control panel

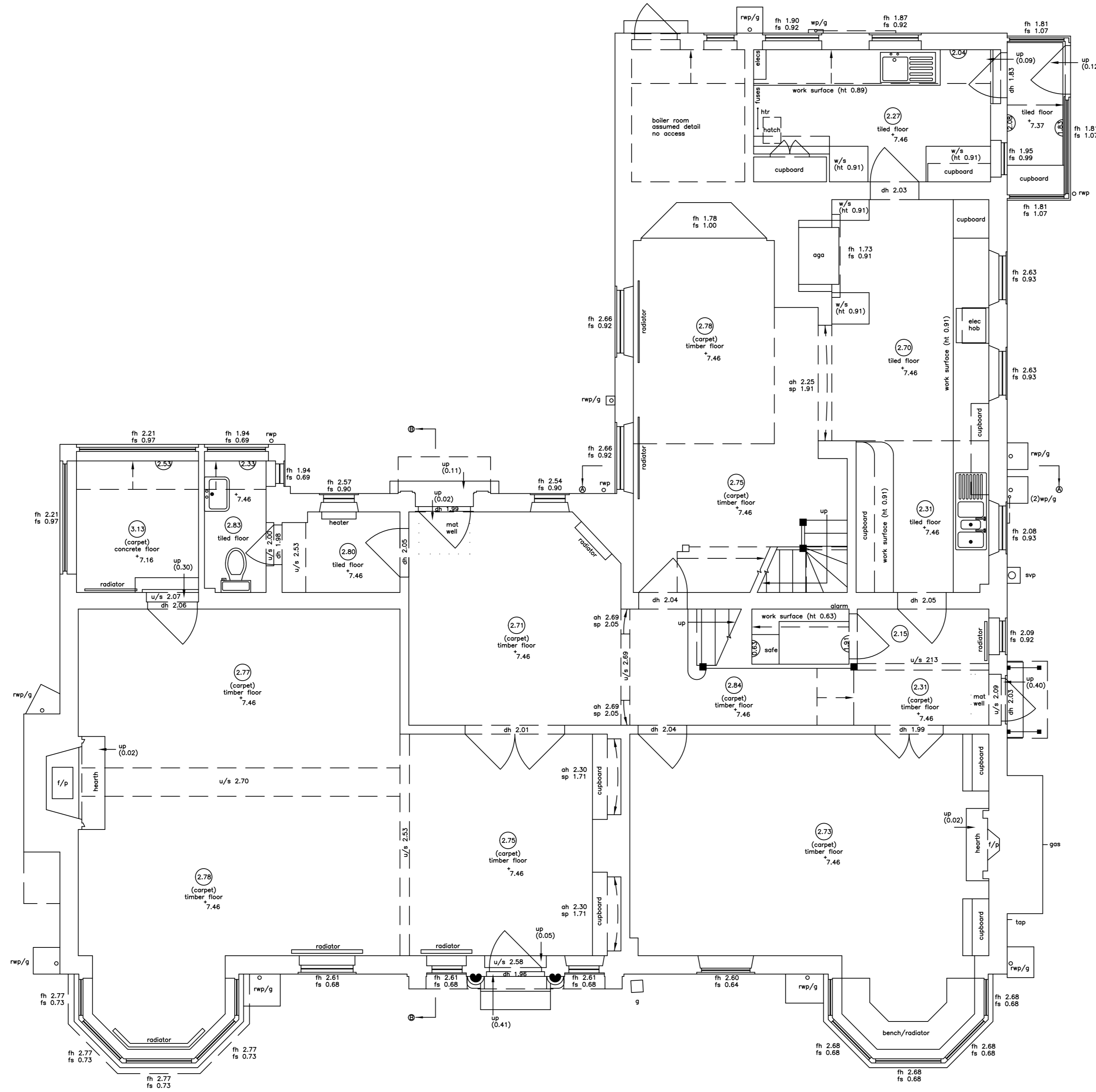

GROUND FLOOR

NORTH POINT :-



MIDLAND SURVEY LTD

HEAD OFFICE
Cromwell House, Westfield Road, Southam, Warwickshire, CV47 0JH.
Tel: 01926 810811 Fax: 01926 810812
E-Mail: mail@midlandsurvey.co.uk
www.midlandsurvey.co.uk

Client	MR & MRS O'SULLIVAN
Project	APULDRAM HOUSE, DELL QUAY ROAD, CHICHESTER, WEST SUSSEX, PO20 7EE
Title	GROUND FLOOR PLANS
Date	OCTOBER 2020
Scale	1:50BA1
Dwg No	H1416 - 3
Surveyor	S.A.M
Checked	L.G.G

TOPOGRAPHICAL (LAND) SURVEYORS / UTILITY SURVEYORS
BUILDING MEASUREMENT SURVEYORS / 3D LASER SCANNING



© Copyright Midland Survey Ltd. Reproduction of this information is prohibited without written authorisation from Midland Survey Ltd.