

Revision Schedule

Number	Description	Date
--------	-------------	------

Handrail/protective barriers
 900mm high handrail to flight. Handrail returned & extended by 300mm
 1100mm high balustrade at landing
 Refer to Drg.No.1276-304 for details of handrail, balusters etc.

Landing:
 Insitu concrete grade C35 RC landing slab with 1 No. layer of A393 mesh laid centrally, 140mm, thick cast with non slip finish on shutter with reinforcement. Void between supporting brickwork to infilled with Type 1 hardcore.
 P.C. step to be cast into the line of the flight as a top step, edges to be cast with a 10mm overhang on 225mm supporting brick walls below (facing brickwork to all exposed faces). DPC in brickwork laid below level of landing and 150mm above finished ground level.

P.C. Concrete Steps: SINGLE DWELLINGS
 900mm overall width
 250mm going
 150mm rise
 25mm nosing
 Steps - 285mm treads, 140mm high, 900mm long

P.C. Concrete Steps: MORE THAN 1 No. DWELLING
 1200mm overall width
 250mm going
 150mm rise
 25mm nosing
 Steps - 285mm treads, 140mm high, 1200mm long

Proposed Rear Elevation - steps

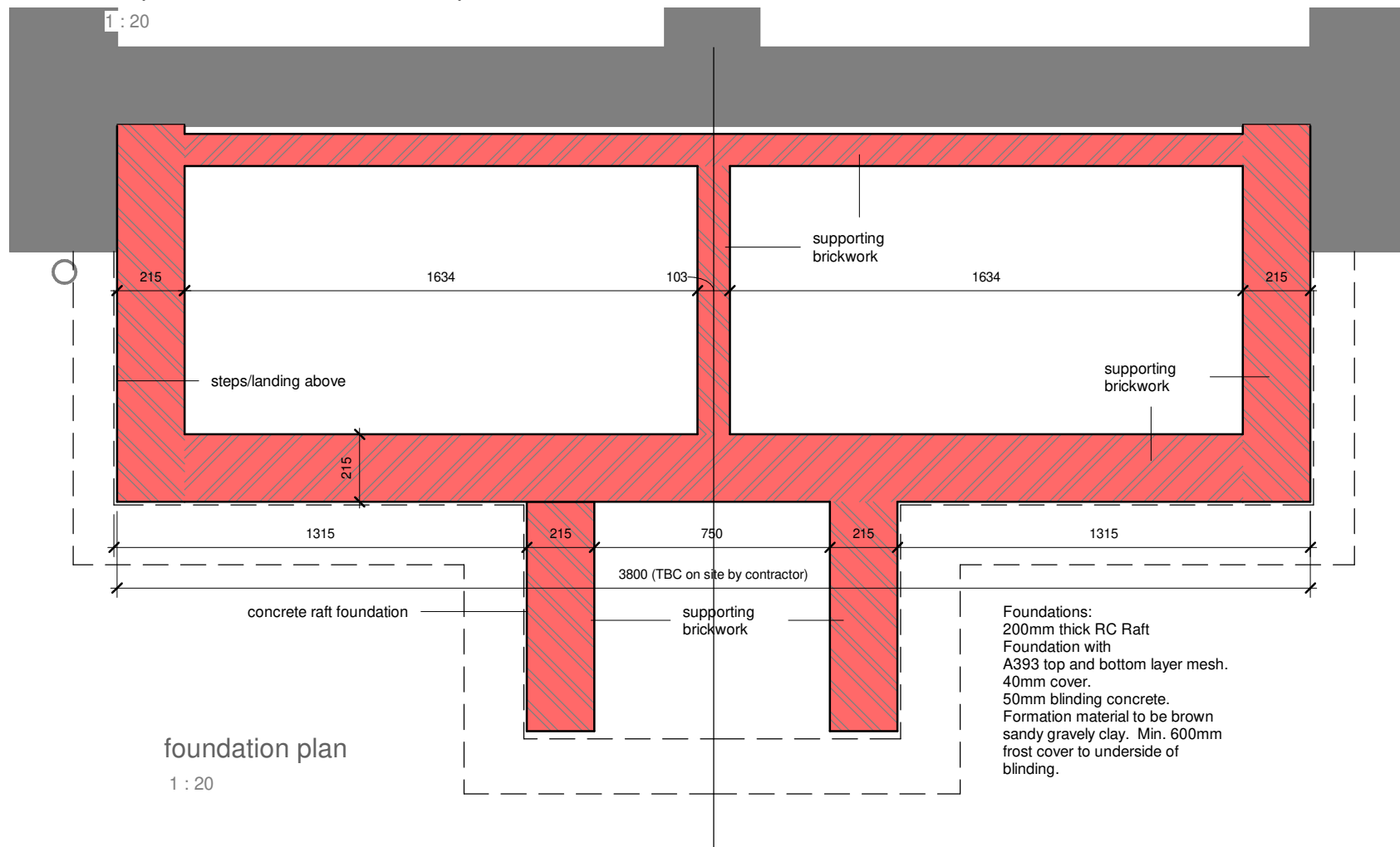

Proposed side elevation - steps

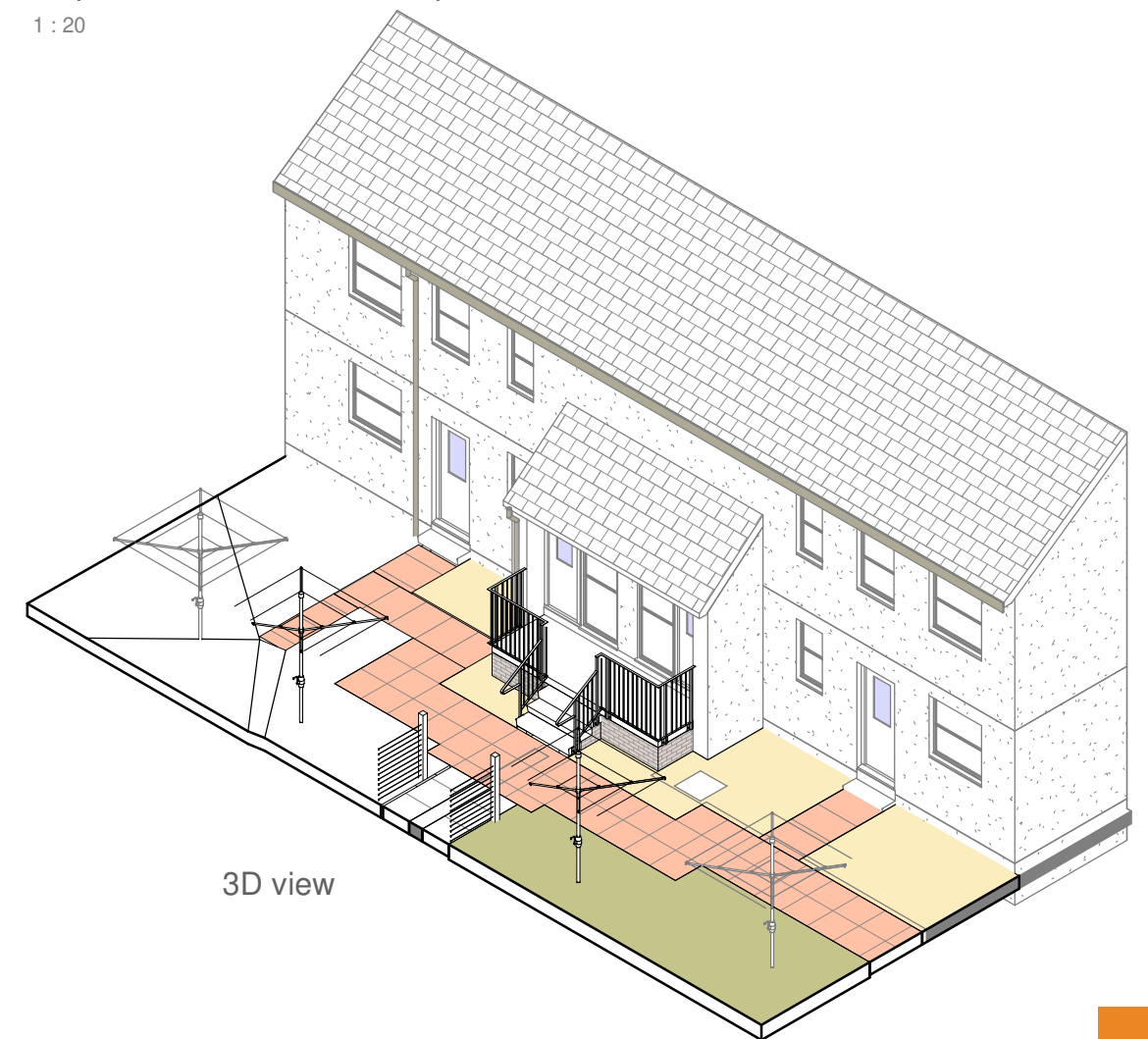

planning application