

Rear Elevation - Proposed

dormer to be repositioned
existing tiles and ridge tiles to
be re-used and existing window
to be retained



notes

use figured dimensions only.
copyright of design and drawing reserved.
all dimensions must be confirmed on site prior
to any construction work being undertaken
setting out to be approved before fabrication.
* indicates site dimension.
** indicates a critical dimension.

revision

x.

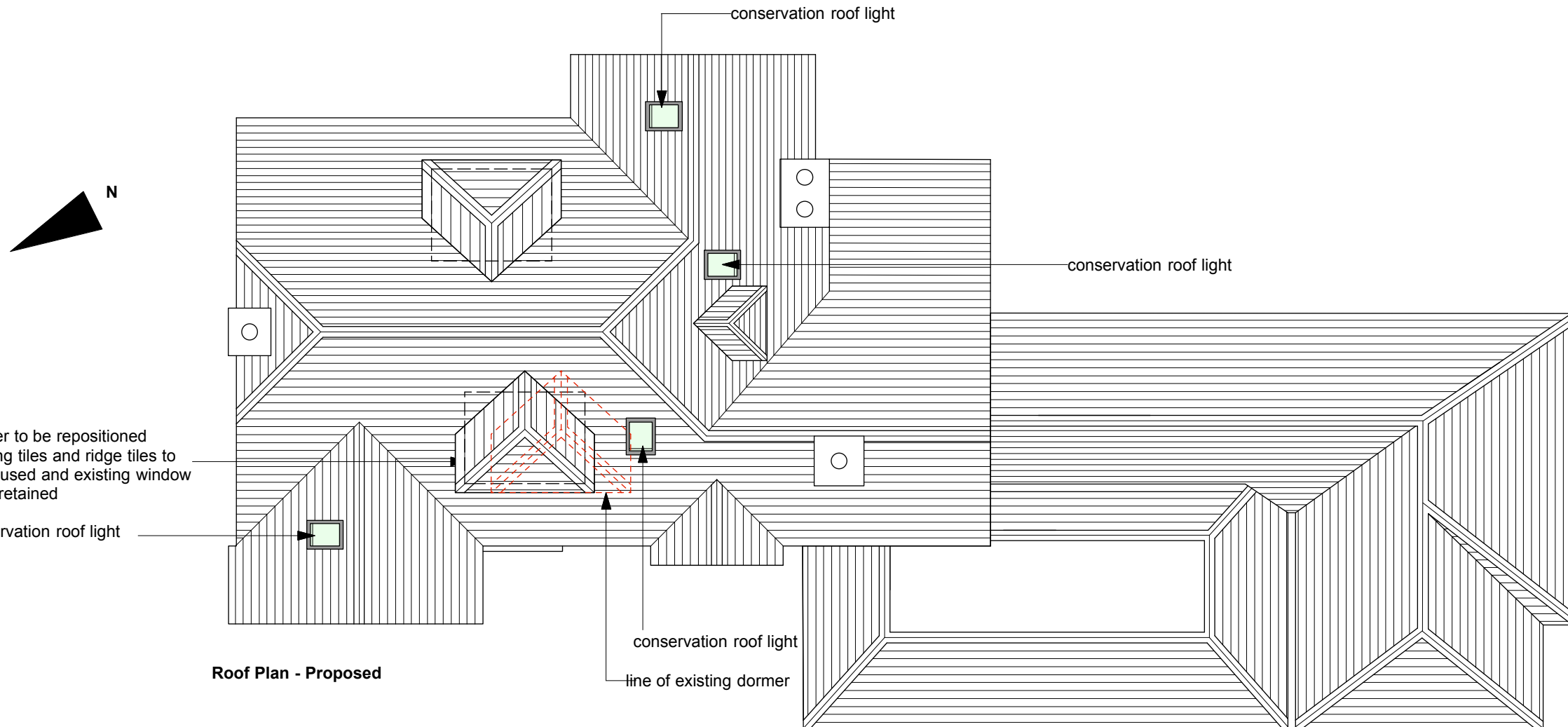

Roof Plan - Proposed

dormer to be repositioned
existing tiles and ridge tiles to
be re-used and existing window
to be retained

conservation roof light



dnkdesign

client Mr & Mrs Sorsky

project The Close
Barnet Lane
N20 2AP

title Planning Proposed Plan
& Rear Elevation

drawing N° **SO02.51** rev .

drawn by nh date Feb 20

scale 1:100 @ A3

interior design consultants
18 burrard road london nw6 1db
t 020 7813 2945 f 020 7813 0609
e info@dnkdesign.co.uk