

EXISTING 3D VIEW (FROM JUNCTION OF RUSHMORE HILL/RANDES LANE)

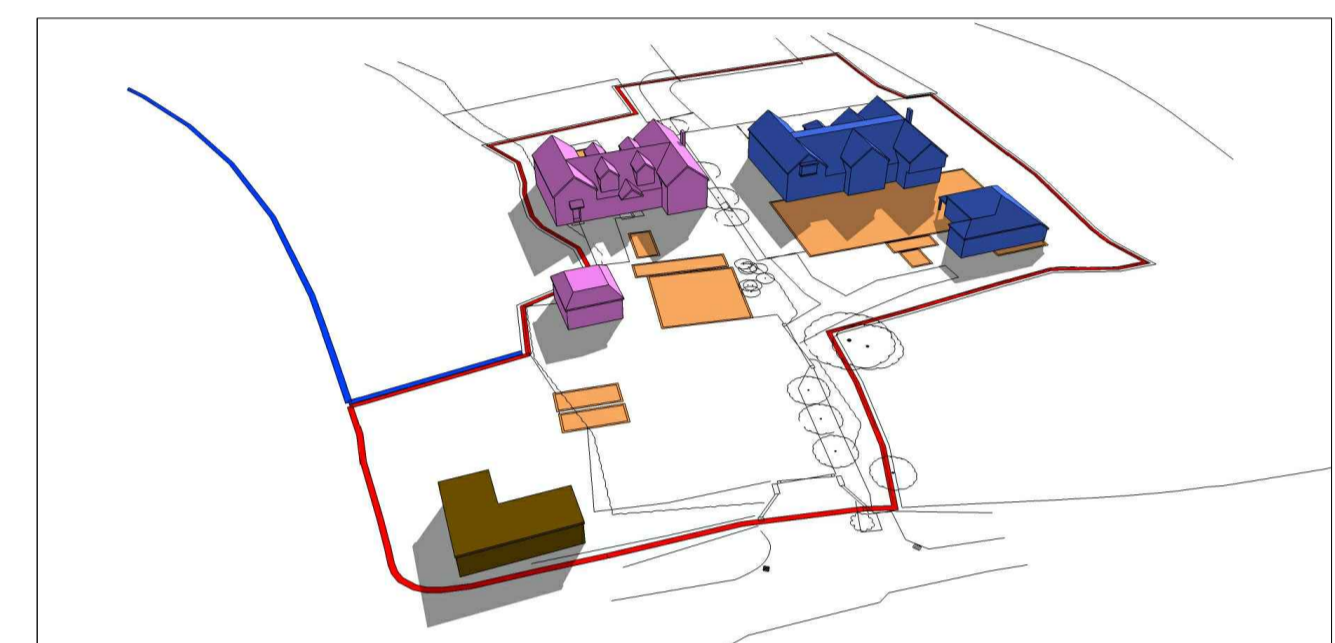

PROPOSED 3D VIEW (FROM JUNCTION OF RUSHMORE HILL/RANDES LANE)

CALCULATIONS

Existing Calculations			
Building	Footprint (m ²)	Volume (m ³)	Status
Unit 1	325.28	1587.58	DEMOLISH
Unit 2	275.40	1438.97	DEMOLISH
Unit 3	56.78	187.75	DEMOLISH
Unit 4	86.80	300.70	DEMOLISH
Unit 5	12.50	26.30	DEMOLISH
Unit 6	24.30	78.50	DEMOLISH
Unit 7	15.40	42.70	DEMOLISH
Unit 8	11.40	30.60	DEMOLISH
Unit 9	7.20	18.30	DEMOLISH
Unit 10	14.80	37.10	DEMOLISH
Unit 11	14.80	37.10	DEMOLISH
Total Existing	844.66	3785.60	

Proposed Calculations			
Building	Footprint (m ²)	Volume (m ³)	Status
Office Block	56.00	143.88	PROPOSED
Garage 1	87.50	265.80	PROPOSED
House 1	234.50	1173.18	PROPOSED
Garage 2	34.50	120.14	PROPOSED
House 2	183.30	918.82	PROPOSED
Total Proposed	595.80	2621.82	

Totals			
Totals	Footprint (m ²)	Volume (m ³)	
Total Existing Retained	0.00	0.00	
Total Existing Demolished	844.66	3785.6	
Total Proposed	595.80	2621.82	

Total Difference			
Total Difference	Footprint (m ²)	Volume (m ³)	
Difference (Between Demolished & Proposed)	-248.86	-1163.78	

P5	AW	Clients Comments Noted	22/2/21
P4	AW	Clients Comments Noted	2/2/21
P3	AW	Clients Comments Noted	6/1/21
P2	JB	Clients Comments Noted	20/11/20
P1	JB	Issued for Comment	13/11/20
Rev:	Description:	Date:	

Date: **26/10/20** Scale @A1: **1:200**

Project: **Closeheath Farm
Randles Lane
Knockholt
TN14 7NJ**

Title: **Proposed Replacement Dwellings**

Drawing No: **3402-19-PL202** Revision: **P5**

crofton design services limited

2-3 Rice Parade, Fairway,
Petts Wood, Kent. BR5 1EQ

01689 836855
design@croftondesign.co.uk
© CDS Ltd. 2020

www.croftondesign.co.uk