

1  
103  
1:100 PROPOSED HQ - SECOND FLOOR PLAN  
PROPOSED

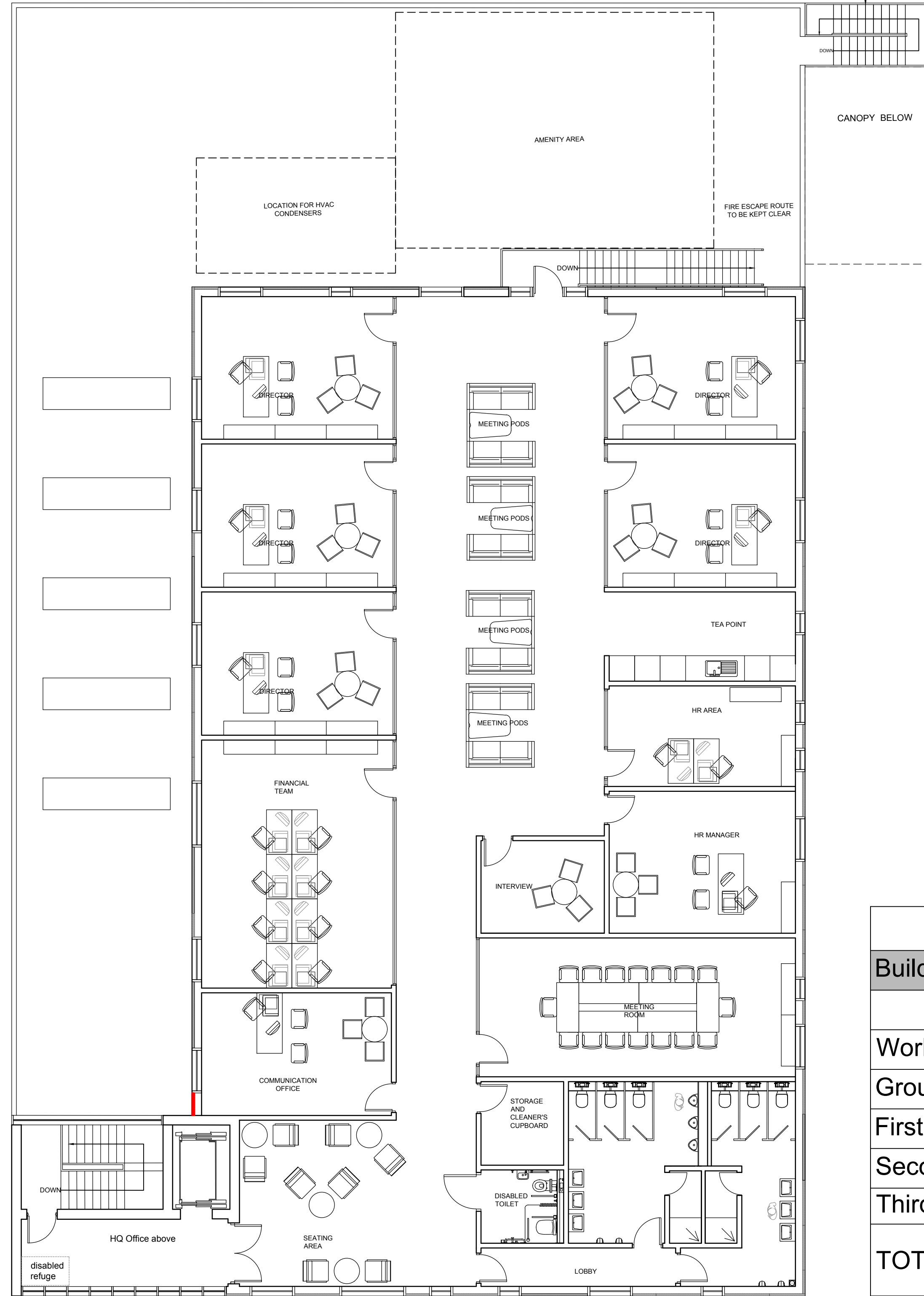

2  
103  
1:100 PROPOSED HQ - THIRD FLOOR PLAN  
PROPOSED

GIA	
Building Footprint	1011 m <sup>2</sup>
Workshop	574 m <sup>2</sup>
Ground Floor (Offices)	383 m <sup>2</sup>
First Floor (Offices)	422 m <sup>2</sup>
Second Floor (HQ)	608.3 m <sup>2</sup>
Third Floor (HQ)	608.3 m <sup>2</sup>
<b>TOTAL</b>	<b>2600 m<sup>2</sup></b>

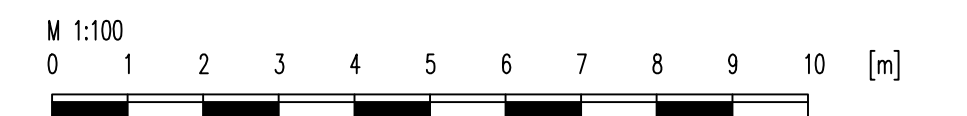

Notes:  
 Copyright of this drawing remains the property of Atelier iad Ltd and should not be reproduced in full or parts or re-issued without written permission from Atelier iad Ltd  
 All dimensions shown are in millimetres, unless otherwise stated. Any use of these dimensions, other than for general reference, should be the subject of third party checking on site.  
 Any work that is carried out on the basis of this drawing should be carried out to all relevant British Standards and associated manufacturer's instructions / recommendations.

Rev: 1 Date: 14.05.21 Description: Scale Bar Added

Project Number: 20 002  
 Drawing Number: P103

Rev: 01  
 Scale: 1:100@A1  
 Date: 22.01.2021

Site Address: CONWAY STREET, HOVE

Title: PROPOSED WORKSHOP - SECOND AND THIRD FLOOR PLANS

