

1 1:200 CONWAY STREET PLANTING
703 PROPOSED

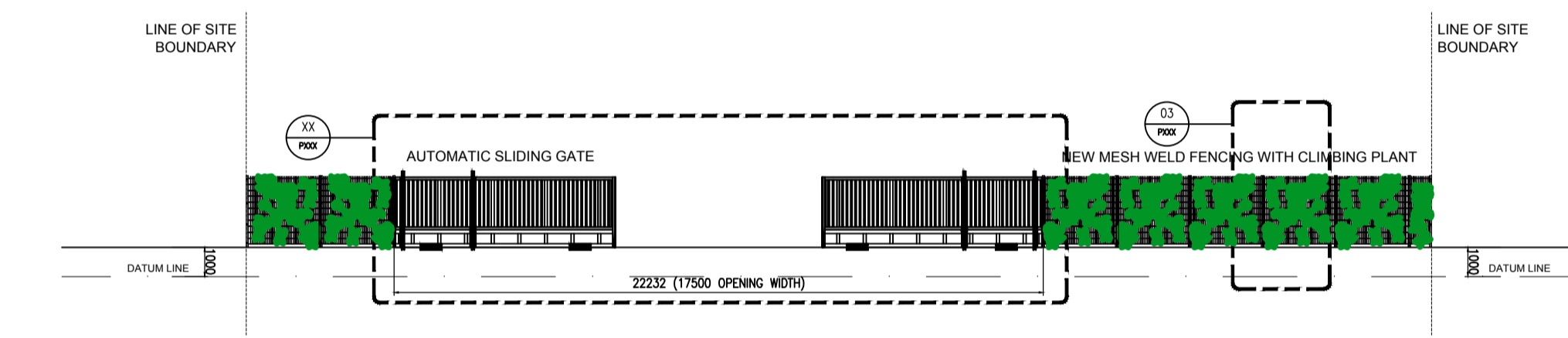

2 1:200 GOLDSTONE ROAD PLANTING
703 PROPOSED

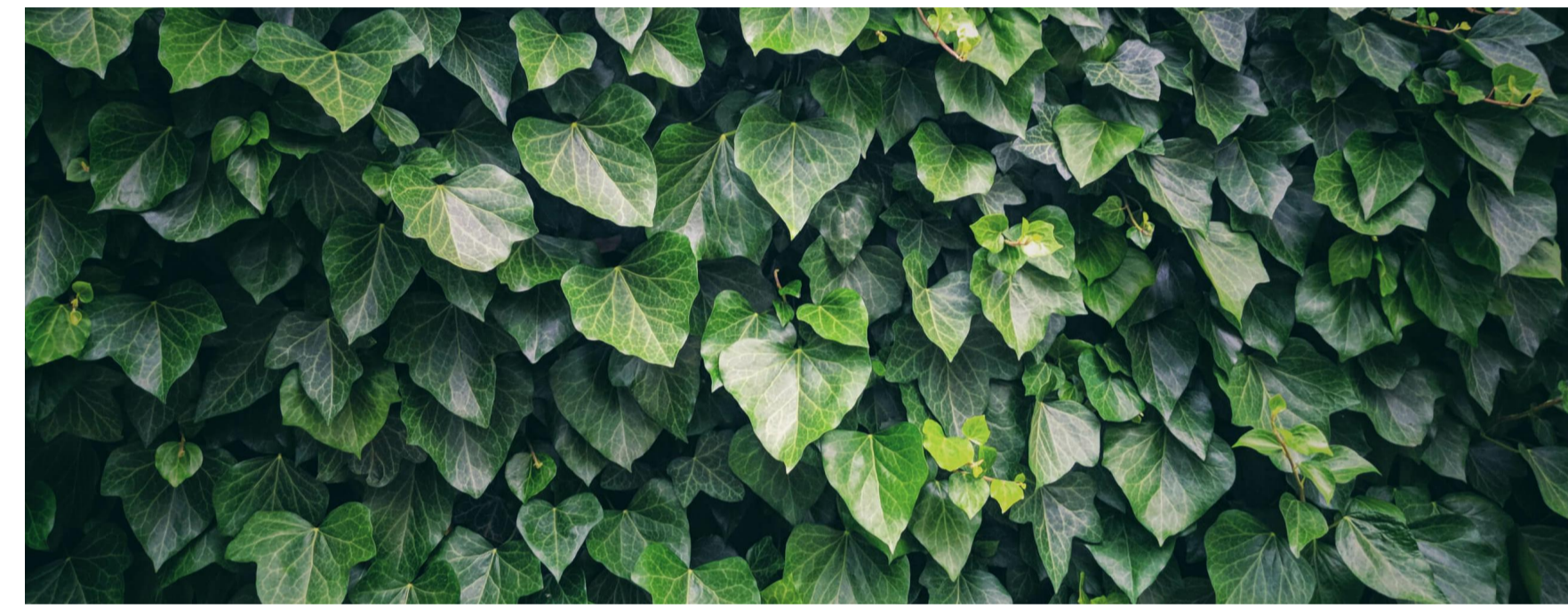

3 NTS IMAGE OF MATURE PLANTING
703 PROPOSED

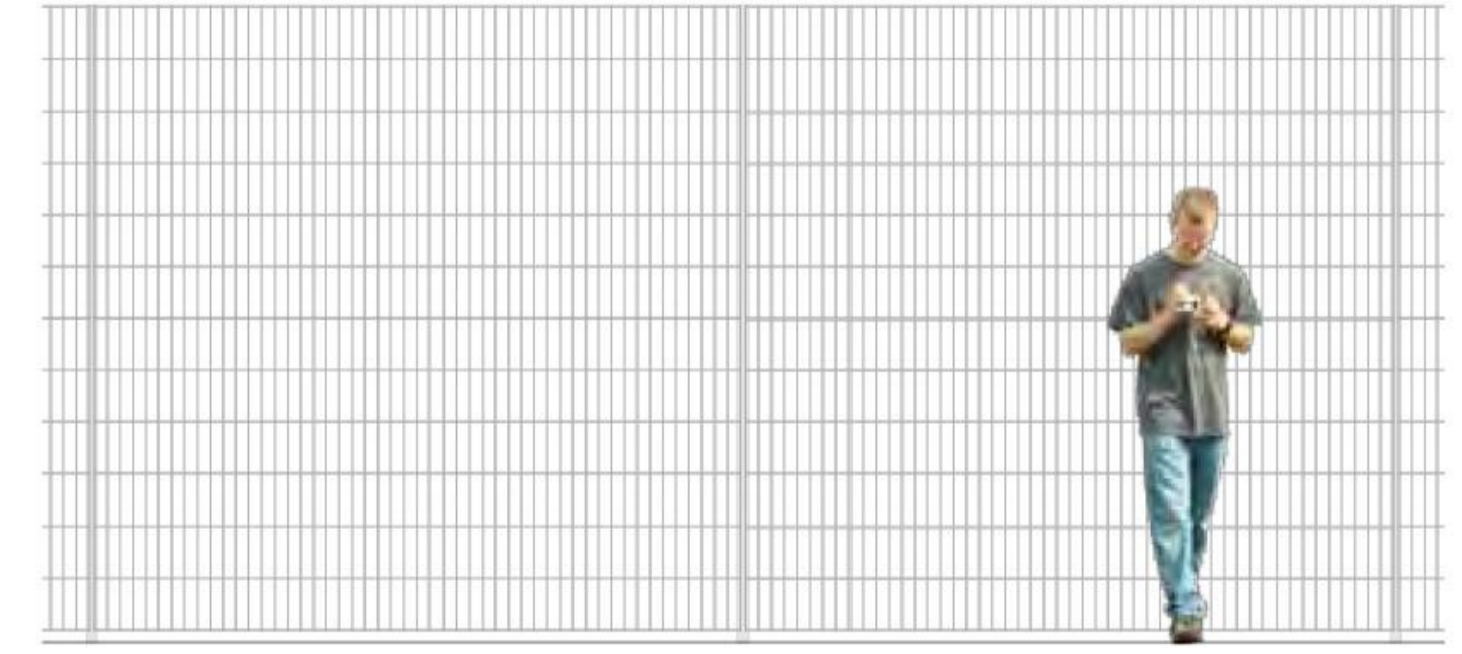

4 NTS IMAGE OF BOUNDARY MESH FENCING
703 PROPOSED



Hedera helix 'Woerner'
Very strong winter hard ivy, 4-6 cm large dark green leaves, variable leaf shapes. In winter, slightly changes colour to reddish-brown. Evergreen.



Pyracantha 'Dart's Red'
Winter hardy Firethorn with red (non-poisonous) berries. Rich blooming with white umbrella-shaped flowers in spring. This strain is resistant to fire blight. Keeps leaves in winter. Suitable as a defensive plant.

5 NTS PLANTING SPECIFICATION
703 PROPOSED

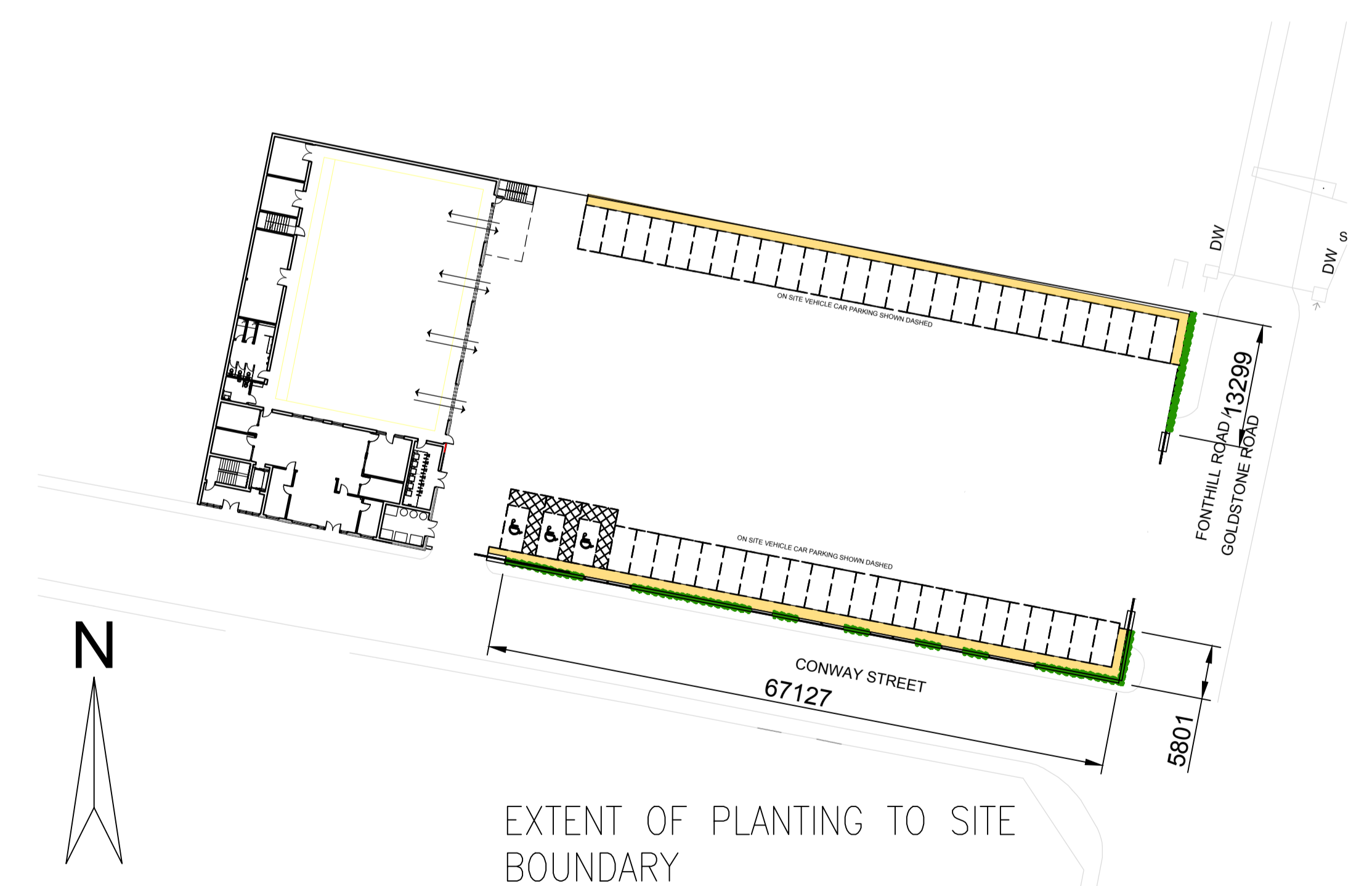

6 1:500@A1 LOCATION PLAN
703 PROPOSED

Notes:
Copyright of this drawing remains the property of Atelier iad Ltd and should not be reproduced in full or parts or re-issued without written permission from Atelier iad Ltd
All dimensions shown are in millimetres, unless otherwise stated. Any use of these dimensions, other than for general reference, should be the subject of third party checking on site.
Any work that is carried out on the basis of this drawing should be carried out to all relevant British Standards and associated manufacturer's instructions / recommendations.

| Rev | Date | Description |
|-----|------|-------------|
| - | - | - |

Project Number:
20 002
Drawing Number:
P 703

Rev
00
Scale
NTS@A1
Date
22.01.2021

Site Address:
CONWAY STREET,
HOVE

Title:
PROPOSED
PLANTING DETAIL

