

ALL ELEVATIONS ARE VIEWED FROM OUTSIDE UNLESS OTHERWISE STATED.

CONTRACT NUMBER: P-21015

Mill Orchard

Criffins

Existing access
New brick wall to match existing
DRIVESETT TEGULA PAVING
New Pillar and Gate set back

Existing Brick boundary wall. Low level

Existing Garden Fountain

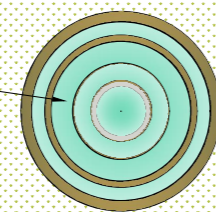

Gravel Drive

Existing Parking

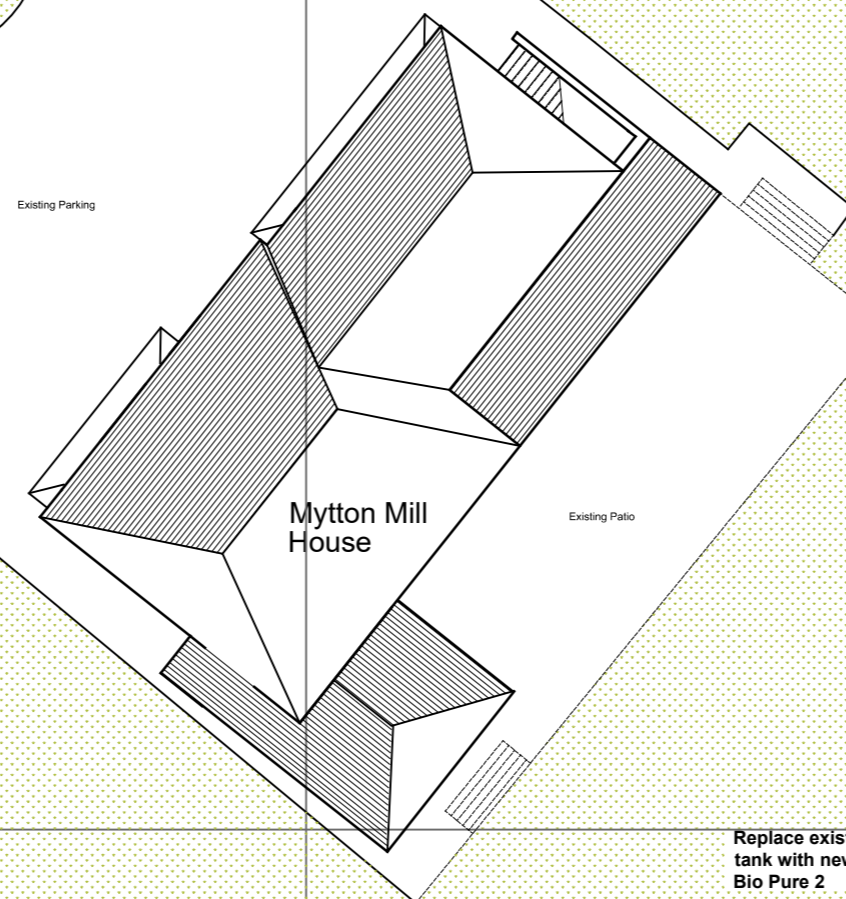

Mytton Mill House

Existing Patio



Replace existing Septic tank with new Bio Disk. Bio Pure 2

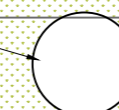

4

© Crown copyright 2021 Ordnance Survey 100053143

REV	DATE	COMMENTS

CONTRACT :

Mytton Mill House, Forton Heath,
Montford Bridge, Shrewsbury
SY4 1HA

PENN ARCHITECTURAL

26 Main Road, Ketley Bank,
Telford. TF2 0DH

Tel : 01952 375394
Email : info@pennarchitectural.co.uk
Website : www.pennarchitectural.co.uk

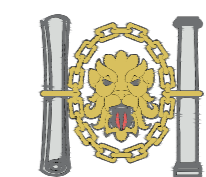

Chartered Institute of
Architectural Technologists
Registered Practice

DRAWING TITLE :

Block Plan

SCALE A2 1:200	DRAWING ISSUE STATUS Planning
-------------------	----------------------------------

DRAWN N.P.	DRAWING No.	REV
DATE 01.04.2021	MMH-009	.