

Proposed Roof Plan  
Scale 1:200

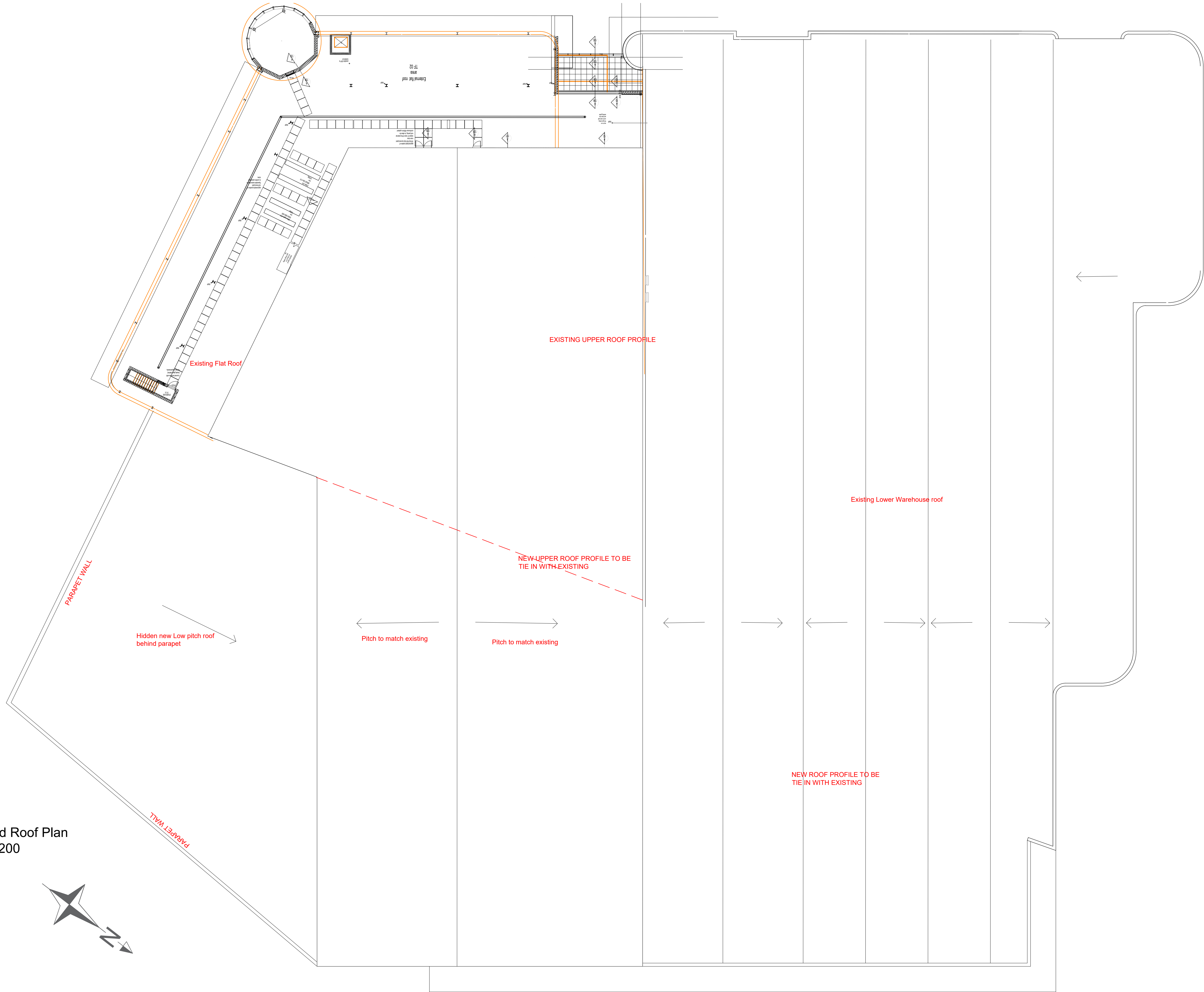
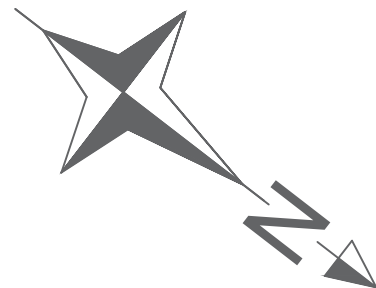

## Planning

**LINDUM** Construction

Lindum Business Park, Station Road  
North Hykeham, Lincoln LN6 5QX  
Tel: (01522) 500300  
Fax: (01522) 862211  
E-Mail: construction@lindumgroup.co.uk

Client:  
Ken Wilkins Print

Project:  
Proposed Factory Extension  
And Associated Parking,  
Colwick Ind. Est. Private Road  
No. 1, Nottingham

Drawing Title:  
Proposed Roof Plan

Date:  
Oct 2020

Scale:  
1:200 @ A1

Drawn By:  
SWC

Client Ref:

Drawing Number:  
20036 - 110

Revision:  
-