

© This drawing and design are copyright.
 Do not scale from this drawing. Use only figured dimensions. If in doubt, ask.
 All dimensions are to be checked on site.
 Any discrepancies should be reported immediately to the Architect.

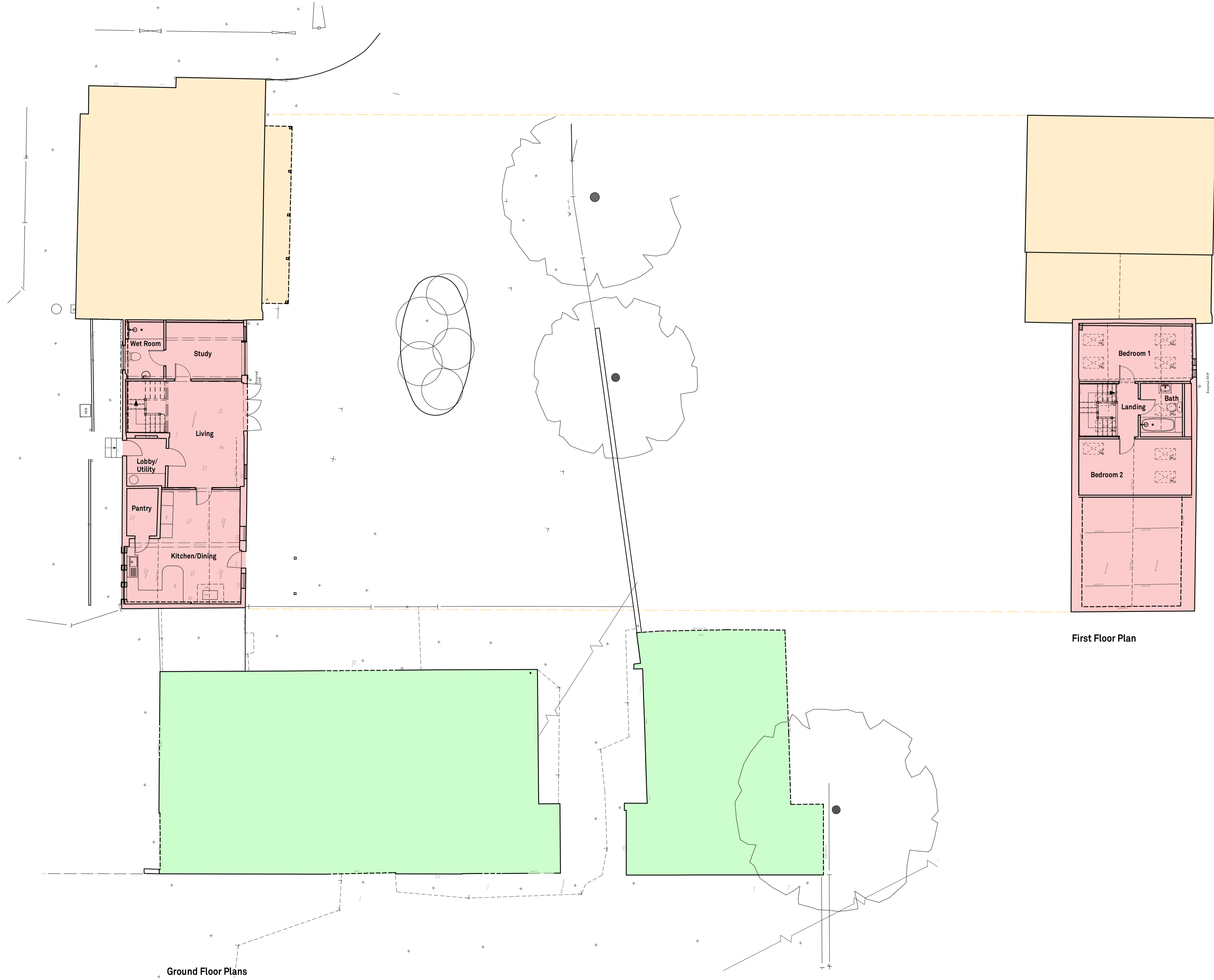

First Floor Plan

Ground Floor Plans

- Building 1
- Unit 1 - Previously approved for segregation retained under application ref. DC/19/03930
- Buildings 3 & 4 - Barn Conversions as approved under application ref. DC/20/02961

DATE	REV.	DESCRIPTION	DRAWN

PatrickAllen&Associates Architects
 architects@patrickallen.org.uk | 2 Grange Business Centre
 www.patrickallen.org.uk | Tommy Flowers Drive
 +44 (0)1473 820660 | Grange Farm
 Kesgrave, Ipswich
 Suffolk, IP8 2BY

Project
Proposed Development at Grove Farm, Stonham Aspal, IP14 6BX

Client
Andrew Newman

Drawing Title
As Existing Plans Building 1, 3 & 4

Drawing Status
Planning

Scale	Paper Size	Date	Drawn
1:100	A1	Feb 21	--

Drawing Number
4024-54

© 2021 Patrick Allen & Associates Limited | Registered No: 4694261

