

Proposed Plans

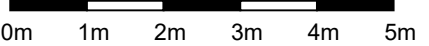

Scale 1:100 @ A3

Existing Dormer Bungalow 1st Floor

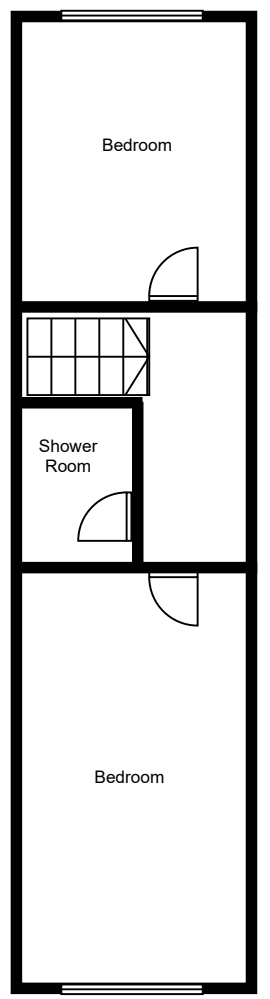

Existing Dormer Bungalow Ground Floor



Total Build Area
 =
 Summer Room +
 10.5m section +
 8.5m section (incl
 converting garage)
 =
 11.5 sq.m +
 52.5 sq.m +
 25.5 sq.m
 =
 90 sq.m

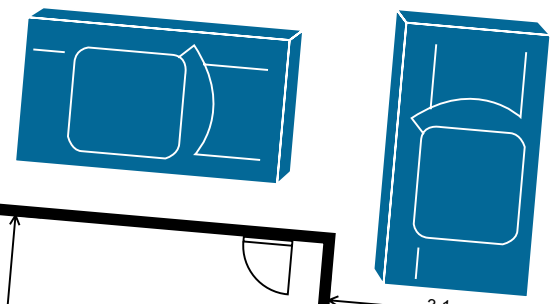

3.5m x 3.2m
 = 11.5 sq.m

10.5m x 5m
 = 52.5 sq.m

8.5m x 3.1m
 = 25.5 sq.m

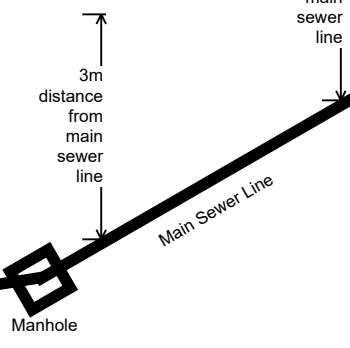

South Side

North Side

Front

Rear

Main Sewer Line

Main Sewer Line

Manhole