

NORTH

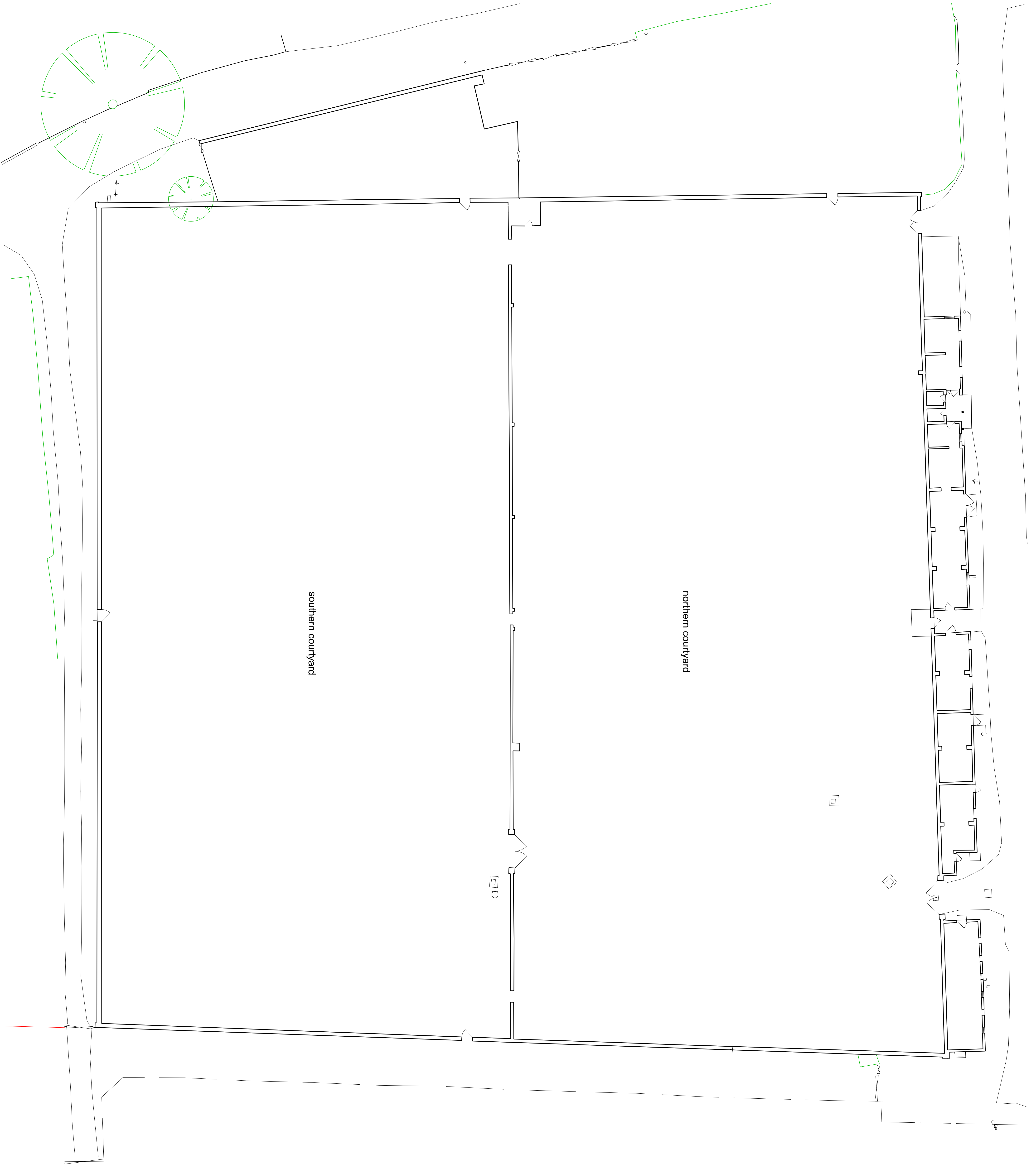

Thurlow Nunn Standen Ltd
Specialist Installations Division



Existing Plan

Project: Proposed Garden Centre
The Court Yard, Evesdon Estate
Client: Evesdon Farms Ltd

Dwg: 21 1720 SURV1 **Revision:** -
Date: March 2021 **Scale:** 1:200 @A1

The Studio
Dunstable, Bedfordshire
Kempston Way
Sulley B22 7AR
Tel: 01294 729166
Email: info@reespyer.co.uk

**Rees
Pyper**
ARCHITECTS

Do not scale from drawing. Any dimensions or details to be reported to the Authority. Complete details shall be submitted to the Authority for approval. The Authority shall not be held responsible for any errors or omissions in this drawing. The drawing is the property of the Architect and shall not be used for any other purpose without the written consent of the Architect. The Architect shall not be held responsible for any errors or omissions in this drawing. The drawing is the property of the Architect and shall not be used for any other purpose without the written consent of the Architect.