



THIS DRAWING IS COPYRIGHT © ALL DIMENSIONS TO BE CHECKED ON SITE PRIOR TO COMMENCEMENT OF WORK. GHM PARTNERSHIP TO BE NOTIFIED OF ANY OMISSIONS OR ERRORS. THIS DRAWING IS NOT TO BE SCALED.  
 GHM PARTNERSHIP CANNOT BE HELD RESPONSIBLE FOR THE ACCURACY OF INFORMATION PRODUCED BY OTHERS FOR THE PURPOSES OF PRODUCING OUR DRAWINGS. E. TOPOGRAPHICAL SURVEYS AREA MEASUREMENTS ARE PROVIDED FOR INFORMATION ONLY. ANY VERIFICATION OF MEASUREMENTS SHOULD BE SOUGHT FROM A SUITABLY QUALIFIED SURVEYOR. GHM PARTNERSHIP CANNOT BE HELD RESPONSIBLE FOR THE ACCURACY OF COMPUTER SOFTWARE USED TO DETERMINE MEASUREMENTS.

DO NOT SCALE - ASK FOR DIMENSION  
 USE ONLY FOR PURPOSE INDICATED BELOW

**Key**

-  Legal Ownership Line  
 Red line indicates approximate extent of ownership, refer to Land Registry Title Plans and Deeds  
 Land Registry Title No. MX355903
-  Extent of works

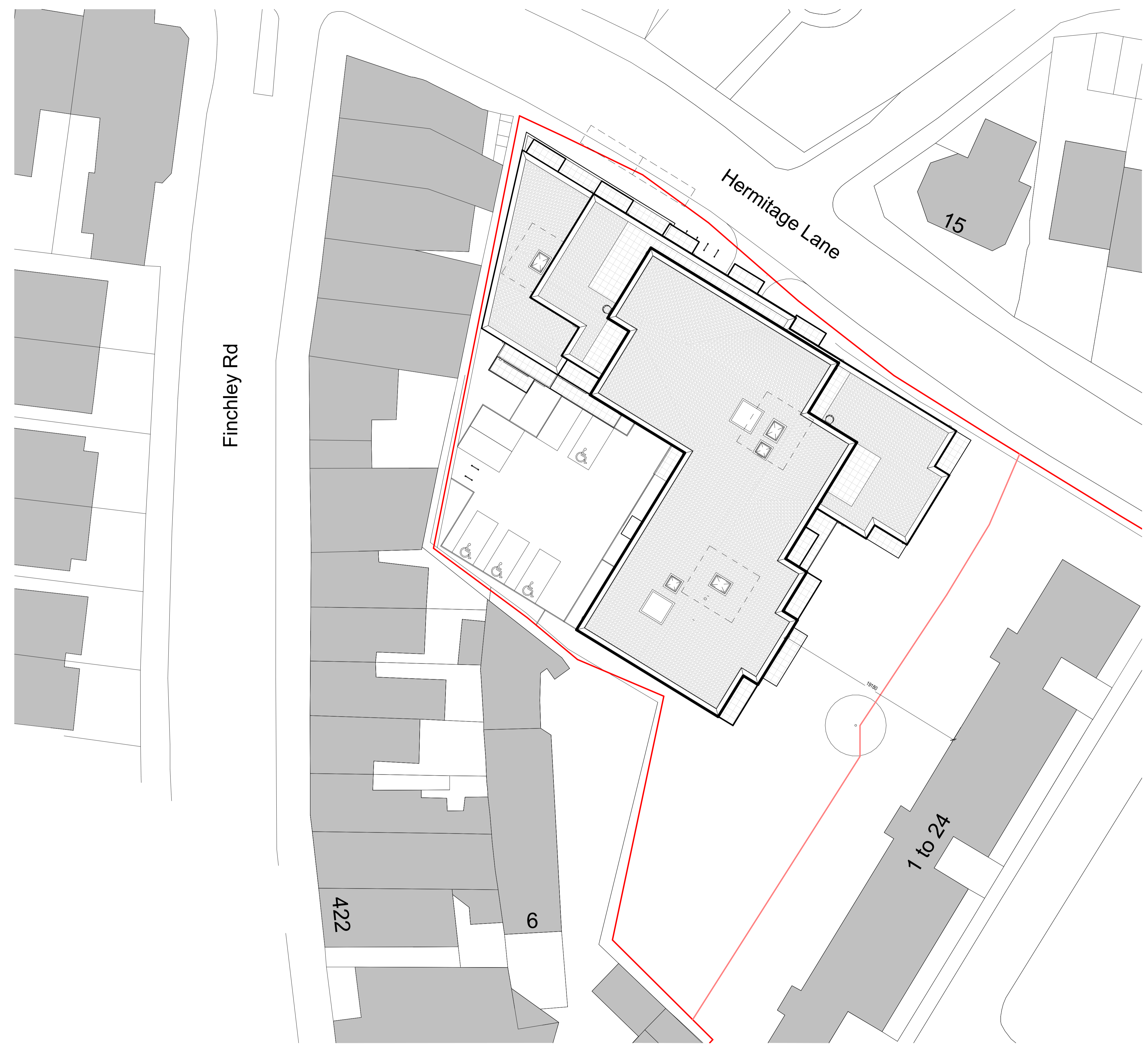
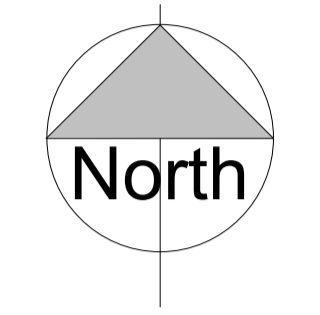

P1 Site Plan Issue 25.08.20 LS



www.ghmpartnership.co.uk  
 20 FINK HILL HORSFORTH LEEDS LS18 4DH  
 THE STUDIO 12 CHURCH STREET WELWYN HERTS AL6 9LX  
 PROJECT 2-10 Hermitage Lane  
 Barnet, London  
 DRAWING TITLE Site Plan

DATE	AUGUST 2020	DRAWN	LS
SCALE/BA1	As indicated	CHECK	RG
STATUS	PLANNING	SUITABILITY	n/a
JOB NO.	3257		
DRAWING NO.	3257-GHM-XX-XX-DR-A-(P0)101	REVISION	P1