

PHILOSOPHICAL APPROACH

THIS FAÇADE HAS SUFFERED FROM EXTENSIVE UNCONTROLLED COLLAPSE OVER THE YEARS AND THE STRUCTURAL INTEGRITY OF THE REMAINING ELEMENTS IS SIGNIFICANTLY COMPROMISED. ON THE BASIS THAT REPRESENTATIVE SAMPLES OF THE VARIOUS BUILDING ELEMENTS ARE PRESERVED ELSEWHERE IT IS PROPOSED THAT MISSING OR COLLAPSED SECTIONS ARE NOT REINSTATED AND UNSTABLE REMNANTS ARE REMOVED. THE EXISTING MASONRY WILL BE REDUCED IN HEIGHT TO A LOGICAL POINT WHERE IT IS MORE STRUCTURALLY VIABLE AND CAN BE WEATHERED EFFECTIVELY IN ORDER THAT DECAY AND FURTHER COLLAPSE CAN BE ARRESTED AND THE RUIN CONSOLIDATED. STONES TAKEN DOWN WILL BE LEFT ON SITE ADJACENT TO WHERE THEY CAME FROM. A PHOTOGRAPHIC RECORD IS TO BE MADE OF THE STRUCTURE AS IT CURRENTLY STANDS PRIOR TO DISMANTLING.

LABELLING LEGEND

- A: NO WORK REQUIRED
- B: STONE RE-DRESSED IN SITU - NBS CLAUSES C41X / 450 - 458
- C: STONE LOCALLY REPAIRED - NBS CLAUSES C41X / 510 - 692
- D: STONE REPLACED WITH NEW - NBS CLAUSES C41X / 310 - 420

STONEMWORK TO BE GENERALLY REPOINTED IN ACCORDANCE WITH THE SPECIFICATION NBS CLAUSES C41X / 810 - 860

LEGEND:

- GW17 GROUND FLOOR WINDOW 17
- GW18 GROUND FLOOR WINDOW 18
- BASE OF WALL EXPOSED, PATCH REPAIRED AND UNDERPINNED ONLY WHERE UNDERMINED BY IVY / ROOT BALLS (ON REAR FACE AS NECESSARY - IN 900MM SECTION LENGTHS. EXTENT TO BE AGREED ON SITE UPON INSPECTION).

EXISTING DRESSED STONE PIER HAS NOW COLLAPSED.

COLLAPSED PIER TO BE RECONSTRUCTED AS DRAWING AR(0)03-SEB3 AND AR(0)05-SEB3

SEB4 EXTERNAL WORKS:

- 01 GENERALLY REMOVE ALL REMNANTS OF VEGETATION.
- 02 AREA OBSCURED BY REMAINING VEGETATION AND SCAFFOLD PLANKS. ASSUME CATEGORY B REPAIR REQUIRED.
- 03 CARRY OUT CATEGORY B REPAIRS - LIGHTLY DRESS EXISTING STONES IN-SITU
- 04 CARRY OUT CATEGORY C REPAIRS - REPAIR DAMAGED OR HEAVILY ERODED STONES USING REINFORCED SSTONE REPAIR SYSTEM AS REQUIRED, SEE NBS.
- 05 CARRY OUT CATEGORY D REPAIRS - CUT OUT STONES CONSIDERED TO BE TOO BADLY DAMAGED OR ERODED FOR REPAIR AND REPLACE WITH NEW TO ORIGINAL PROFILE. REPLACE MISSING STONES WITH NEW TO MATCH ORIGINAL PROFILE.
- 06 NOT ON THIS DRAWING.
- 07 GENERALLY REPOINT ELEVATION WITH LIME MORTAR.
- 08 INSTALL NEW STONES TO FORM NEW WINDOW SURROUND TO MATCH ORIGINAL.
- 09 STONEMWORK BELOW CILL BUILT BACK UP OFF EXISTING FOOTING USING RECLAIMED STONE OR NEW TO MATCH THE EXISTING.
- 10 NEW CAPPING OF LEAD CLAD PAVING SLABS INSTALLED IN ACCORDANCE WITH DRAWING AR(0)08 SEB4.
- 11 EXISTING STONE AND BRICK INFILL REMOVED TO ALLOW CILLS TO BE INSTALLED. ENSURE MOISTURE PROTECTION TO WALL BELOW IS ACHIEVED.
- 12 HOLES IN STONE ASSUMED TO HAVE BEEN WHERE RAINWATER GOODS WERE FIXED FILLED
- 13 CAREFULLY REMOVE AND REINSTATE AFTER A LIGHT DRESSING ORIGINAL WINDOW SURROUND STONES. EMPLOY STAINLESS STEEL CRAMPS , DOWELS AND HELICAL FIXINGS TO SECURE STONES IN PLACE.
- 14 INSTALL LIME MORTAR BENCHING TO IMPROVE WATER RUN OFF

ALL STONES TO BE NUMBERED AND CATALOGUED PRIOR TO PIER BEING CAREFULLY TAKEN DOWN TO GROUND LEVEL. PIER TO BE RECONSTRUCTED TO DATUM AS DRAWING AR(0)05 SEB4 USING SALVAGED STONES DEEMED ACCEPTABLE FOR RE-USE (WITH RE-DRESSING) IN ORIGINAL UN-DISPLACED POSITIONS. STONES CONSIDERED TO BE TOO BADLY DAMAGED OR ERODED FOR REPAIR REPLACED WITH NEW TO ORIGINAL PROFILE.

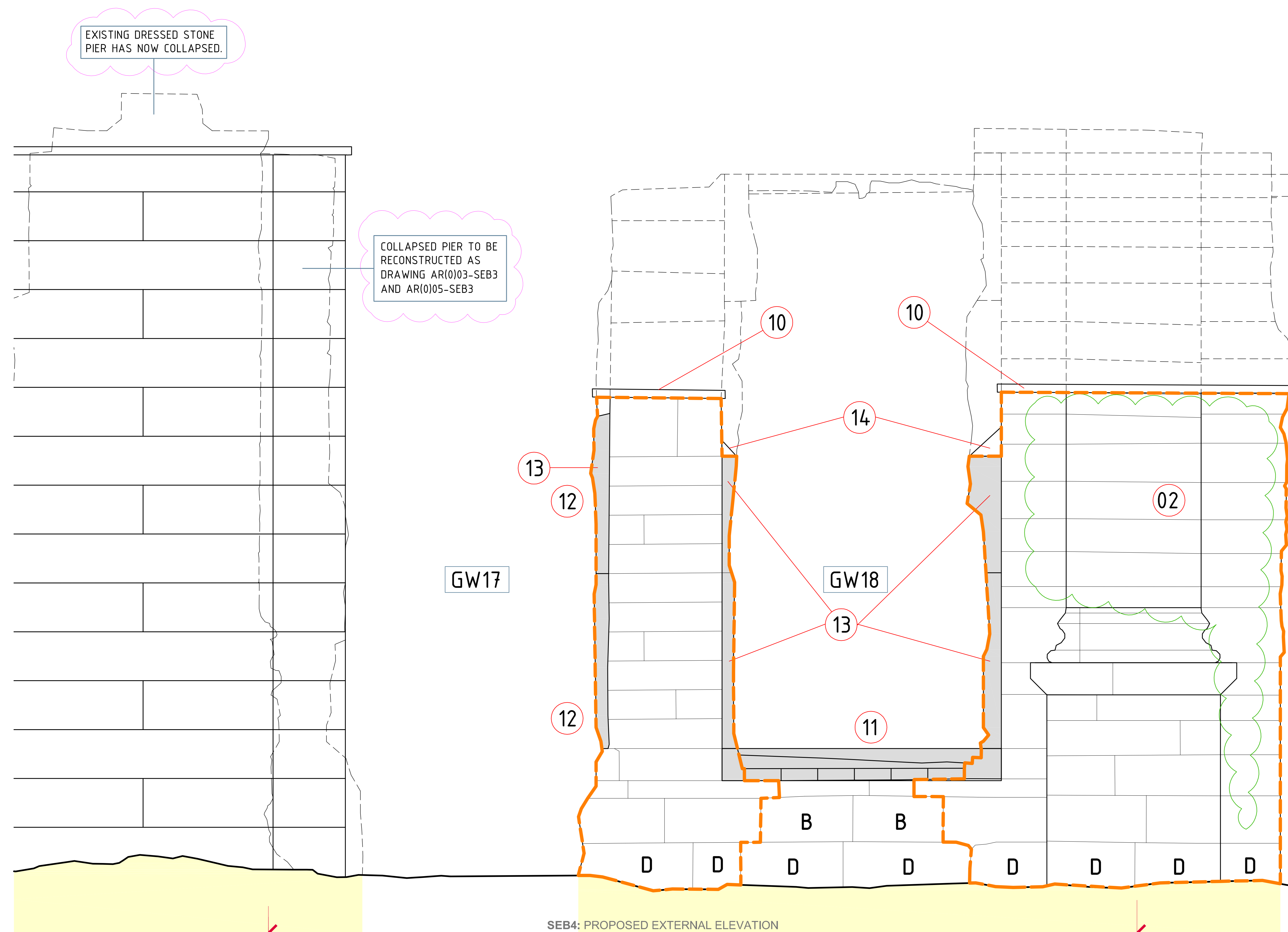

SEB4: PROPOSED EXTERNAL ELEVATION
SCALE 1:10 @ A0

Contractor to check all dimensions and report errors and omissions to the Architect / Contract Administrator
The Contractor is responsible for all setting out
Figure dimensions to take precedence over scale
Do not scale from this drawing
This drawing is copyright of Affinity Design and Management Limited and may not be loaned, copied or reproduced. It is not to be used for any other, quote, tender or construction purposes without written consent from Affinity Design and Management Limited.
Revision
No. DATE NOTE
A MAY 21 Works to free-standing piers updated