

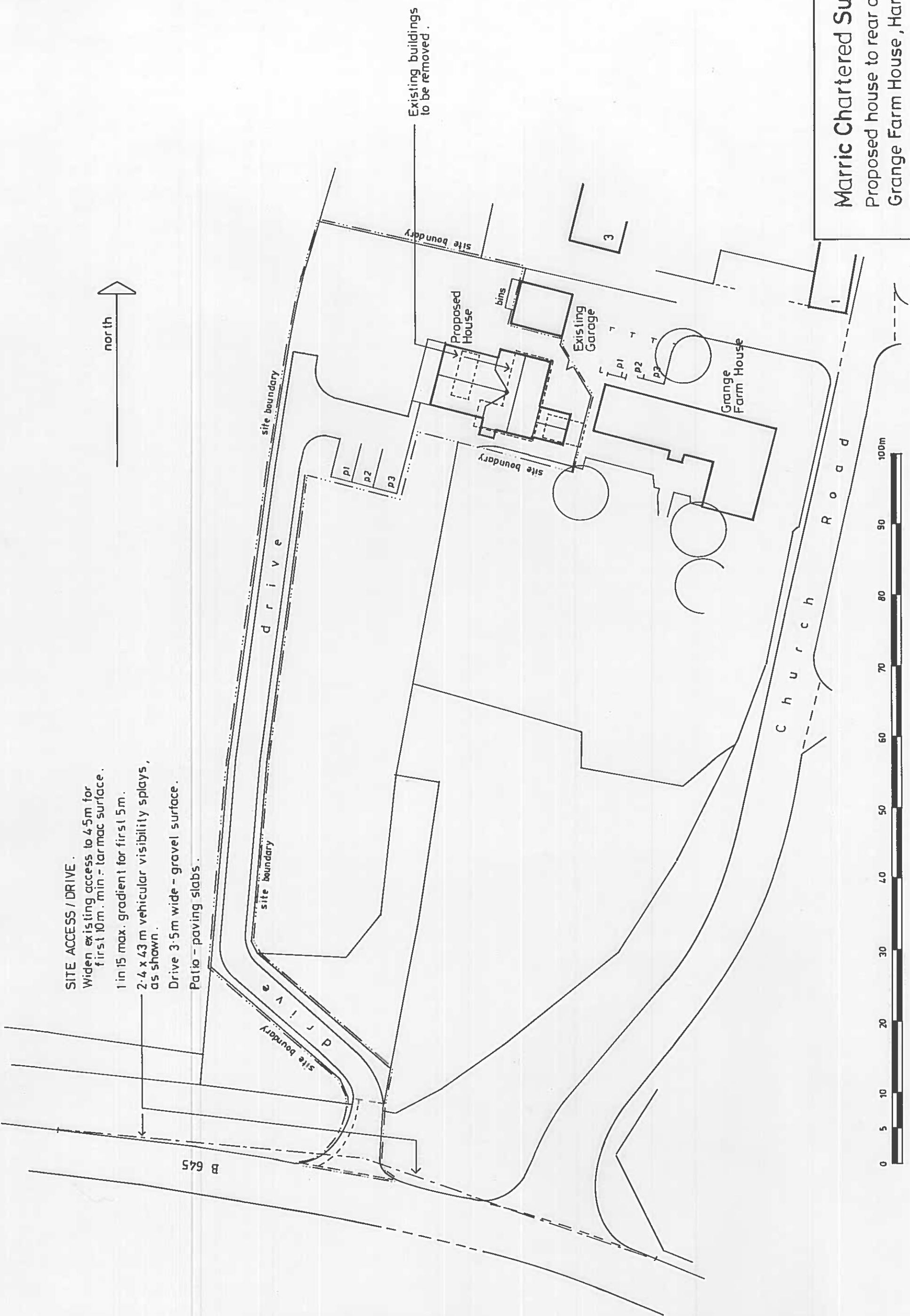

SITE ACCESS / DRIVE .
Widen existing access to 4.5m for first 10m. min - tar mac surface.
1 in 15 max. gradient for first 5m.
2.4 x 4.3 m vehicular visibility splays, as shown.
Drive 3.5m wide - gravel surface.
Patio - paving slabs.



Marric Chartered Surveyors
Proposed house to rear of
Grange Farm House, Hargrave.
Site Plan.
Job No: 20/43 . Drg. No: 8 .
May 2021 .

Site Plan 1:500 at A3 .