

General notes
 1. New floor finishes throughout to replace existing modern flooring. Assume porcelain tiling to wet rooms (Bathroom) and engineered timber flooring elsewhere.
 2. Original skirting, cornicing and skirting to be retained where existing with profiles in-keeping with building's heritage installed elsewhere.
 3. New lighting throughout
 4. Underfloor heating proposed throughout; with existing radiators removed as per original planform.

Existing window to be blocked-up internally. Opaque film applied to glass internally, opening blocked-up with plasterboard & skimmed-over. Can be reversed in future if necessary.

New underfloor heating installed beneath both Dining-Room and Kitchen. Non-original floor build-up to be dug-up and replaced at existing Kitchen FFL, with UFH laid into top screed level. UFH loops not located at perimeter to prevent undermining existing foundation. See SE drawings for further details.

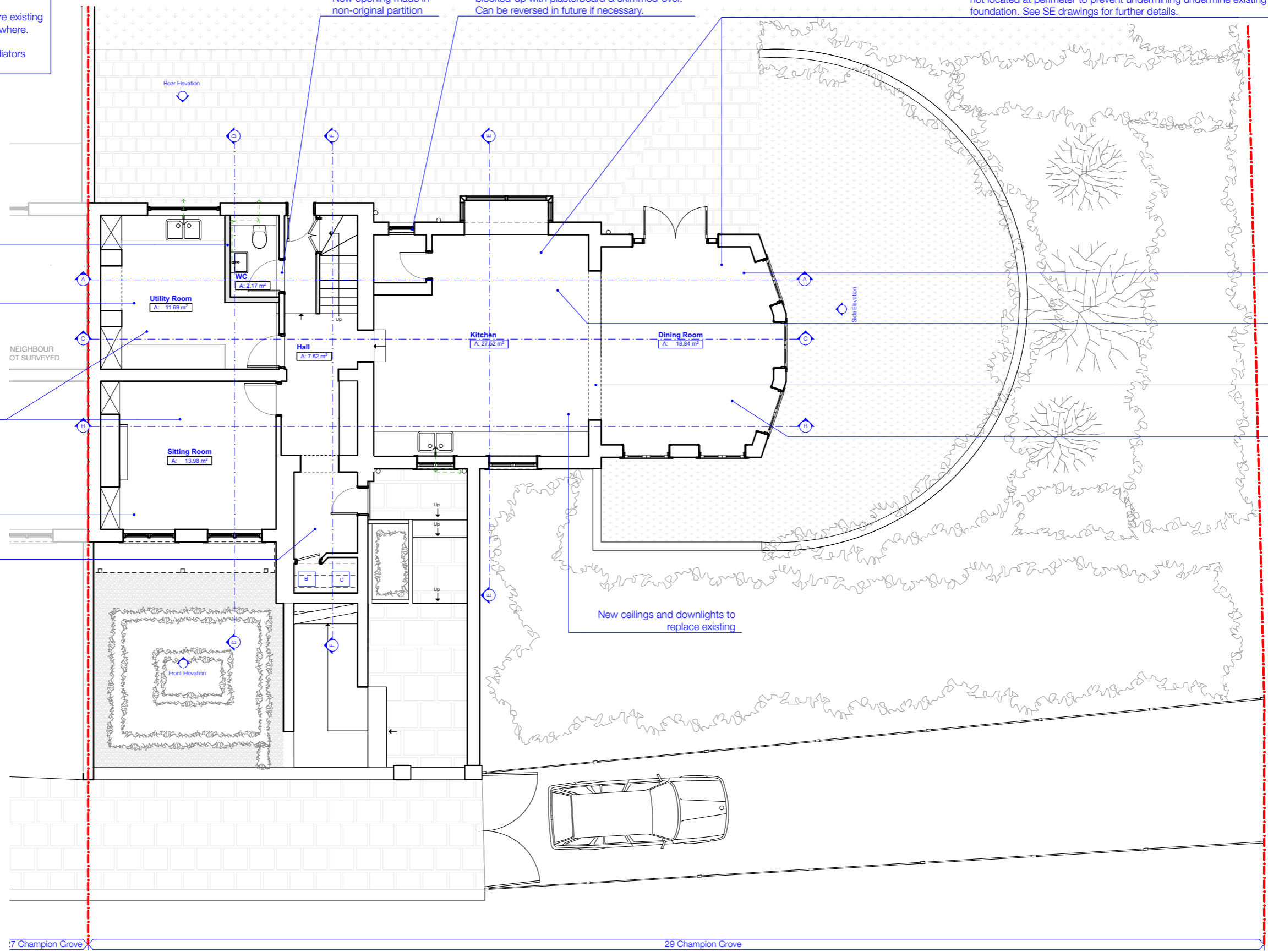

New lightweight, timber stud partition to enclose larger WC

New ceilings and downlights to replace existing

New underfloor heating installed beneath Sitting-Room and Utility Room. Existing concrete slab to be dug-up and replaced at same level, with UFH laid into top screed level. UFH loops not located at perimeter: no works to party-wall or that would undermine existing foundation.

New ceilings and downlights to replace existing

Non-original partition removed and existing sanitary-ware removed; restoring hallway to original layout

Modern floorslab lowered to Dining-Room to allow level access from Kitchen.

New beam to replace existing; (within joist line) to support floor joists over

Existing chimney-breast removed and existing opening enlarged. New steel beam installed over; see SE drawings for details.

Suspended ceilings removed, new lining to pitched ceiling & new lighting

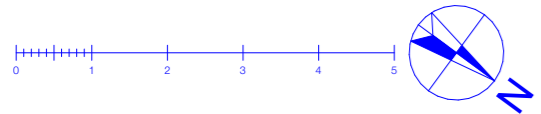

REV	DATE	DRAWN	AMENDMENT



Studios 18-19, 16 Porteus Place, Clapham, London SW4 0AS
 t +44 (0) 20 7924 4555
 e info@granit.co.uk
 w www.granit.co.uk

Project **29 Champion Grove**
 For **Damian Thornton**
 Project Address **29 Champion Grove, Camberwell, London SE5 8BN, United Kingdom**

Drawing No. **2020/P/100**
 Drawing **Proposed Lower Ground Plan**
 Purpose **FOR PLANNING**

© GRANIT CHARTERED ARCHITECTS LTD

THIS DRAWING HAS BEEN PRODUCED FOR THE NAMED CLIENT AND NAMED PROJECT AND IS NOT INTENDED FOR USE BY ANY OTHER PERSON OR FOR ANY OTHER PURPOSE.

Scale 1:100 @ A3 Date 25/05/2021 Drawn WM
 Notes IF THIS DRAWING HAS BEEN ISSUED 'FOR CONSTRUCTION' DO NOT SCALE DIRECTLY FROM IT. ALL DIMENSIONS TO BE CHECKED ON-SITE, PLEASE CONTACT ARCHITECT IF YOU REQUIRE CONFIRMATION OF ANY DIMENSIONS. ANY DISCREPANCIES TO BE RAISED WITH CONTRACT ADMINISTRATOR.

File CURRENT_CHAMPION_GROVE_LB_May.pln