

EXISTING LAYOUT of
GROUND FLOOR FLAT No. 75

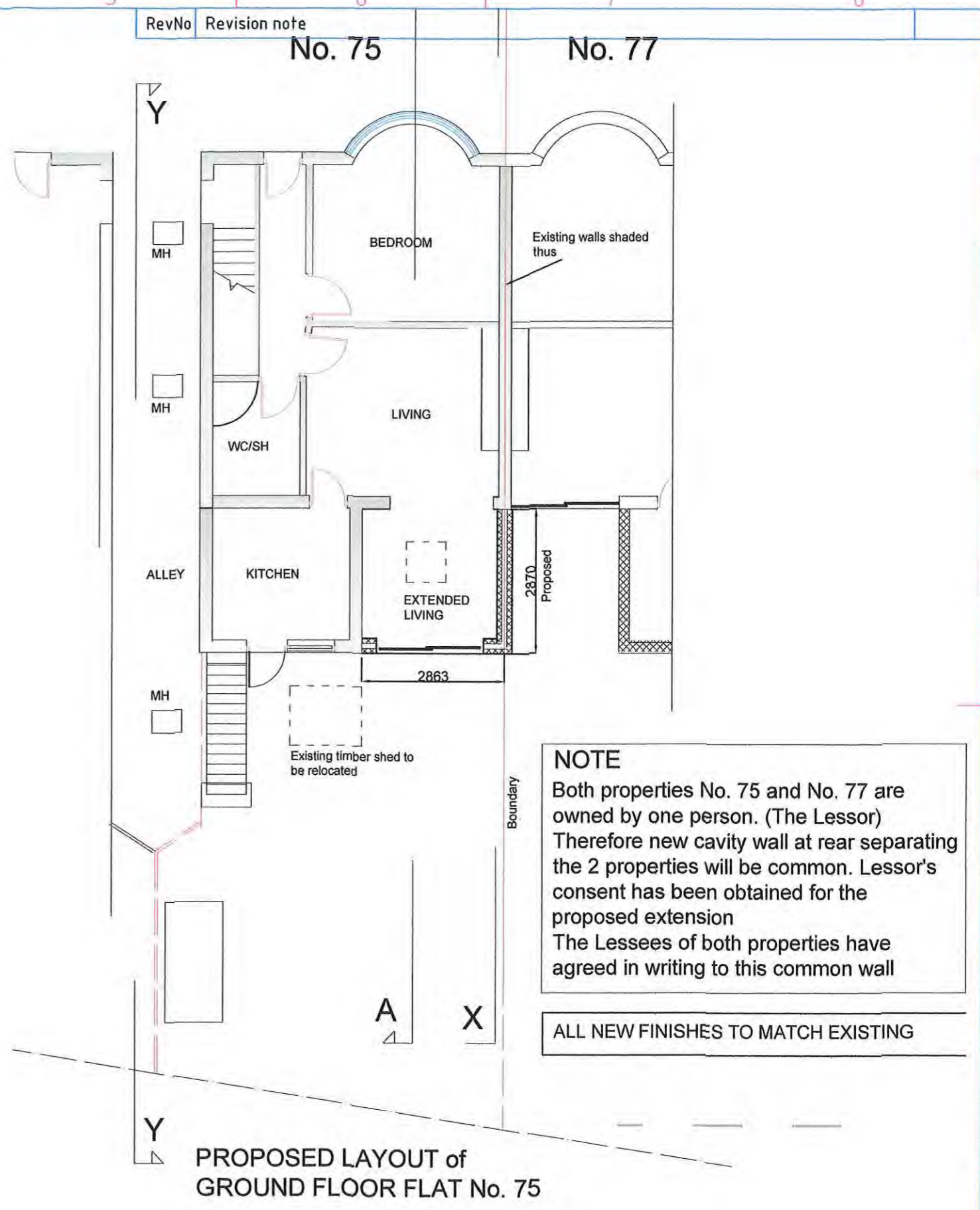

PROPOSED LAYOUT of
GROUND FLOOR FLAT No. 75

NOTE
Both properties No. 75 and No. 77 are owned by one person. (The Lessor) Therefore new cavity wall at rear separating the 2 properties will be common. Lessor's consent has been obtained for the proposed extension
The Lessees of both properties have agreed in writing to this common wall

ALL NEW FINISHES TO MATCH EXISTING

			Date 05.05.2021	Scale 1:100
PROPOSED EXTENSIONS TO No. 75, SOUTHVIEW AVENUE NEASDEN NW10 1RJ		EXISTING AND PROPOSED GROUND FLOOR PLANS		
		DRAWING No. 75/100		