

Notes:  
 As existing drawings based on survey drawings undertaken by Survey and Site Services LLP (October 2013)

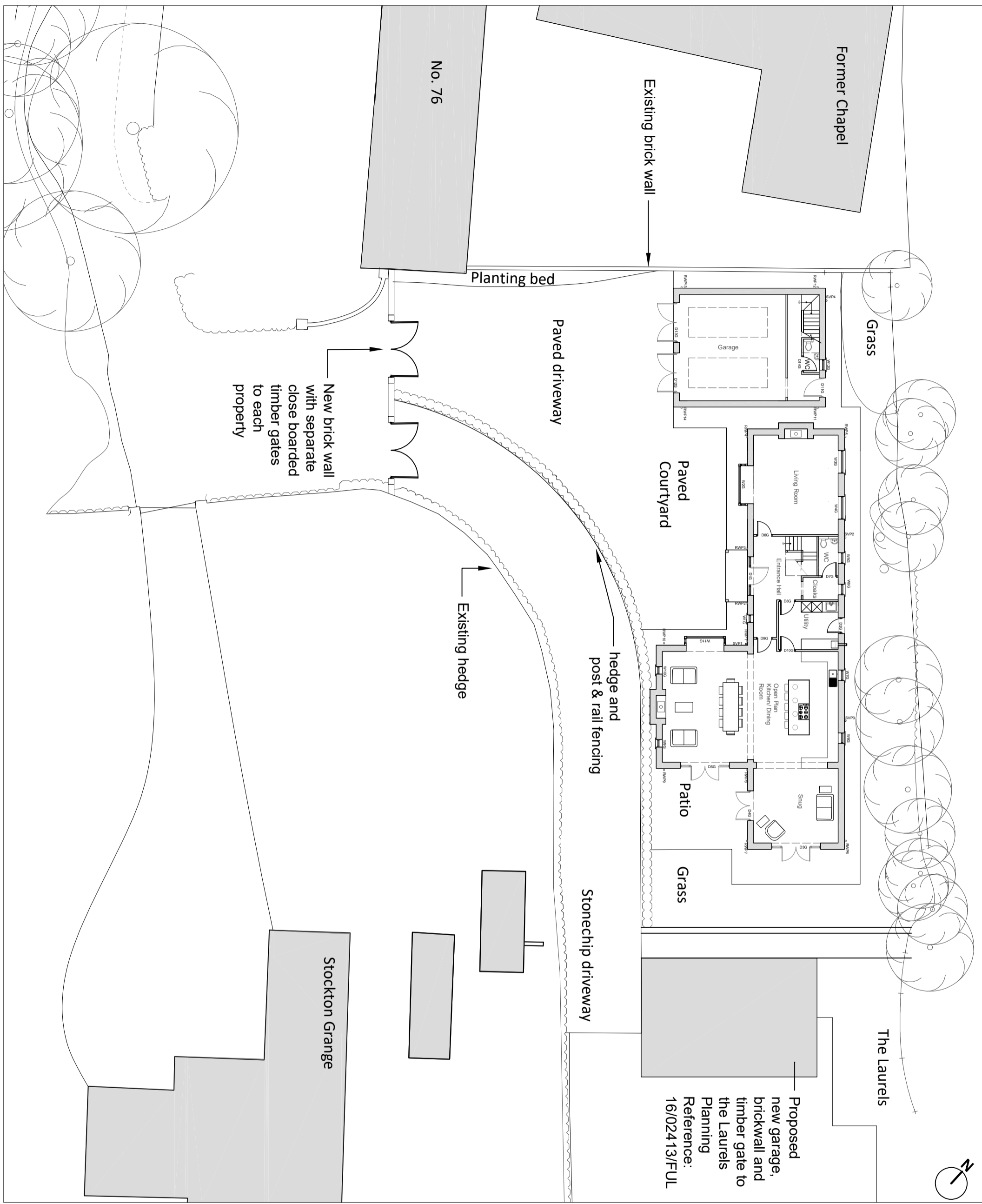

Scale 1:200@A3 0 10 20m

© Crown Copyright and database rights 2018 OS 100047474

**ISSUED FOR:**  
**Planning Permission**

Drawing Revision	Date	Description
B	05.03.2018	Entrance driveway & Garage position updated.
A	02.03.2018	Entrance driveway updated. Garage layout updated.

**Client:**  
 Mr Nigel Adams

**Project:**  
 New Dwelling, Laurel House, Stockton on the Forest

**Drawing Title:**  
 Site plan - As Proposed

**Scale:**  
 1:200@A3 16/02/18

**Project Number:** 025T1SF  
**Drawing Number:** 201  
**Drawing Revision:** B

Do not scale from drawings. Check all dimensions on site  
 © All rights reserved

**CHARLOTTE KITCHEN ARCHITECTS LTD.**

82 Greenshaw Drive, Haxby, York, YO32 3DG  
 T: 07815 094360 E:charlie@charlottekitchenarchitects.co.uk  
 www.charlottekitchenarchitects.co.uk  
 Charlotte Kitchen Architects Limited is a registered company in England and Wales. Registered address: 82 Greenshaw Drive, Haxby, York, YO32 3DG. Company Number: 10252349