

PROPOSED EAST ELEVATION - 1:100 @ A3



PROPOSED EAST CONTEXT - 1:250 @ A3

Notes:

1. Do not scale from this drawing other than for planning purposes.
2. All dimensions to be verified prior to the commencement of any work or the production of any shop drawings.
3. Matthew Lloyd Architects (MLA) shall be notified in writing of any discrepancies.
4. Survey and boundaries indicative only.
5. Proposals are subject to utilities surveys and specialist consultants' input & coordination.
6. Any areas indicated are approximate and indicative only.
7. Where an item is covered by drawings in different scales the larger scale drawing is to be worked to.
8. Drawing to be read in conjunction with relevant consultant's drawings and specifications.
9. Where MLA services on a project do not include for site inspections and work surveys, MLA do not warrant that 'as built' issue drawings are a complete and accurate record of what has been built.

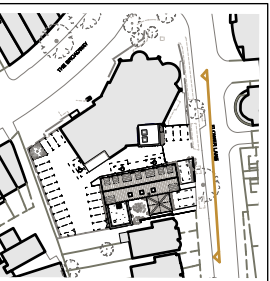

KEY

- A - DARK BUFF BRICK, STRETCHER BOND WITH RAKED JOINTS
  - B - LIGHT BUFF BRICK, STRETCHER BOND WITH FLUSH JOINTS
  - C - VERTICAL STRETCHER BOND BRICK PLINTH
  - D - RECESSED SOLDIER BOND BRICK DETAIL
  - E - PRE-CAST CONCRETE / RECONSTITUTED STONE BAND
  - F - PRE-CAST CONCRETE / RECONSTITUTED STONE WINDOW SURROUND
  - G - PPC ALUMINIUM COMPOSITE WINDOW
  - H - MATT LACQUERED SOLID TIMBER DOOR WITH GREEN GLAZED BRICK SURROUND
  - J - STANDING SEAM METAL ROOF
  - K - METAL DOWNPIPE AND HOPPER
  - L - CONCEALED GUTTER WITH INTERNAL DOWNPIPE
  - M - STOCK BRICK TO MATCH EXISTING CHURCH
  - N - PPC ALUMINIUM WINDOW TO MATCH EXISTING CHURCH
- OUTLINE OF EXISTING BUILDING

Revisions:

PLANNING



**MatthewLloydArchitects** LLP  
 1b The Hangar  
 Perseverance Works  
 38 Kingsland Road  
 London E2 8DD  
 T 020 7613 1934  
 email: mail@matthewlloyd.co.uk  
 www.matthewlloyd.co.uk ©2018

Original Sheet Size **A3**

Date:	Scale:	Drawn by:
Apr-21	1:100/1:250 @ A3	ASp
Project:		
VINCENTIAN PRESBYTERY MILL HILL		
Drawing title:		
PROPOSED EAST ELEVATION		
Reference:	Dep. No.	Rev.
VP	241	P01