

© This drawing and the works shown are the copyright of Central Design Consultants Ltd. and may not be reproduced except by written permission.

**General Notes:**

Except for local planning authority use this drawing should not be scaled. If in any doubt - ask !!

This drawing is to be read in conjunction with any other Central Design Consultants Ltd drawings

All details and dimensions are to be confirmed on site by contractor, prior to works commencing or any ordering of materials. Should any discrepancy be noted between design details/drawings and with dimensions or details on site, Central Design Consultants should be notified and guidance obtained prior to proceeding with any works

This drawing is only to be used 'for construction' if specifically noted as such

The contractor is responsible for maintaining the structural stability of the structures, ground and excavation at all times and the design, detail & installation of all necessary temporary works

**KEY:**

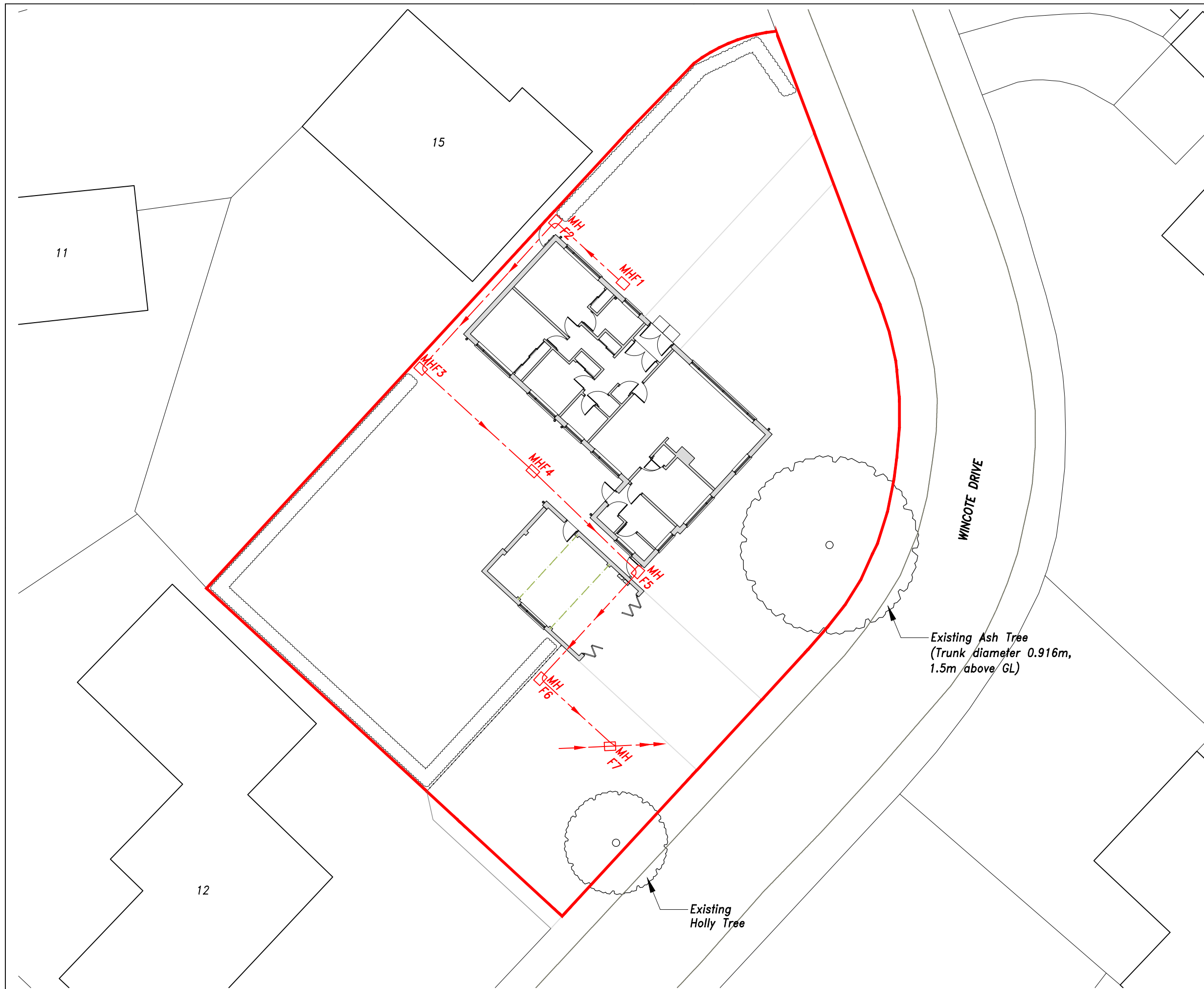

 = Indicates site boundary



Existing Ash Tree  
(Trunk diameter 0.916m,  
1.5m above GL)

Existing Holly Tree

**Central Design Consultants Ltd.**  
Civil Structural Building

 The Old Chapel, Bilston Street, Sedgley, West Midlands, DY5 1JB   
Tel: 01802 68244 www.centraldesignconsultants.co.uk

Client **Mr & Mrs C. Gammon**

Job Title **14 Wincote Drive,  
Tettenhall  
WV6 8LR**

Drg. Title **Site Plan as Existing**

Scale **1:200 @ A3**

Drg. No. **1002-252-01**

Date **January 2021**

Drawn **PK**

© Crown Copyright and database rights 2021 OS  
100035409

